

DEPARTMENT OF THE INTERIOR
U. S. GEOLOGICAL SURVEY.

28-N-IV-W/2-W/2
TOPOGRAPHY

CALIFORNIA
(SISKIYOU COUNTY)
SHASTA VALLEY
SHEET No. 6

Advance sheet.
Subject to correction.



*Part of Macdoel
quad
Little Shasta Valley of
very doubtful propriety
here*

C. H. Birdseye, Chief Topographic Engineer
Geo. R. Davis, Division Topographic Engineer
Topography by C.A. Stonesifer and Thos.H. Moncure.
Control by C.F. Urquhart and C.W. Hessler.

Stonesifer
Moncure

SURVEYED IN 1921 IN COOPERATION WITH THE U. S. RECLAMATION SERVICE,
STATE OF CALIFORNIA AND KLAMATH-SHASTA VALLEY IRRIGATION DISTRICT

Scale 24000

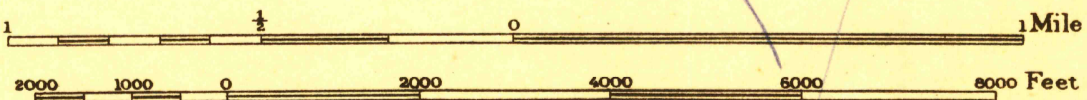

Contour interval 5 feet
Datum is mean sea level

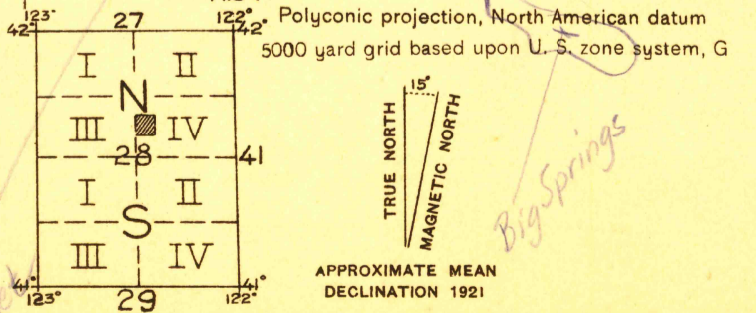

SHASTA VALLEY SHEET NO. 6

USGS
Historical File
Topographic Division

(Shasta Valley No. 1)

*ditto from
Big Springs
Big Springs quad*