

(Russell Valley)

DEPARTMENT OF THE INTERIOR
U. S. GEOLOGICAL SURVEY

92-S-111
LOS ANGELES COUNTY, CALIFORNIA
BOARD OF SUPERVISORS
SIDNEY T. GRAVES, CHAIRMAN
J. E. ROCKHOLD, COUNTY SURVEYOR
(Vejar)

Advance sheet
Subject to correction

CALIFORNIA
(LOS ANGELES COUNTY)

SOLSTICE CANYON QUADRANGLE

(Dry Canyon)

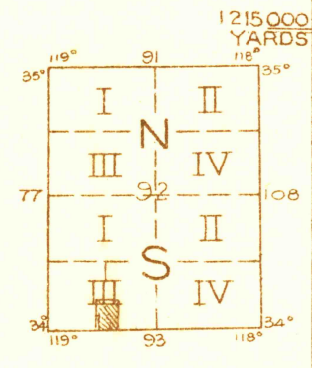

T. G. Gerdine, Division Engineer
Topography by C. P. McKinley
Control by U. S. Geological Survey and
U. S. Coast and Geodetic Survey
Surveyed in 1929

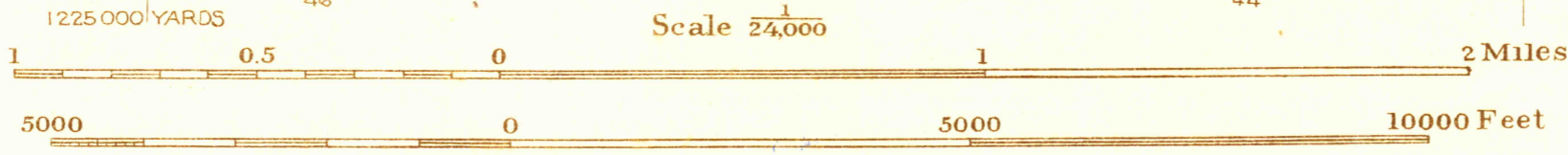
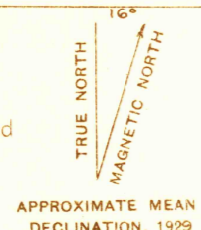

Contour interval 5 and 25 feet. (See diagram)
Datum is mean sea level

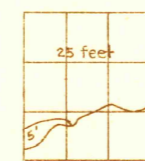

Polyconic projection. North American datum
5000 yard grid based upon U. S. zone system, G

SOLSTICE CANYON, CALIF.