

U.S.G.S.
FILE COPY
Illustration and Printing

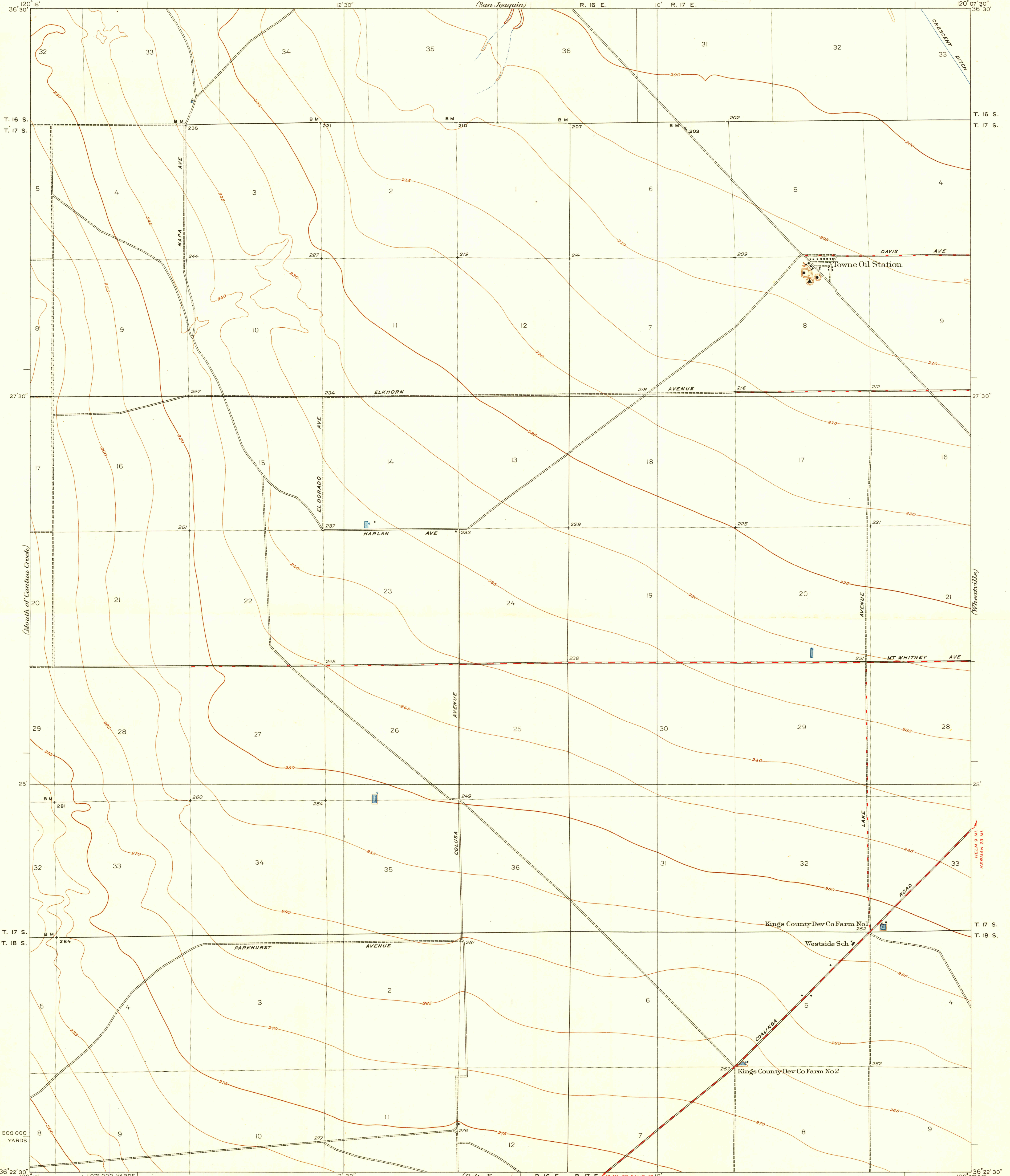

Topography by L.O. Newsome
Control by U.S. Geological Survey and Corps of Engineers, U.S. Army
Surveyed in 1928

ROAD CLASSIFICATION
HARD-SURFACE ALL WEATHER ROADS DRY WEATHER ROADS
Heavy-duty 4 LANE 1/2 LANE Improved dirt
Medium-duty 4 LANE 1/2 LANE Unimproved dirt
Loose-surface, graded, or narrow hard-surface
U. S. Route State Route

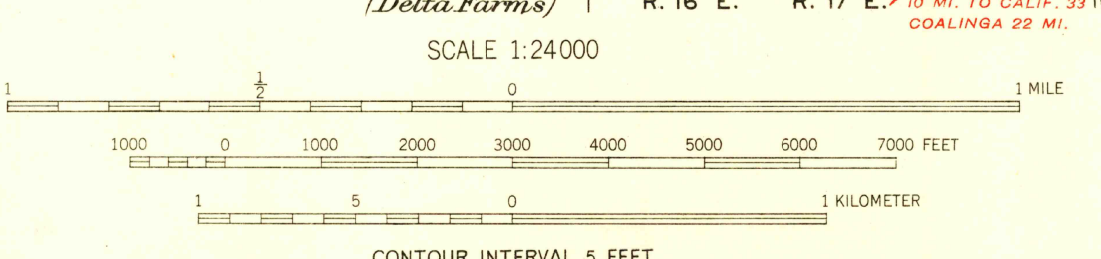
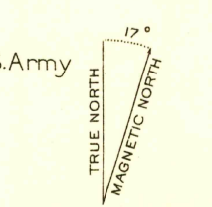

FOR SALE BY U. S. GEOLOGICAL SURVEY, FEDERAL CENTER, DENVER, COLORADO, OR WASHINGTON 25, D. C.
A FOLDER DESCRIBING TOPOGRAPHIC MAPS AND SYMBOLS IS AVAILABLE ON REQUEST

USGS
Historical File
Topographic Division

Polyconic projection. North American datum
5000 yard grid based upon U.S. zone system, G

U.S.G.S.
FILE COPY
Illustration and Printing

TOWNE OIL STATION, CALIF.
Edition of 1950
First published in 1931
at scale of 1:31680
N36225-W120075/75

NAME CHANGED TO WESTSIDE
AUG 25 1950

(San Joaquin)

(Hahn)

(Joaquin Rocks)

(West of Lebec)