

UNITED STATES
DEPARTMENT OF THE INTERIOR
GEOLOGICAL SURVEY

VIDAL JUNCTION QUADRANGLE
CALIFORNIA—SAN BERNARDINO CO.
7.5 MINUTE SERIES (TOPOGRAPHIC)
NE/4 VIDAL 15' QUADRANGLE

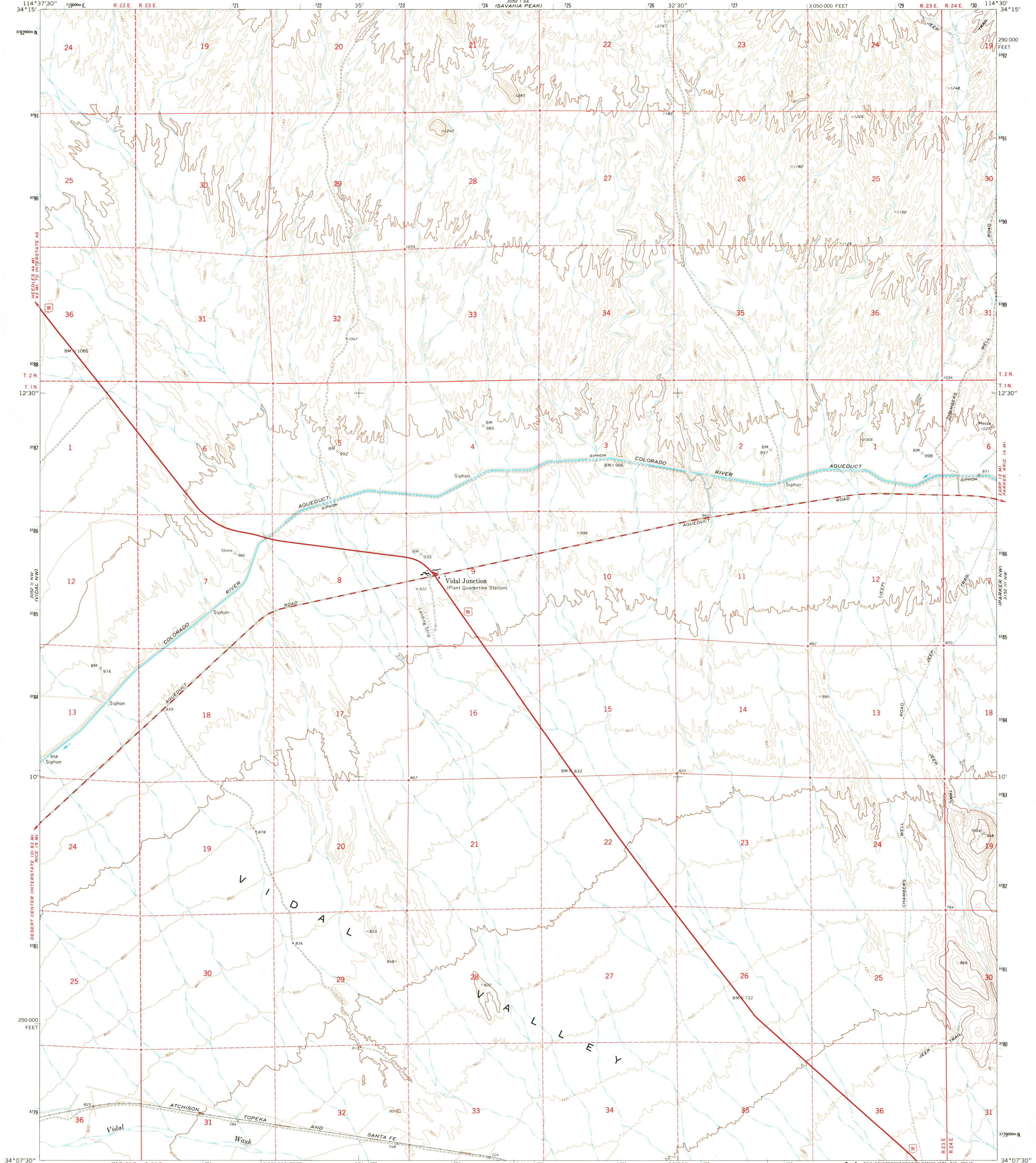

Mapped, edited, and published by the Geological Survey
Control by USGS and USC&GS
Topography by photogrammetric methods from aerial
photographs taken 1970. Field checked 1971
Projection and 10,000-foot grid ticks: California coordinate
system, zone 5 (Lambert conformal conic)
1000-meter Universal Transverse Mercator grid ticks,
zone 11, shown in blue. 1927 North American datum

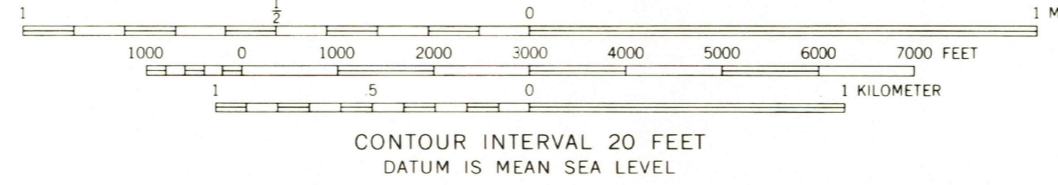
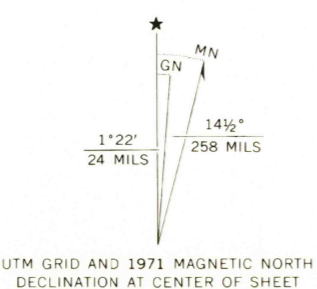

CONTOUR INTERVAL 20 FEET
DATUM IS MEAN SEA LEVEL



ROAD CLASSIFICATION
 Primary highway, hard surface — Light-duty road, hard or improved surface
 Secondary highway, hard surface — Unimproved road
 Interstate Route — U. S. Route — State Route

18 AUG 1973
VIDAL JUNCTION, CALIF.
NE/4 VIDAL 15' QUADRANGLE
N3407.5—W11430.7-5

1971
AMS 3052 II NE—SERIES V895

THIS MAP COMPLIES WITH NATIONAL MAP ACCURACY STANDARDS
FOR SALE BY U. S. GEOLOGICAL SURVEY, DENVER, COLORADO 80225, OR WASHINGTON, D. C. 20242
A FOLDER DESCRIBING TOPOGRAPHIC MAPS AND SYMBOLS IS AVAILABLE ON REQUEST

Handwritten notes:
Hoon
3000
50 plan