

(West Alpaugh)

DEPARTMENT OF THE INTERIOR  
U.S. GEOLOGICAL SURVEY

STATE OF CALIFORNIA  
FRIEND W. RICHARDSON, GOVERNOR  
PAUL BAILEY STATE ENGINEER  
(Alpaugh) R. 23 E. R. 24 E.

CALIFORNIA  
ALLENSWORTH QUADRANGLE

(East)

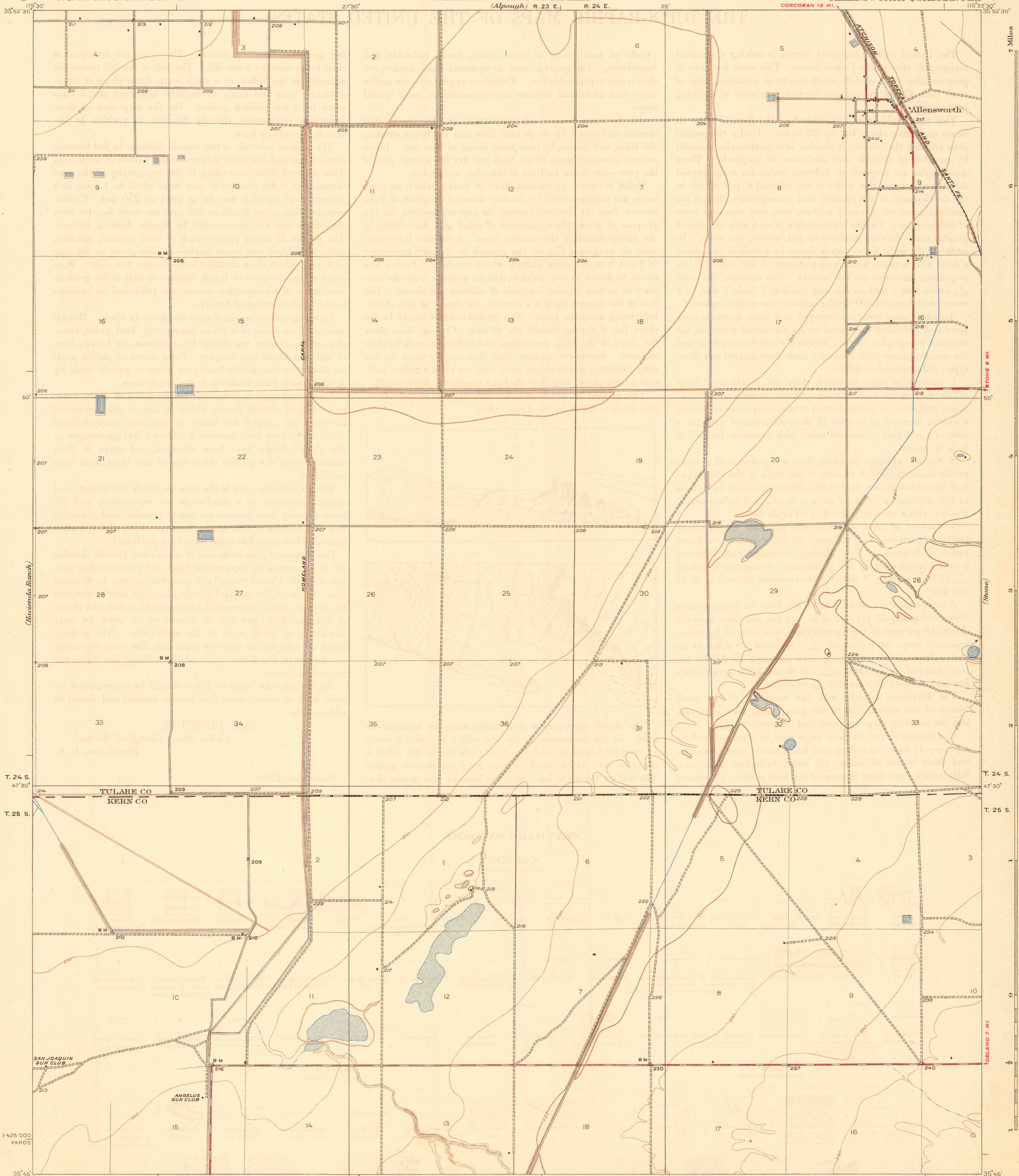

Topography by Bishop Moorhead  
Control by U.S. Geological Survey  
Surveyed in 1926

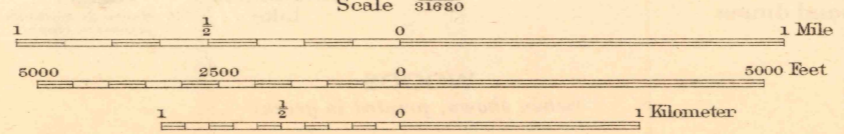
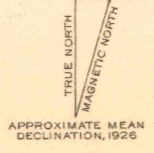

Contour interval 5 feet  
Datum is mean sea level

Polyconic projection, North American datum  
5000 yard grid based upon U.S. zone system, G

HARD IMPERVIOUSLY SURFACED ROADS  
OTHER MAIN TRAVELED ROADS

ALLENSWORTH, CALIF.  
Edition of 1929