

U. S. G. S.
FILE COPY
Inspection and Editing.

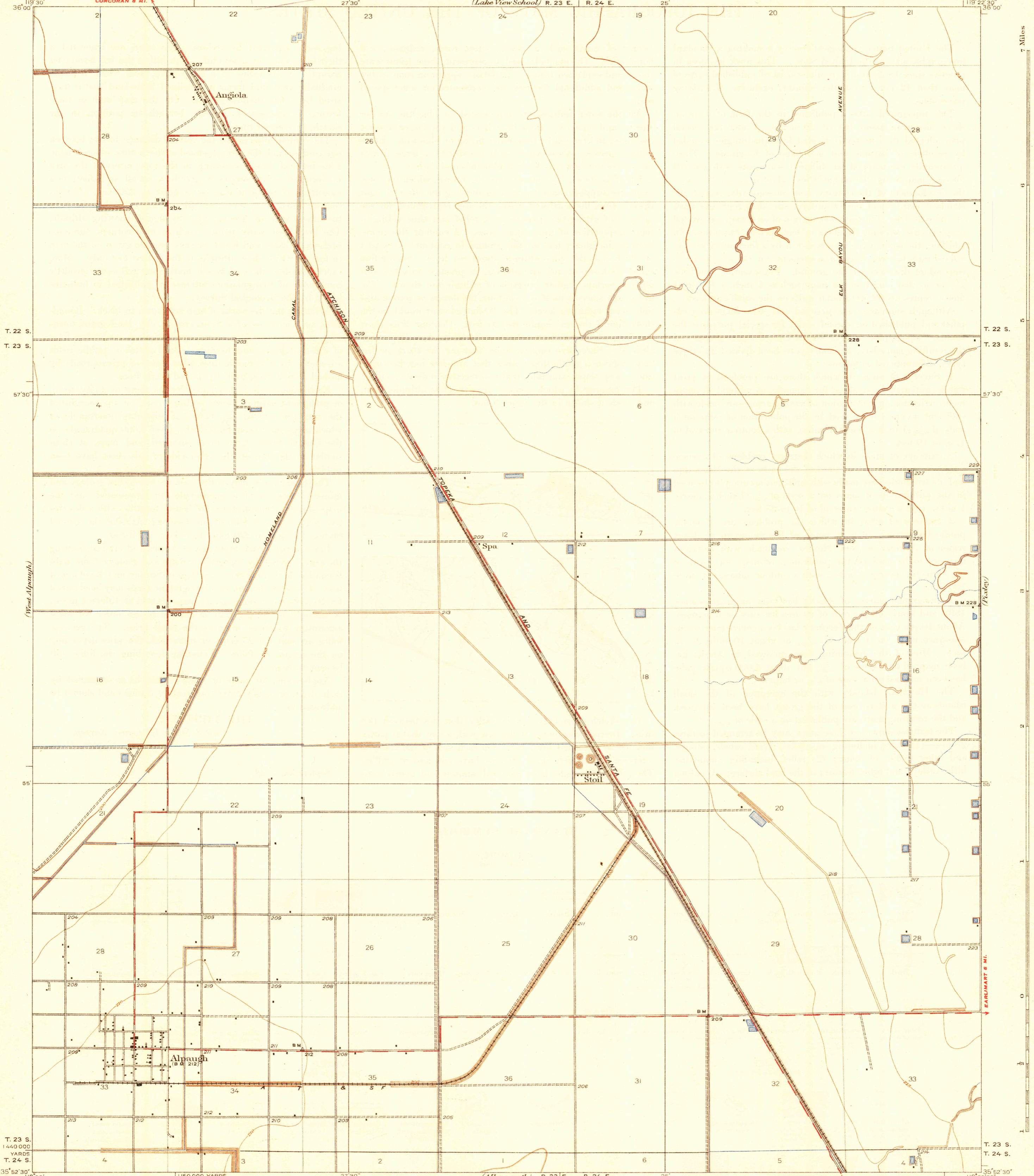

Topography by Bishop Moorhead
Control by U.S. Geological Survey
Surveyed in 1926

TRUE NORTH
MAGNETIC NORTH
APPROXIMATE MEAN
DECLINATION, 1928

Scale 1:6250
1 Mile
5000 2500 0 5000 Feet
1 Kilometer

Contour interval 5 feet
Datum is mean sea level

USGS
Historical File
Topographic Division

Polyconic projection, North American datum
5000 yard grid based upon U.S. zone system, G

HARD IMPREVIOUSLY SURFACED ROADS
OTHER MAIN TRAVELED ROADS

JUNE, 1929

ALPAUGH, CALIF.
Edition of 1929

JUL 30 1929 (2405)

1652-1705/29