

U. S. G. S.  
**FILE COPY**  
Inspection and Editing.

STATE OF CALIFORNIA  
REPRESENTED BY THE  
DIRECTOR OF PUBLIC WORKS  
(West Camp)

CALIFORNIA  
(KERN COUNTY)  
ANTELOPE PLAIN QUADRANGLE  
R. 20 E. R. 21 E.

UNITED STATES  
DEPARTMENT OF THE INTERIOR  
GEOLOGICAL SURVEY  
R. 19 E. R. 20 E.

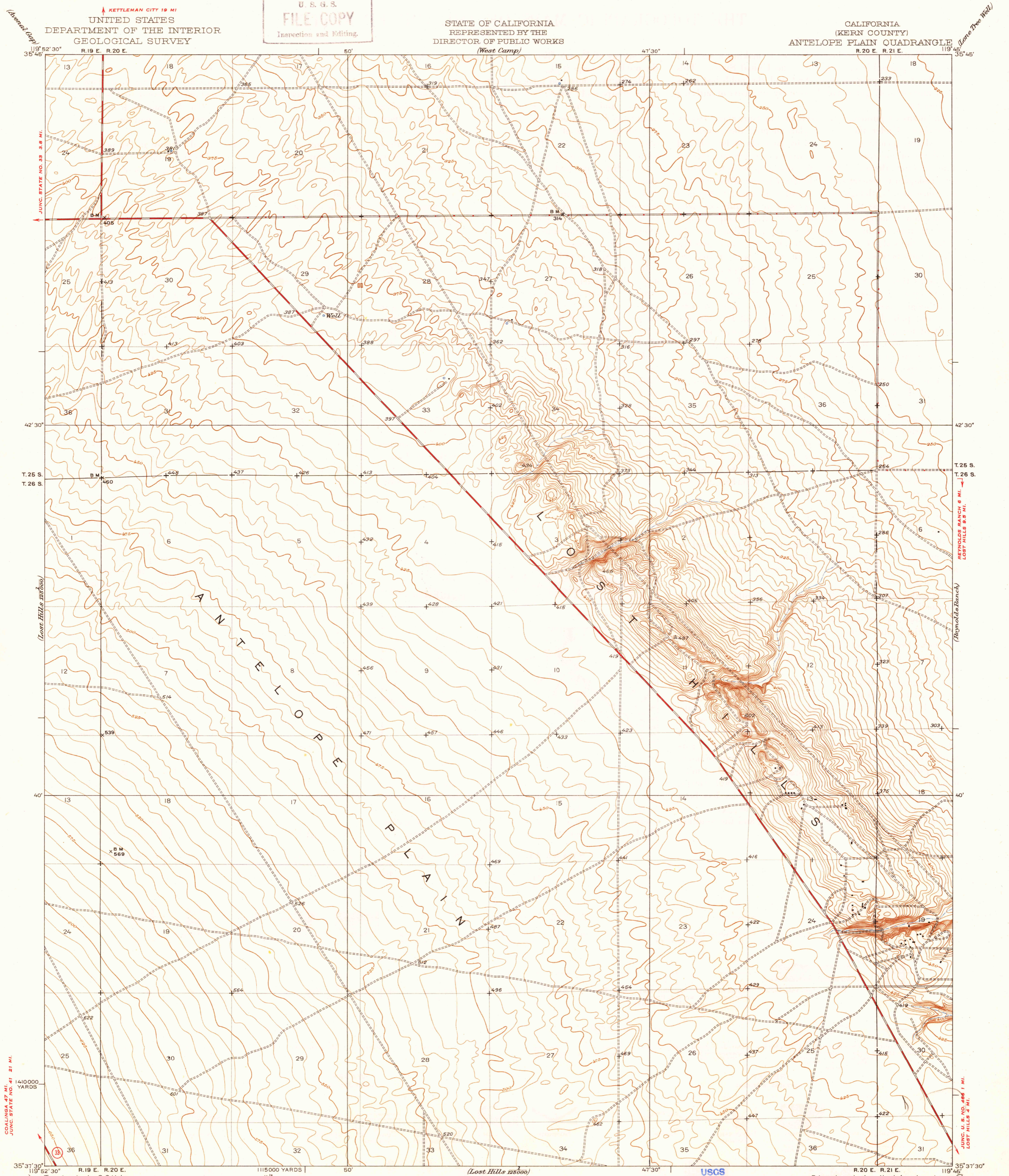

Topography by S.C. Kain  
Surveyed in 1932  
BLACKWELLS CORNER (JUNC. U. S. NO. 465) 0.8 MI.

APPROXIMATE MEAN  
DECLINATION, 1932

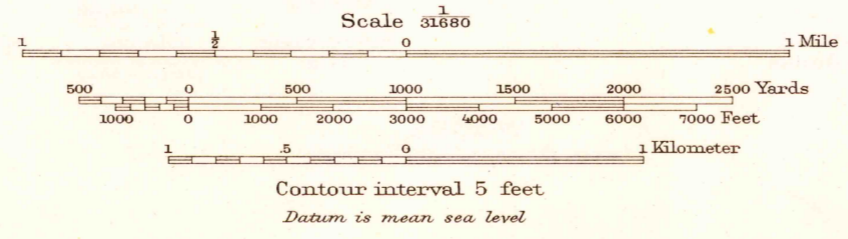

USGS  
Historical File  
Topographic Division

Polyconic projection. North American datum  
5000 yard grid based upon U. S. zone system, G

U. S. G. S.  
**FILE COPY**  
Inspection and Editing.

ANTELOPE PLAIN, CALIF.  
Edition of 1936  
reprinted 1947  
N35325-W11945/7.5

AUG 4 1947