



120°00' 35°52'30"

119°52'30" 35°52'30"

120°00' R. 18 E.

119°52'30" R. 19 E.

35°45' T. 24 S.

35°45' T. 25 S.

1425 000 YARDS

Topography by M.J. Harden and J.L. Buckmaster  
Control by U.S. Geological Survey  
Surveyed in 1930

LOST HILLS 20 MI.  
BAKERSFIELD 70 MI.

(Lost Hills 25000)

Scale 31880

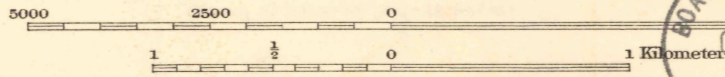

Contour interval 5 and 25 feet. (see diagram)

Datum is mean sea level

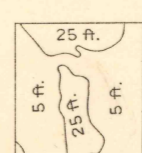
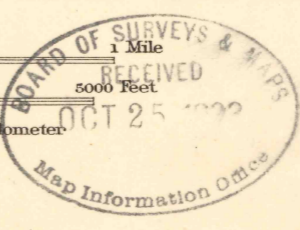

Polyconic projection. North American datum  
5000 yard grid based upon U.S. zone system, G

HARD IMPERVIOUSLY SURFACED ROADS  
OTHER MAIN TRAVELED ROADS  
1933

USGS LIBRARY - RESTON

AVENAL GAP, CALIF.  
Edition of 1933

3 1818 00423074 2