

U.S.G.S.
FILE COPY
Inspection and Editing.

UNITED STATES
DEPARTMENT OF THE INTERIOR
GEOLOGICAL SURVEY

TOPOGRAPHY
STATE OF CALIFORNIA
WILLIAM D. STEPHENS, GOVERNOR
W. F. McCLURE, STATE ENGINEER

CALIFORNIA
(FRESNO COUNTY)
CHANEY RANCH QUADRANGLE

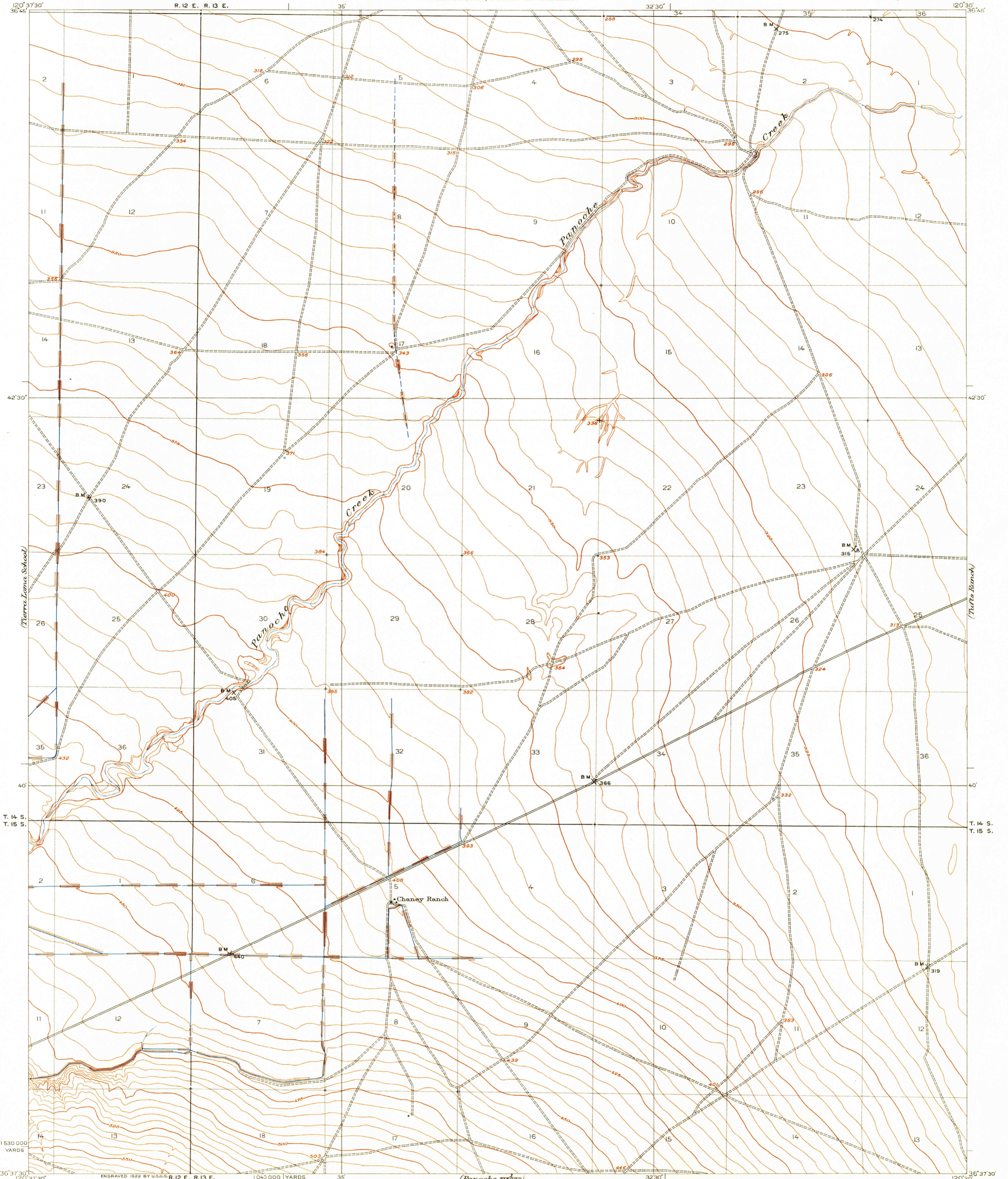

T. 14 S.
T. 15 S.

1530 000
YARDS
36° 37' 30"
120° 37' 30"
ENGRAVED 1922 BY U.S.G.S. R. 12 E. R. 13 E.
1045 000 YARDS
35
(Paroche 1:50,000)
Scale 1:50,000
32° 30'
120° 30'

C.H. Birdseye, Chief Topographic Engineer.
Geo. R. Davis, Division Topographic Engineer.
Topography by R.A. Kiger and Adolph Fankhauser.
Control by L.F. Biggs and C.F. Urquhart.
Surveyed in 1920.

Kiger
Fankhauser

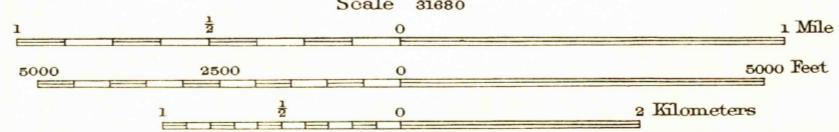

Contour interval 5 feet.
Datum is mean sea level.

APPROXIMATE MEAN
MAGNETIC NORTH
DECLINATION, 1920

Polyconic projection, North American datum.
5000 yard grid based upon zone G for P.M.M.

CHANEY RANCH
Edition of 1922

U.S.G.S.
FILE COPY
Inspection and Editing.

OCT 19 1940 1105