

U.S.G.S.  
FILE COPY  
Inspection and Library

(El Rio Ranch)

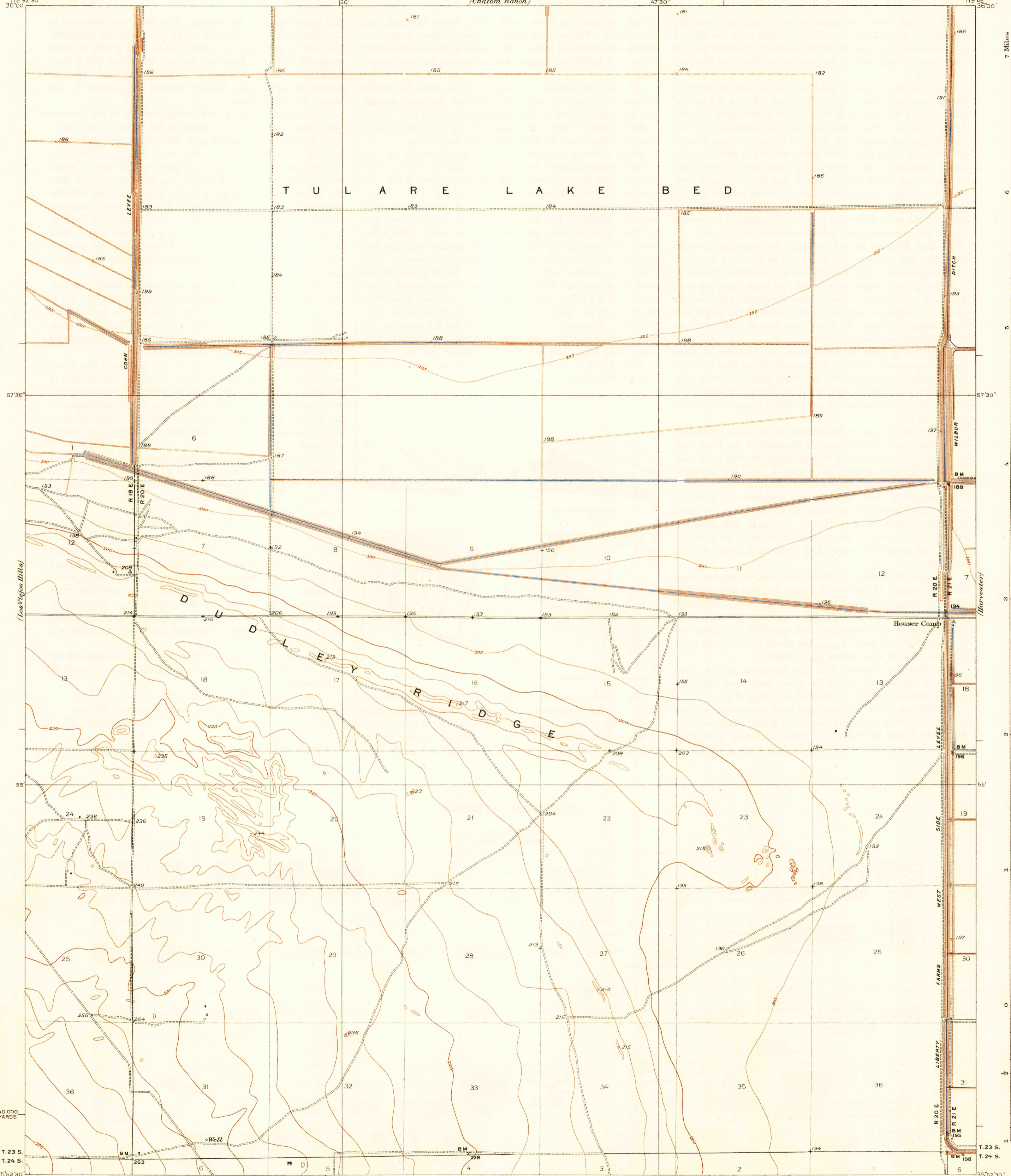

7 Miles  
6  
5  
4  
3  
2  
1  
0  
1  
2  
3  
4  
5  
6  
7 Miles

Topography by F.A. Wuopio  
Control by U.S. Geological Survey  
Surveyed in 1932

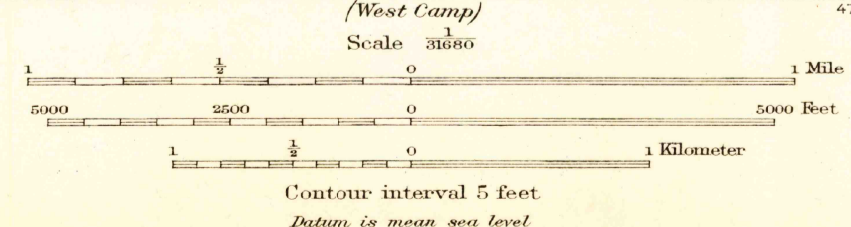

Polyconic projection, North American datum  
5000 yard grid based upon U.S. zone system, 6

USGS  
Historical File  
Topographic Division  
Inspection and Library

DUDLEY RIDGE, CALIF.  
Edition of 1936

MAY 29 1936 (1875)

1875