

(Kettleman City)

UNITED STATES
DEPARTMENT OF THE INTERIOR
GEOLOGICAL SURVEY

STATE OF CALIFORNIA
REPRESENTED BY THE
DIRECTOR OF PUBLIC WORKS
(Chatom Ranch)

U. S. G. S.
FILE COPY
Inspection and Editing.

CALIFORNIA
(KINGS COUNTY)
DUDLEY RIDGE QUADRANGLE

(El Rio Ranch)

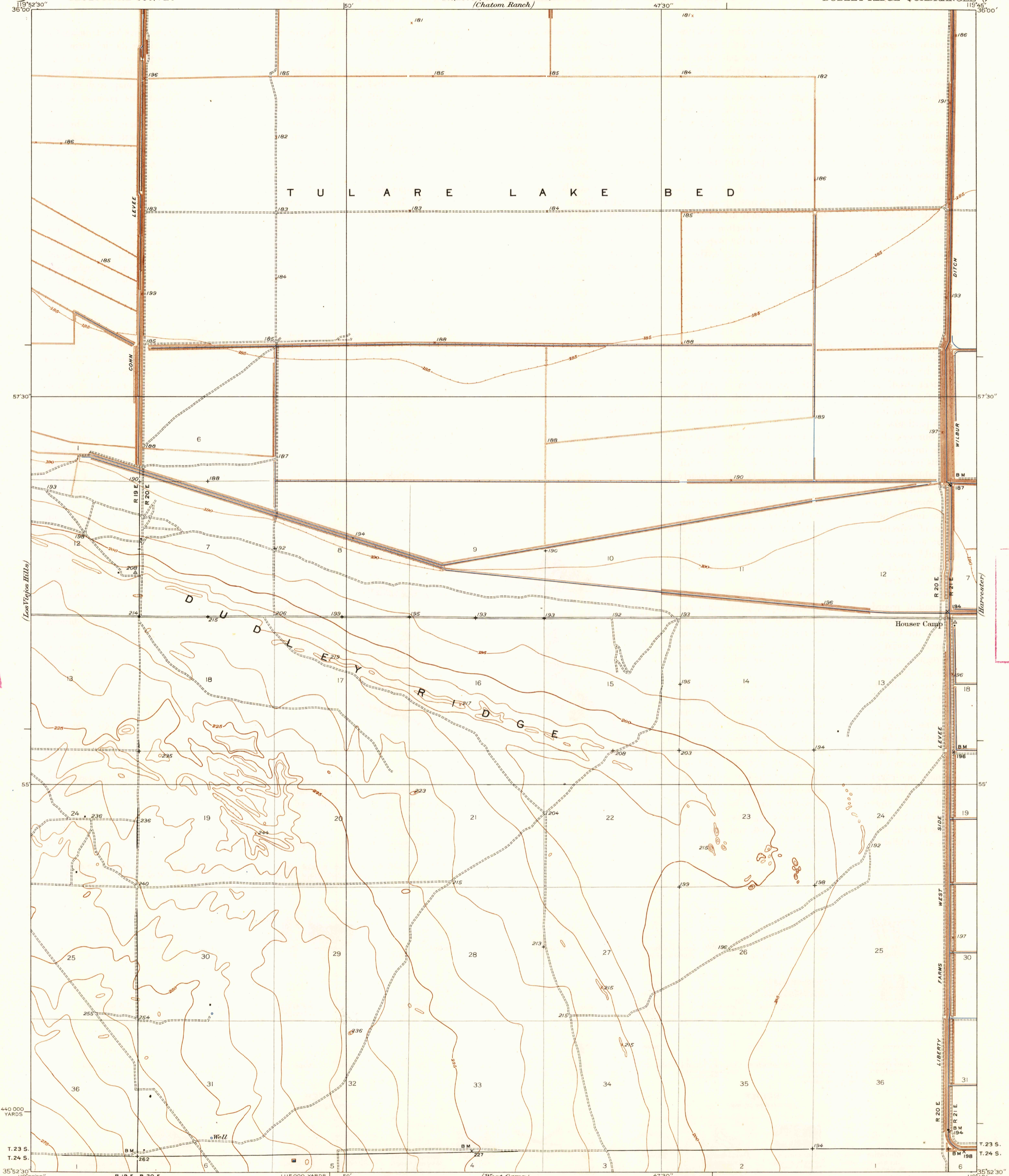

U. S. G. S.
FILE COPY
Inspection and Editing.

U. S. G. S.
FILE COPY
Inspection and Editing.

Topography by F.A. Wuopio
Surveyed in 1932

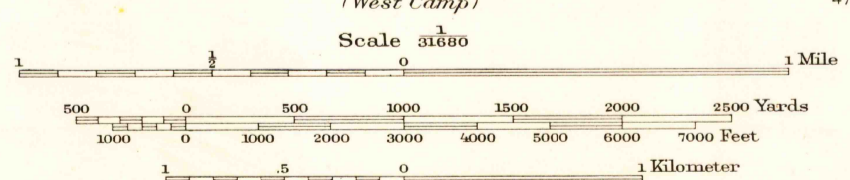
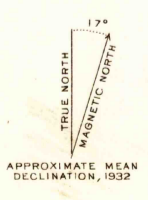

Contour interval 5 feet
Datum is mean sea level
Readjustment indicates that elevations
on this map should be decreased 1 foot

Polyconic projection North American datum
5000 yard grid based upon U.S. zone system G

USGS
Historical File
Topographic Division
U. S. G. S.
FILE COPY
Inspection and Editing.

DUDLEY RIDGE, CALIF.
Edition of 1936
reprinted 1947
N35525-W11945/75

May 28 1947 2120