

FILE COPY
Inspection and Editing

UNITED STATES
DEPARTMENT OF THE INTERIOR
GEOLOGICAL SURVEY

STATE OF CALIFORNIA
REPRESENTED BY THE
DIRECTOR OF PUBLIC WORKS

CALIFORNIA
(KERN COUNTY)
FAIRFAX SCHOOL QUADRANGLE

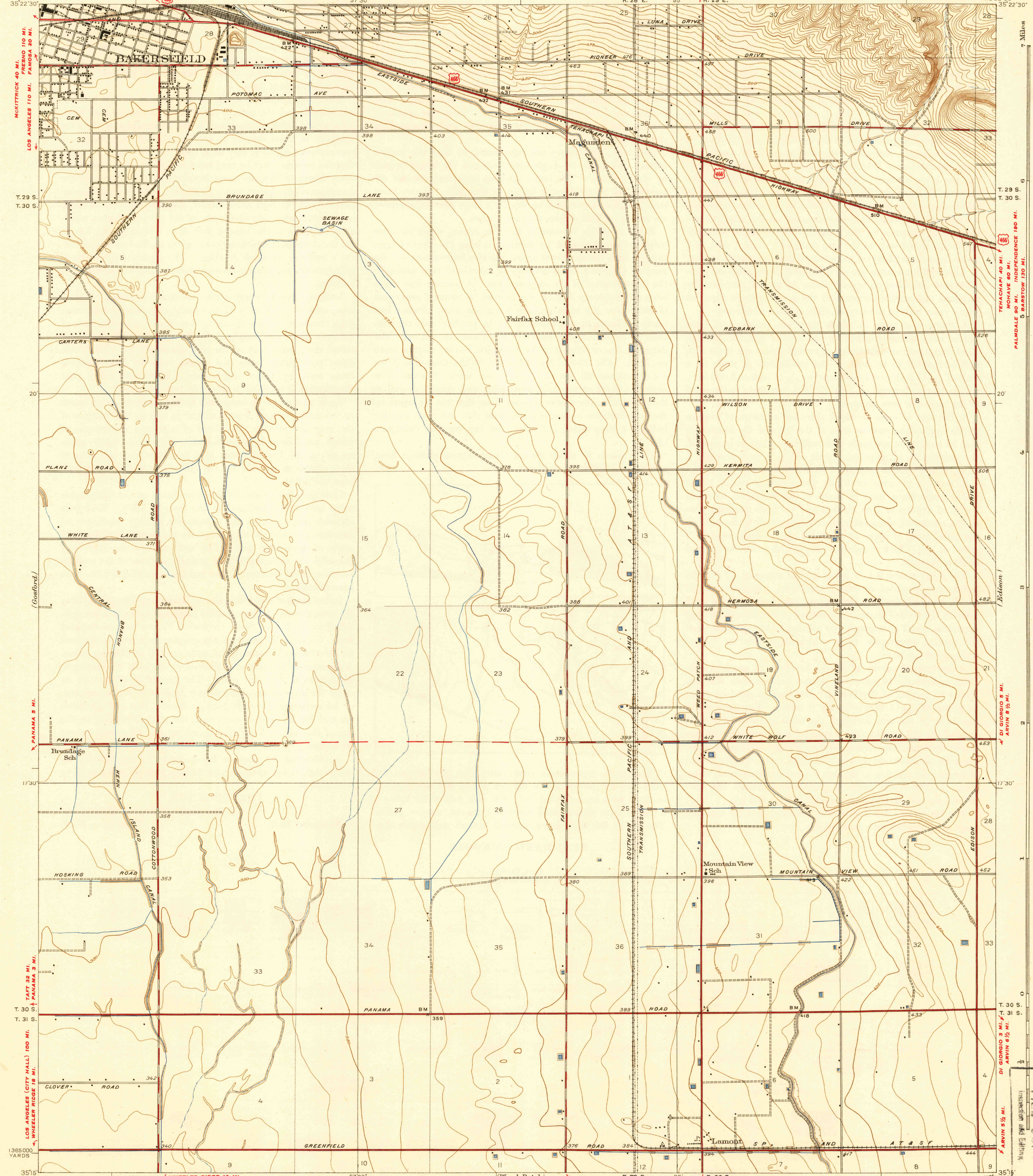

Topography by S. N. Stoner and C. A. Stoner
Surveyed in 1929

APPROXIMATE MEAN
DECLINATION, 1929

Scale 1:62,500
1 Mile
1 Kilometer
Contour interval 5 feet
Datum is mean sea level

Polyconic projection, North American datum
5000 yard grid based upon U.S. zone system, G
ROADS IMPROVISED SURFACED
ROADS OTHERWISE SURFACED
1932
UNITED STATES ROUTE NUMBER
FAIRFAX SCHOOL, CALIF.
Edition of 1932
reprinted 1939
OCT 18 1939