

Canas Creek

DEPARTMENT OF THE INTERIOR
U. S. GEOLOGICAL SURVEY

61-N-11-E/2
STATE OF CALIFORNIA
JAMES ROLPH, JR., GOVERNOR
WALTER E. GARRISON, DIRECTOR OF PUBLIC WORKS
EDWARD HYATT, STATE ENGINEER
(Discovery Well)

Advance sheet
Subject to correction

CALIFORNIA
(KING'S COUNTY)
KETTLEMAN PLAIN QUADRANGLE



H. H. Hodgson, Division Engineer
Topography by E. P. Davis and
C. N. Mortenson
Control by U. S. Geological Survey
Surveyed in 1930

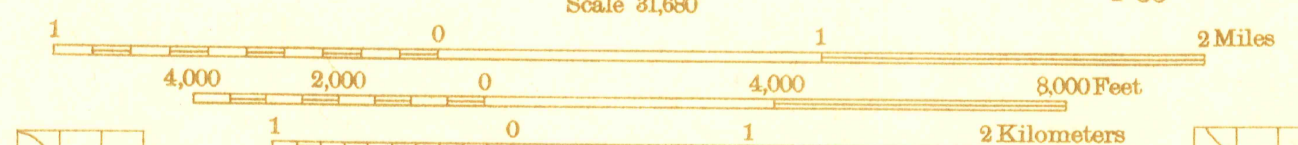
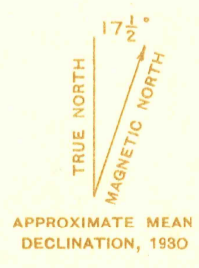

Contour interval 5 and 25 feet, (see diagram)
Datum is mean sea level

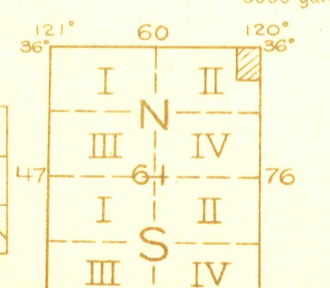

Polyconic projection, North American datum
5000 yard grid based upon U. S. zone system, G

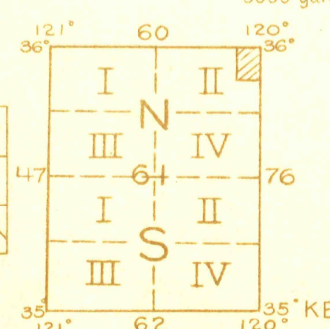

KETTLEMAN PLAIN, CALIF.

USGS
Historical File
Topographic Division

(Cholame)
1:25000

(Middle Dome)

(Alvinal Gap)