

(East Elk Hills)

DEPARTMENT OF THE INTERIOR  
U. S. GEOLOGICAL SURVEY

76-S-IV-W/2-NE/4  
STATE OF CALIFORNIA  
C. C. YOUNG, GOVERNOR  
B. B. MEEK, DIRECTOR OF PUBLIC WORKS  
EDWARD HYATT, STATE ENGINEER

CALIFORNIA  
(KERN COUNTY)  
MOUTH OF KERN QUADRANGLE

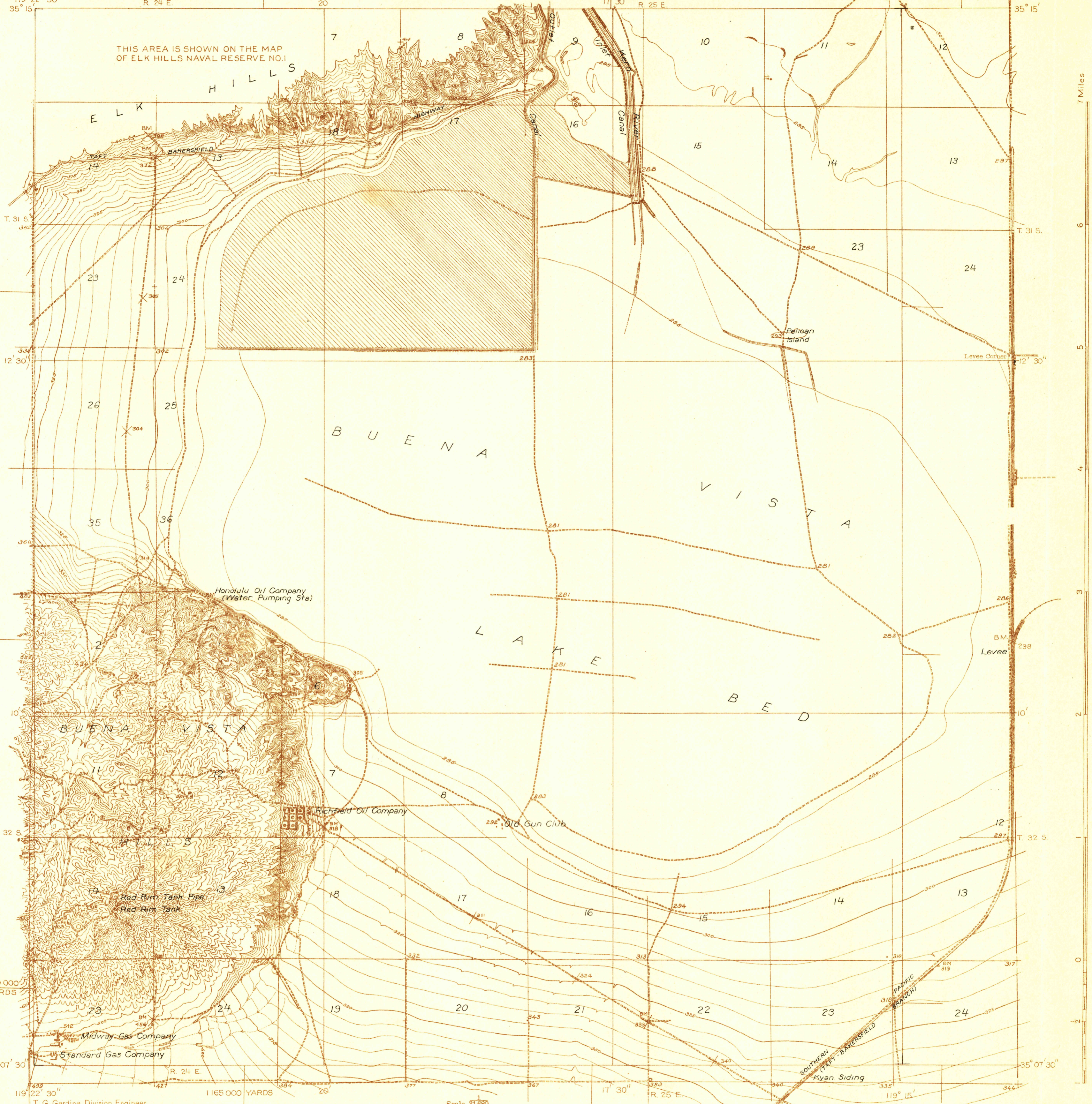

THIS AREA IS SHOWN ON THE MAP  
OF ELK HILLS NAVAL RESERVE NO. 1

Advance sheet  
Subject to correction

7 Miles

1 350 000  
YARDS

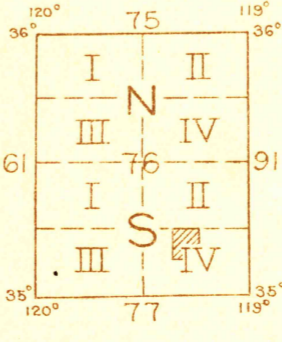
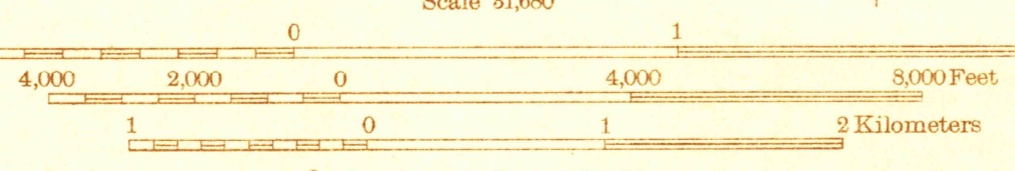
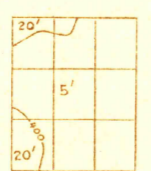
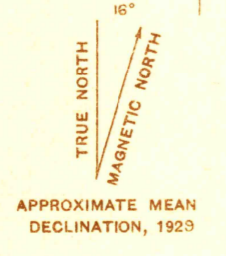

Polyconic projection. 1927 North American datum.  
5000 yard grid based upon U. S. zone system, G

MOUTH OF KERN, CALIF.

T. G. Gardine, Division Engineer  
Topography by H. L. McDonald  
Control by U. S. Geological Survey  
Surveyed in 1929