

U. S. G. S.  
**FILE COPY**  
Inspection and Editing.

UNITED STATES  
DEPARTMENT OF THE INTERIOR  
GEOLOGICAL SURVEY

STATE OF CALIFORNIA  
REPRESENTED BY THE  
DIRECTOR OF PUBLIC WORKS  
(Compton Landing)

CALIFORNIA  
(COLUSA COUNTY)  
POWELL SLOUGH QUADRANGLE

(Delaware)

(Sawborn Slough)

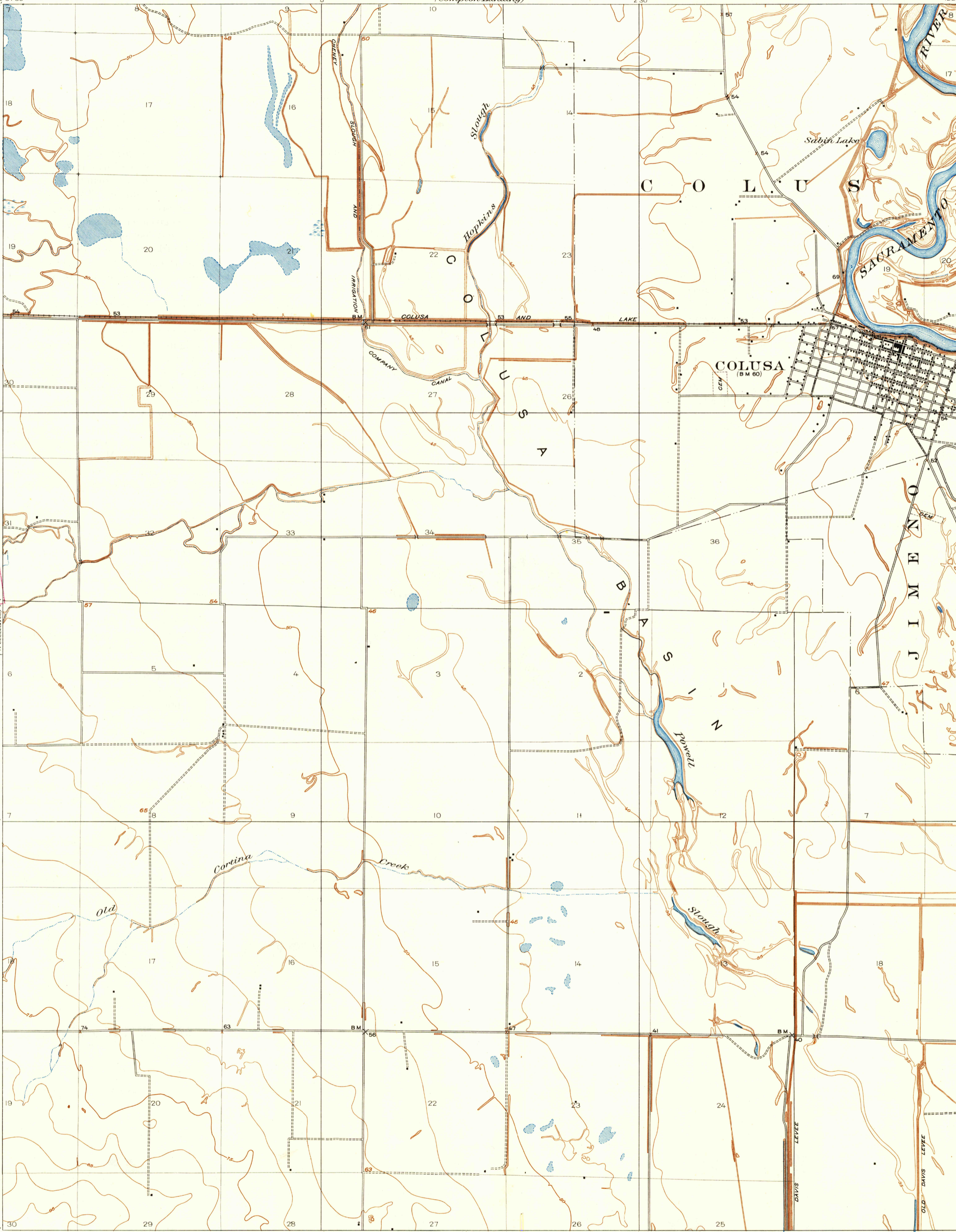

U. S. G. S.  
**FILE COPY**  
Inspection and Editing.

U. S. G. S.  
**FILE COPY**  
Inspection and Editing.

(Spring Valley)  
E. M. Douglas, Geographer.  
R. B. Marshall, in charge of section.  
Topography by W. N. Vance, H. R. Ferriss,  
J. P. Harrison, and E. F. Davis.  
Control by C. F. Urquhart and C. H. Semper.  
Surveyed in 1904-1905.

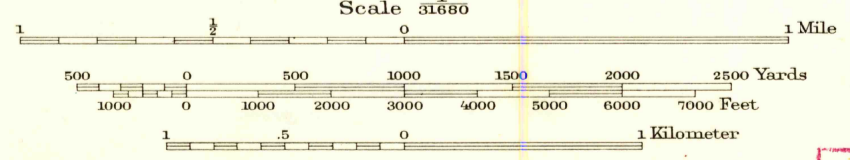
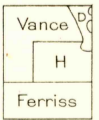

Contour interval 5 feet.  
Datum is mean sea level.  
Readjustment indicates that elevations on this map  
should be increased 1 foot

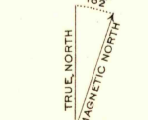

Edition of 1918, reprinted 1947  
Polyconic projection, North American datum

CALIF.  
POWELL SLOUGH  
N3907.5-W12200/75

U. S. G. S.  
**FILE COPY**  
Inspection and Editing.

USGS  
Historical File  
Topographic Division  
NAME CHANGED TO COLUSA (1:24000)

May 28 1947

2115