

(Kearney)

UNITED STATES  
DEPARTMENT OF THE INTERIOR  
GEOLOGICAL SURVEY

STATE OF CALIFORNIA  
REPRESENTED BY THE  
DIRECTOR OF PUBLIC WORKS  
(Kearney Park)

U. S. G. S.  
**FILE COPY**  
Inspection and Filing.

CALIFORNIA  
(FRESNO COUNTY)  
RAISIN QUADRANGLE

(Fresno)

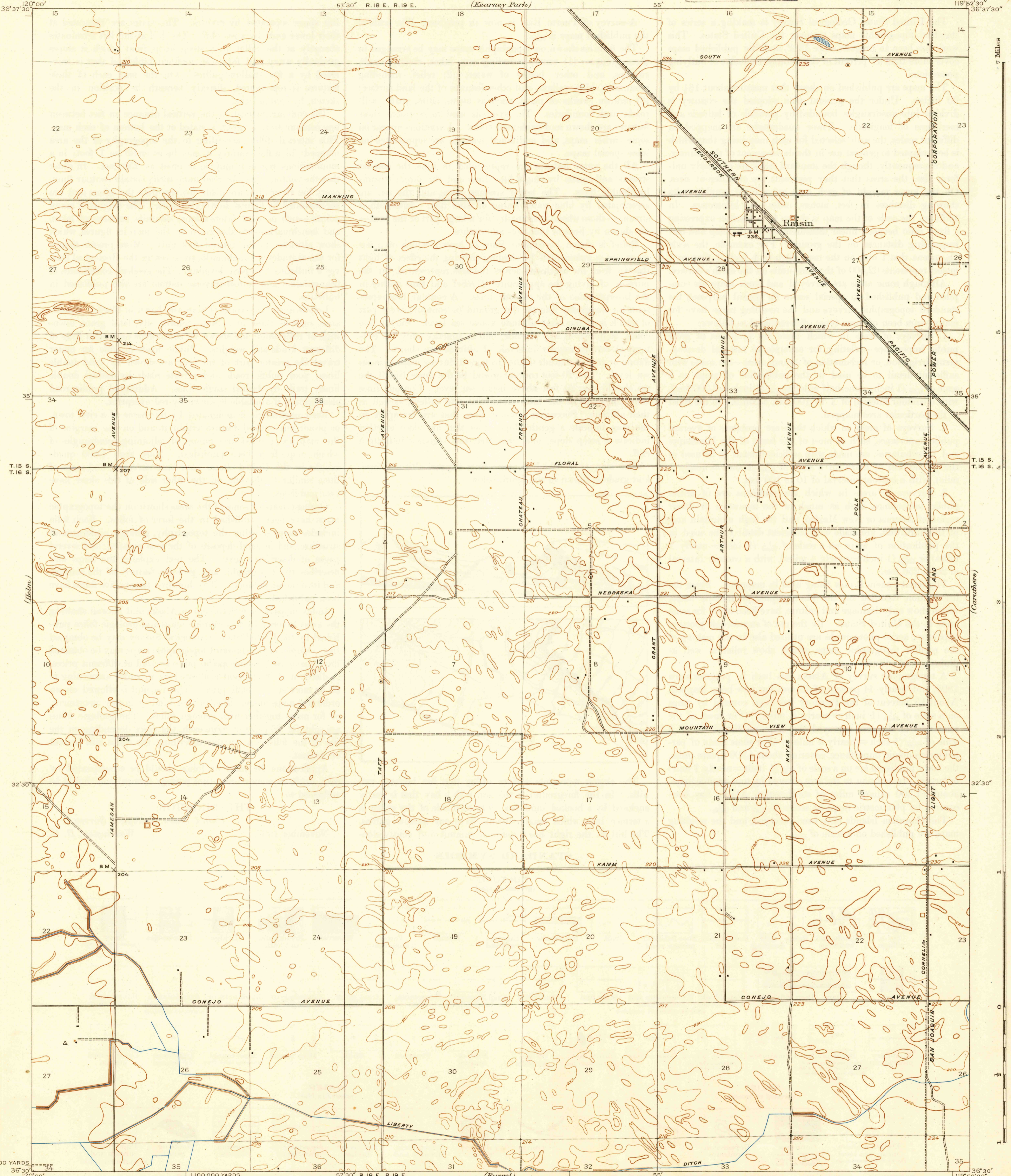

1515 000 YARDS  
36° 30'  
120° 00'  
Topography by A.B. Searle and W.G. Carson  
Surveyed in 1923

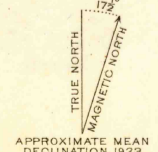

Contour interval 5 feet  
Datum is mean sea level.

Polyconic projection, North American datum  
5000 yard grid based upon U.S. zone system, G

USGS  
Historical File  
Topographic Division  
U. S. G. S.  
**FILE COPY**  
Inspection and Filing.

RAISIN, CALIF.  
Edition of 1925  
reprinted 1942  
N3630-W11952.5/7.5

APP 91 1010

1945