

60-N-11-E/2-SW/4 TOPOGRAPHY

DEPARTMENT OF THE INTERIOR
ALBERT B. FALL, SECRETARY
U. S. GEOLOGICAL SURVEY
GEORGE OTIS SMITH, DIRECTOR

STATE OF CALIFORNIA
WILLIAM D. STEPHENS, GOVERNOR
W. F. McCLURE, STATE ENGINEER

CALIFORNIA
TUMEY HILLS QUADRANGLE

Advance sheet.
Subject to correction.

(Panoche)
125000

(Chaney Ranch)

U. S. G. S.
FILE COPY
Inspection and Editing.

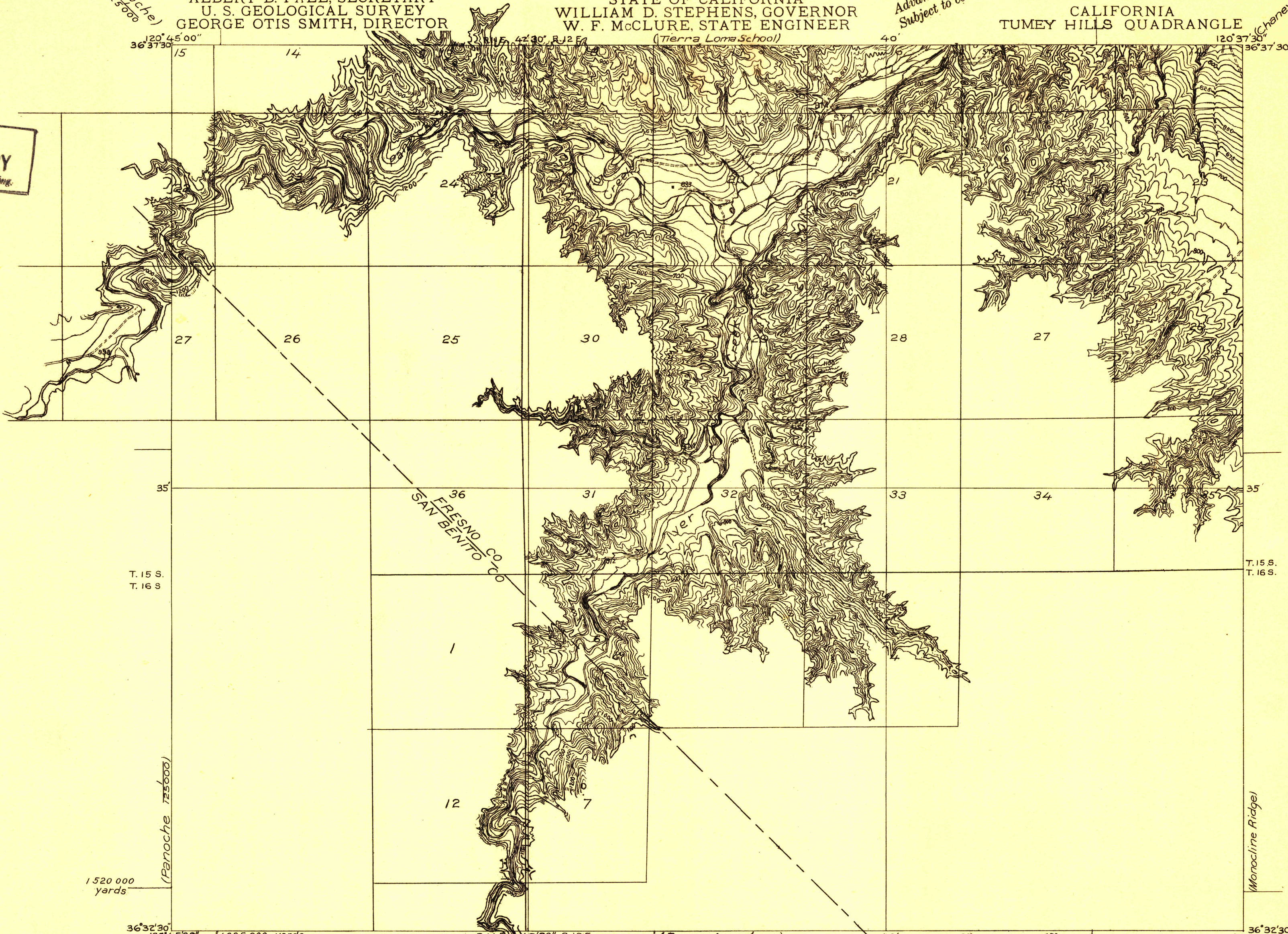

C. H. Birdseye, Chief Topographic Engineer
Geo. R. Davis, Division Topographic Engineer
Topography by R.A.Kiger
Control by L.F.Biggs and R.A.Kiger.
Surveyed in 1921.

SURVEYED IN COOPERATION WITH THE STATE OF CALIFORNIA

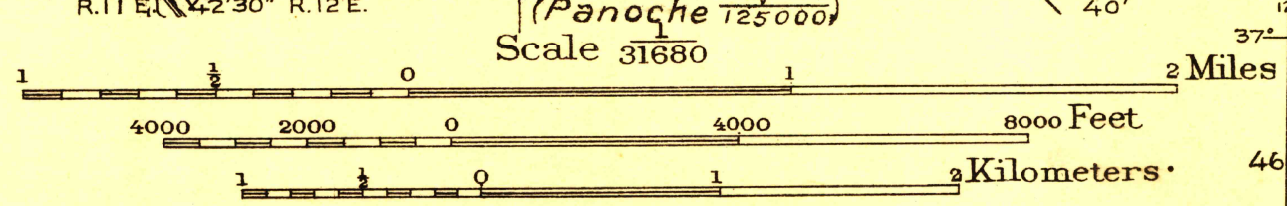

Contour interval 5 feet and 25 feet.
Changing on the 700 foot contour
Datum is mean sea level.

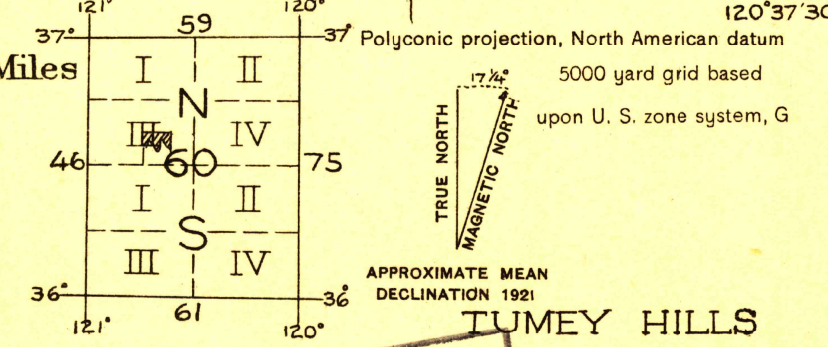

U. S. G. S.
FILE COPY
Inspection and Editing.

CALIF