

Advance sheet.
Subject to correction.

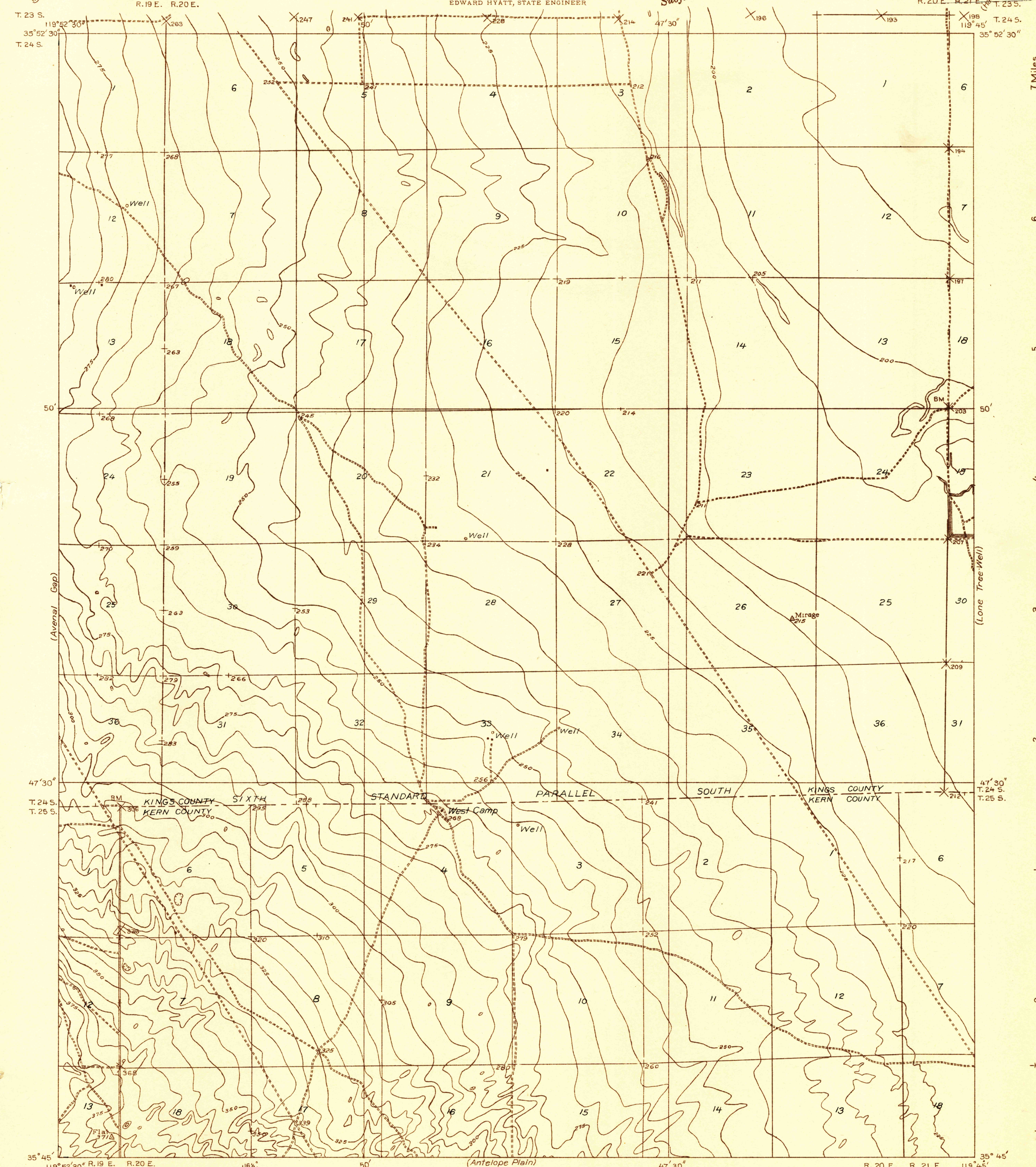

T. 23 S.
119° 52' 30"
35° 52' 30"
T. 24 S.
50'
47' 30"
T. 24 S.
T. 25 S.
35° 45'

T. 24 S.
119° 45'
35° 52' 30"
50'
47' 30"
T. 24 S.
T. 25 S.
35° 45'

7 Miles
6
5
4
3
2
1
0
-1
-2

(Lost Hills 1:25,000)
H. H. Hodgeson, Division Engineer
Topography by F. A. Wuopio
Control by U. S. Geological Survey
Surveyed in 1932

TRUE NORTH
MAGNETIC NORTH
APPROXIMATE MEAN DECLINATION, 1932

Scale 1:25,000
1 0 1 2 Miles
4,000 2,000 0 4,000 8,000 Feet
1 0 1 2 Kilometers

Contour interval 5 feet
Datum is mean sea level

USGS
Historical File
Topographic Division

Polyconic projection, 1927 North American datum
R. 20 E. R. 21 E. 119° 45'

WEST CAMP, CALIF.