

from the Chief Geographer.

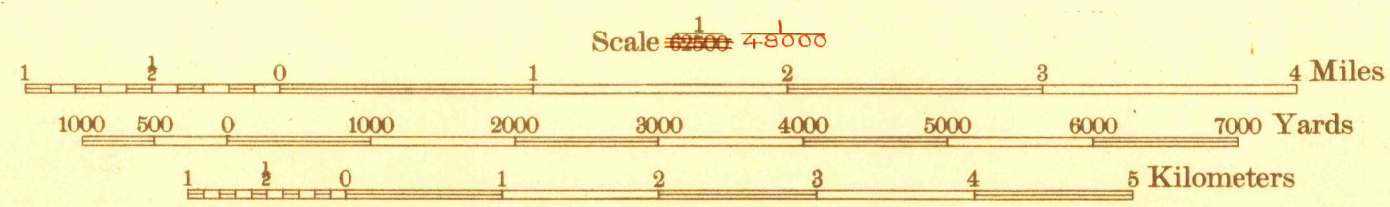

R. 2 E.
R. 3 E. (Lucia)
R. 4 E.
T. 17 S.
T. 18 S.
T. 19 S.
36° 15' N
36° 30' N

R. B. Marshall, Chief Geographer.
Geo. R. Davis, Geographer in charge.
Glenn S. Smith, Topographic Engineer,
in charge military surveys.
Topography by J. P. Harrison;
Roscoe Reeves, and C. R. Fisher.
Control by U. S. Coast and Geodetic Survey and L. F. Biggs
Surveyed in 1917.

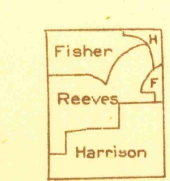

Contour interval 50 feet.
Datum is mean sea level.

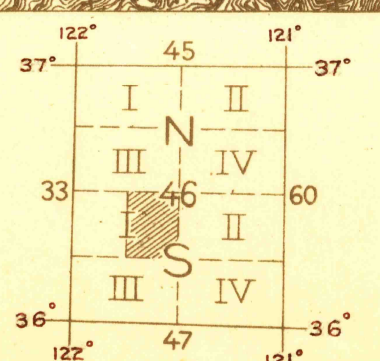

Approximate Mean Declination 1917
Edition of 1920
JAMESBURG
Unipiero Serra