

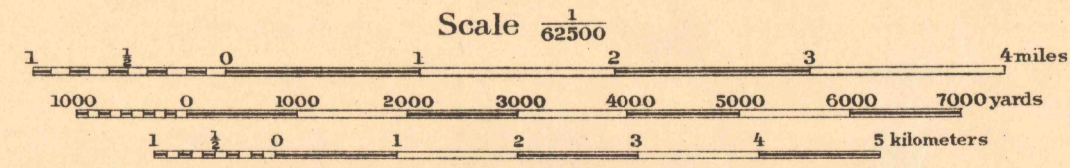

Col. Chas. L. Potter, Corps of Eng'rs., Department Engineer.
Captain R. Park, Corps of Eng'rs., Topographical Inspector.
1st. Lieut. Edw. R. Kimble, Corps of Eng'rs., in charge of party.
Sergt. R. S. Perrin, Co. F. 2nd. Eng'rs., in charge of party.
Surveyed in 1916.



Contour Interval 100 feet
Datum is mean sea level

NOTE: OFFICERS USING THIS MAP WILL MARK HEREON CORRECTIONS AND ADDITIONS WHICH COME TO THEIR ATTENTION AND MAIL DIRECT TO "THE CHIEF OF ENGINEERS, WASHINGTON, D.C."

FIVE THOUSAND YARD GRID COMPUTED FROM "GRID SYSTEM FOR PROGRESSIVE MAPS IN THE U.S." ZONE G, U.S.C. & G.S. SPECIAL PUBLICATION NO. 59. (THE LAST THREE DIGITS OF THE GRID NUMBERS ARE OMITTED.)

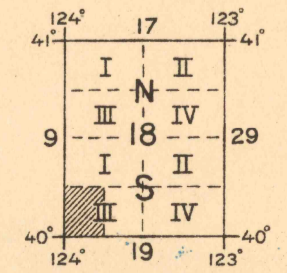

APPROXIMATE MEAN DECLINATION 1921

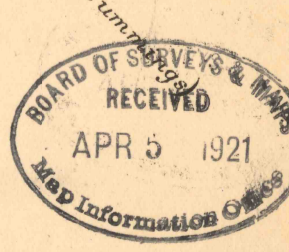

Engineer Reproduction Plant, U. S. Army, Washington Barracks, D.C. 1921

BRICELAND

Board of Surveys & Mapping
CALIF. FILE COPY
Map Information Office