

CALIFORNIA 1:62,500
N3400-W11515/15

RESTRICTED

WAR DEPARTMENT
CORPS OF ENGINEERS, U. S. ARMY

Advance edition
Subject to correction

CALIFORNIA
CADIZ VALLEY QUADRANGLE
GRID ZONE "F"

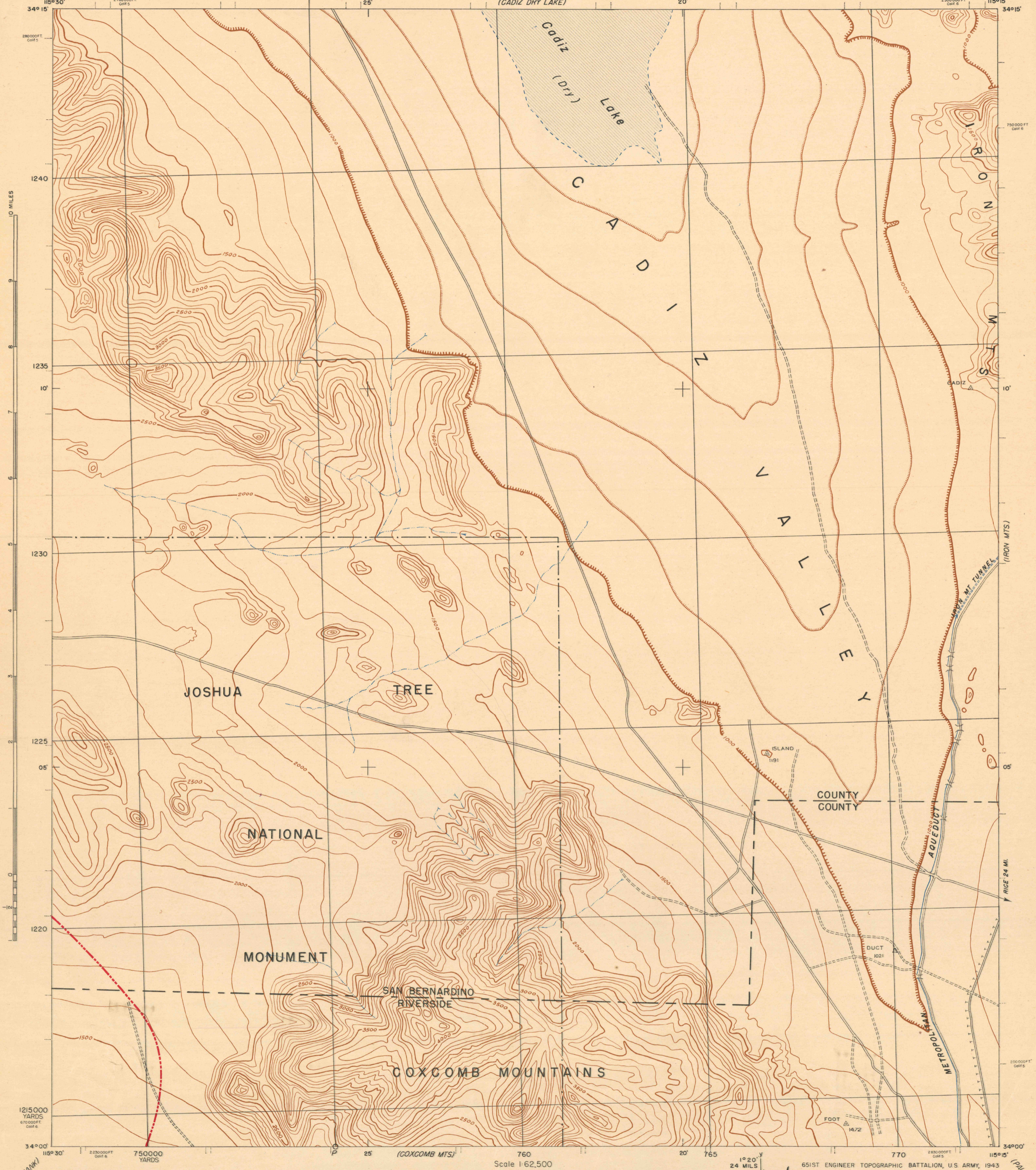

Prepared under the direction of the Commanding General, California-Arizona Maneuver Area, 1943. Compiled and Revised by 651st Engineer Topographic Battalion, U.S. Army, from maps of Metropolitan Water District, Control by U.S.C. & G.S., 29th Engineers, U.S. Army, and Metropolitan Water District Field Reconnaissance by 651st Engineers, U.S. Army 1943. Polyconic Projection, North American Datum, 1927.

ROAD CLASSIFICATION 1943

- Dependable hard-surface, heavy-duty road
- Graded not improved
- Secondary hard-surface, all-weather road
- Poor road

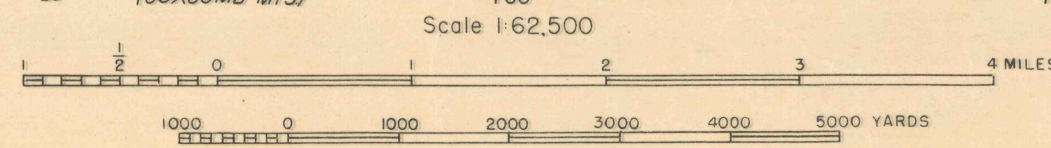

Scale 1:62,500
CONTOUR INTERVAL 100 FEET
DATUM IS MEAN SEA LEVEL

FIVE THOUSAND YARD GRID COMPUTED FROM GRID SYSTEM FOR PROGRESSIVE MAPS IN THE U.S. "ZONE F" U.S.C. & G.S. SPECIAL PUBLICATION NO. 59. THE LAST THREE DIGITS OF THE GRID NUMBERS ARE OMITTED.

THE STATE GRIDS ARE INDICATED AT 10,000 FOOT INTERVALS. NOTE: OFFICERS USING THIS MAP WILL MARK HEREON CORRECTIONS AND ADDITIONS WHICH COME TO THEIR ATTENTION AND MAIL DIRECT TO THE CHIEF OF ENGINEERS, WASHINGTON D. C.

RESTRICTED

APPROXIMATE MEAN DECLINATION 1943 FOR CENTER OF SHEET
ANNUAL MAGNETIC CHANGE 1' DECREASE
Use diagram only to obtain numerical values.
To determine magnetic north line, connect the pivot point "P" on the south edge of the map with the value of the angle between grid and magnetic north, as plotted on the degree scale at the north edge of the map.

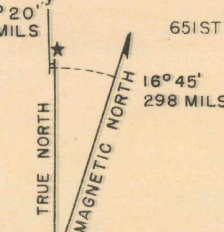

LEGEND
MANEUVER AREA BOUNDARY
AQUEDUCT CROSSING

NOTE: No attempt has been made to match the contours by The Metropolitan Water District to 29th Engineer contours on adjoining Coxcomb Mts. sheet.

121974
CADIZ VALLEY, CALIF.
N3400-W11515/15