

(Landsdale)

CORPS OF ENGINEERS, U. S. ARMY  
PROGRESSIVE MILITARY MAP

# CONTROLLED RECONNAISSANCE SHEET 19-N-1-E/2

CALIFORNIA  
CUMMINGS QUADRANGLE



(Wesport) Col. Chas. L. Potter, Corps of Engrs., Department Engineer.  
 Captain R. Park, Corps of Engrs., Topographical Inspector.  
 Sgt. Ray S. Perrin, Co. F., 2<sup>nd</sup> Engrs. in charge of party.  
 Surveyed in 1916.

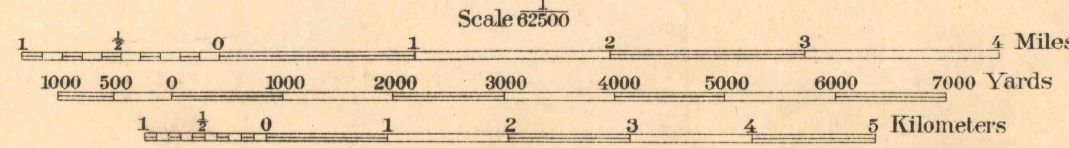

Contour Interval 100 feet.  
 Datum is mean sea level.

NOTE: OFFICERS USING THIS MAP WILL MARK HEREON CORRECTIONS AND ADDITIONS WHICH COME TO THEIR ATTENTION AND MAIL DIRECT TO THE CHIEF OF ENGINEERS, WASHINGTON, D. C.

Engineer Reproduction Plant, U. S. Army, Washington Barracks, D. C. 123° 30' W. Longitude

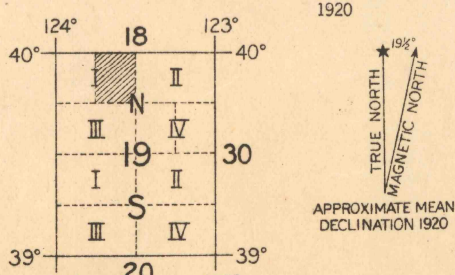

Board of Surveys & Maps  
 FILE COPY  
 Map Information Office

BOARD OF SURVEYS & MAPS  
 RECEIVED  
 JAN 20 1916  
 CUMMINGS, CALIF.  
 Map Information Office

now Leggett (8/60)

5