

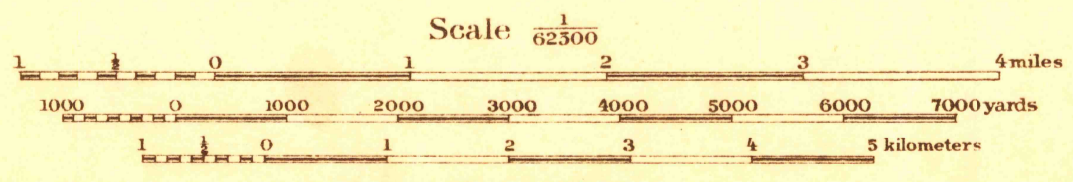

Revision by means of Bagley Aerial Camera  
Photography by 2nd Lts. W. K. Wood and T. J. Giboney, Engrs.  
Jan. 1919  
Transformation and revision under the direction of  
Capt. C. E. Giffin, Engrs., Engineer Reproduction Plant  
Feb. 1920  
Base map from U. S. G. S. original drawing.

USGS  
Historical File  
Topographic Division



Contour Interval 50 feet  
Datum is mean sea level

NOTE: OFFICERS USING THIS MAP WILL MARK HEREON CORRECTIONS AND ADDITIONS WHICH COME TO THEIR ATTENTION AND MAIL DIRECT TO "THE CHIEF OF ENGINEERS, WASHINGTON, D.C."

FIVE THOUSAND YARD GRID COMPUTED FROM "GRID SYSTEM FOR PROGRESSIVE MAPS IN THE U. S." ZONE G. U. S. C. & G. S. SPECIAL PUBLICATION NO. 59.  
(THE LAST THREE DIGITS OF THE GRID NUMBERS ARE OMITTED.)

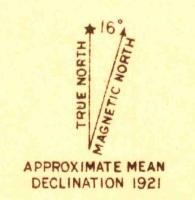
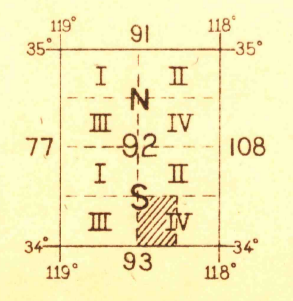

APPROXIMATE MEAN DECLINATION 1921  
SANTA MONICA

Engineer Reproduction Plant, U. S. Army, Washington Barracks, D. C.

RETURN TO:  
USGS NMD HISTORICAL MAP ARCHIVES

JUL 2 1927 1000 copies  
delivered by War Dept.

FILE COPY