

Revision by means of Boleley Aerial Camera.
Photography by 2nd. Lts. W. K. Wood, and T.J. Gibney, Engrs.
Jan. 1919.
Transformation and revision under the direction of
Capt. C. E. Griffin, Engrs., Engineer Reproduction Plant,
Feb. 1920.
Base map from U. S. G. S. original drawing

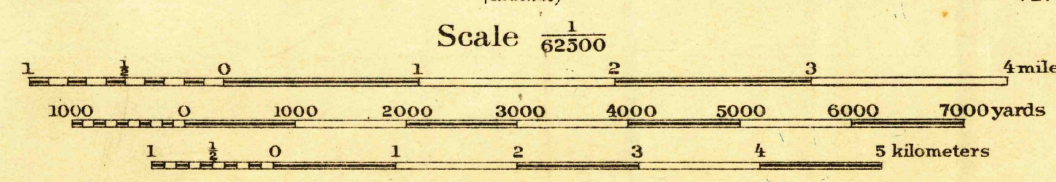

Contour Interval 50 feet
Datum is mean sea level

RETURN TO:
USGS NMD HISTORICAL MAP ARCHIVES

NOTE: OFFICERS USING THIS MAP WILL MARK HEREON CORRECTIONS AND ADDITIONS WHICH COME
TO THEIR ATTENTION AND MAIL DIRECT TO "THE CHIEF OF ENGINEERS, WASHINGTON, D.C."

FIVE THOUSAND YARD GRID COMPUTED FROM "GRID SYSTEM FOR PROGRESSIVE MAPS
IN THE U.S." ZONE G. U. S. C. & G. S. SPECIAL PUBLICATION NO. 59.
(THE LAST THREE DIGITS OF THE GRID NUMBERS ARE OMITTED)

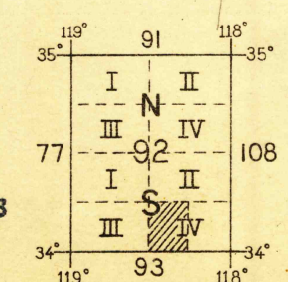

APPROXIMATE MEAN
DECLINATION 1921

SANTA MONICA

Engineer Reproduction Plant, U. S. Army, Washington Barracks, D. C.
1921

USGS Library
Reston, VA.
Topo Archive

U. S. G. S.
FILE COPY
Inspection and Editing.

Nov. 17. 21. 2500 delivered to Map...