

Mapped, edited, and published by the Geological Survey
Control by USGS and USC&GS
Compiled in 1963 from 1:24 000-scale maps dated 1962
Polyconic projection. 1927 North American datum
10,000-foot grids based on California coordinate system,
zones 3 and 2
1000-meter Universal Transverse Mercator grid ticks,
zone 10, shown in blue
Areas covered by dashed light-blue pattern are subject to
controlled inundation
Blue hatching indicates areas to be submerged by New Hogan
Reservoir at elevation 680 and by Camanche Reservoir
at elevation 236

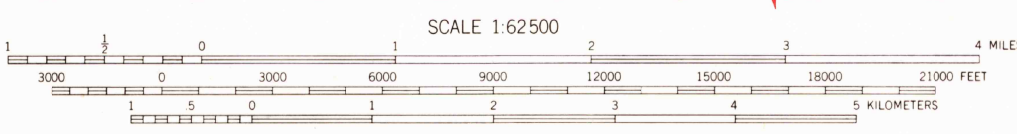

ROAD CLASSIFICATION
Medium duty ——— Light-duty ———
Unimproved dirt - - - - -
State Route (circle with number)

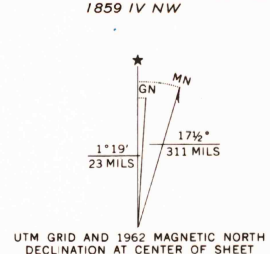

This area also covered by 7.5-minute, 1:24 000-scale
maps: Valley Springs 1962, Wallace 1962, Valley Springs SW
1962, and Jenny Lind 1962
VALLEY SPRINGS, CALIF.
N3800—W12045/15

THIS MAP COMPLIES WITH NATIONAL MAP ACCURACY STANDARDS
FOR SALE BY U.S. GEOLOGICAL SURVEY, DENVER, COLORADO 80225, OR WASHINGTON, D. C. 20242
A FOLDER DESCRIBING TOPOGRAPHIC MAPS AND SYMBOLS IS AVAILABLE ON REQUEST