

170  
(Livermore)

#5-9 47

UNITED STATES  
DEPARTMENT OF THE INTERIOR  
GEOLOGICAL SURVEY

COLORADO  
GREELEY QUADRANGLE

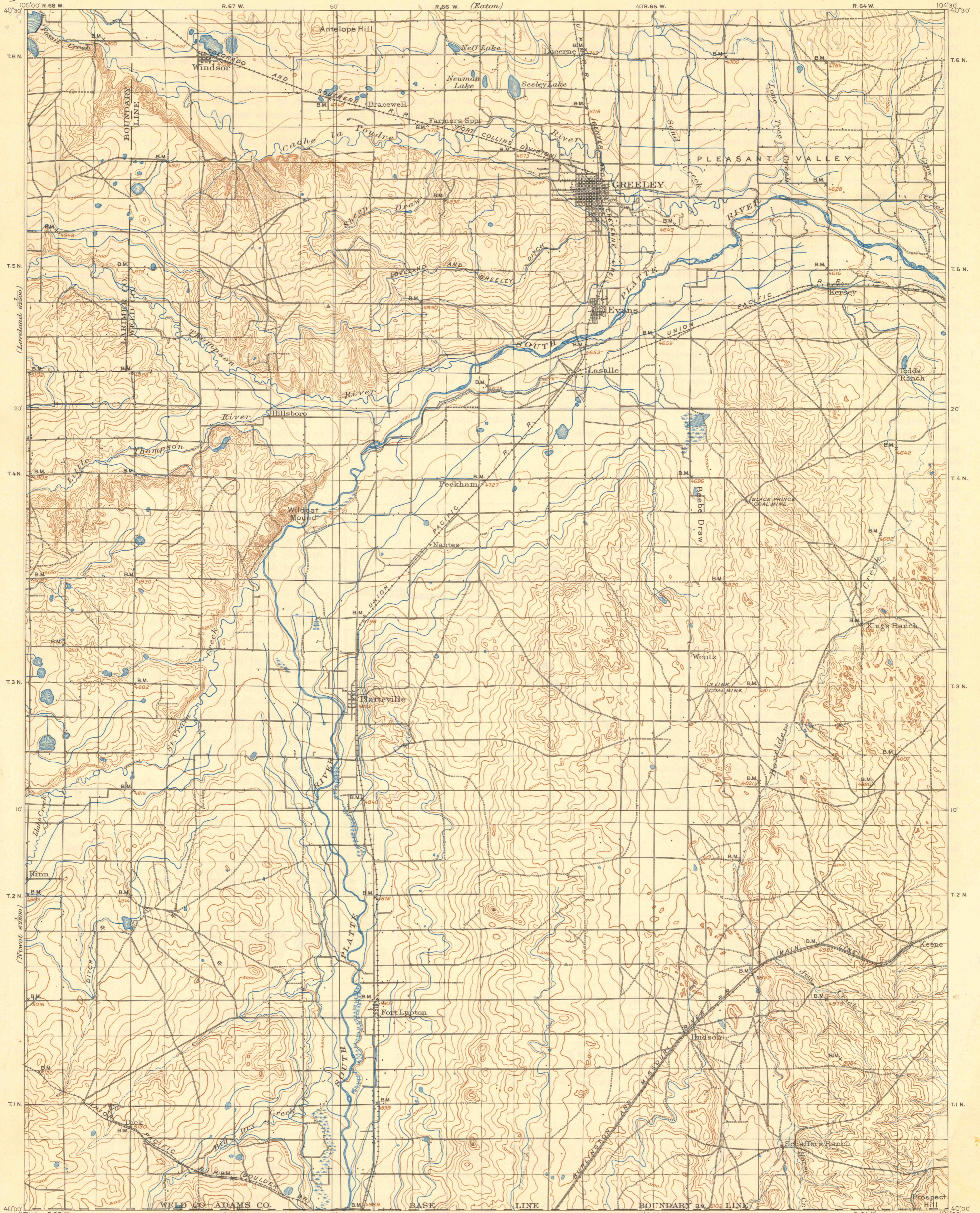

(Denver) E.M. Douglas Geographer in charge.  
Triangulation by H.L. Baldwin, Jr.  
Topography by W.M. Beaman,  
W.J. Lloyd and Arthur Stiles.  
Surveyed in 1899-1900.

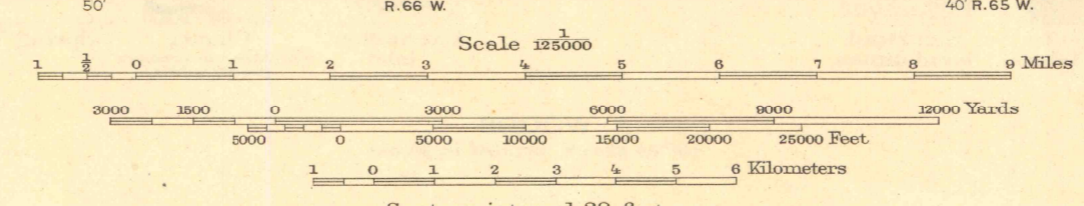
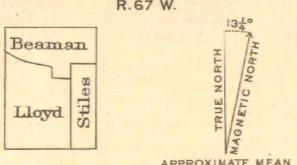

Contour interval 20 feet.  
Datum is mean sea level.  
(Readjustment indicates that elevations  
on this map should be decreased 2 feet.)

DIAGRAM OF TOWNSHIP

6	5	4	3	2	1
7	8	9	10	11	12
18	17	16	15	14	13
19	20	21	22	23	24
30	29	28	27	26	25
31	32	33	34	35	36

Edition of May 1902, reprinted 1949  
Polyconic projection.

COLO.  
GREELEY  
N4000-W10430/30

LIBRARY USE ONLY OFFICE COPY



Duplicate  
of 73.