

Mapped, edited, and published by the Geological Survey

Control by USGS and NOS/NOAA
Topography by photogrammetric methods from aerial photographs taken 1962. Field checked 1963

Polyconic projection 1927 North American Datum
10,000-foot grids based on Colorado coordinate system, central and south zones
1000 meter Universal Transverse Mercator grid ticks, zone 13, shown in blue

Certain land lines are omitted because of insufficient data
To place on the predicted North American Datum 1983 move the projection lines 4 meters north and 54 meters east as shown by dashed corner ticks

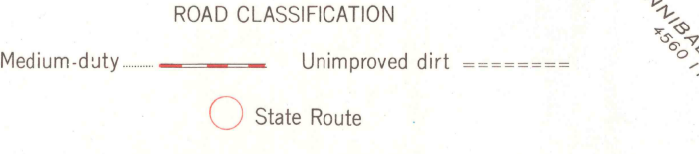
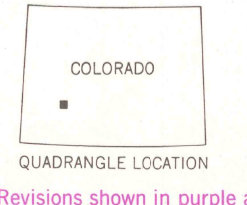
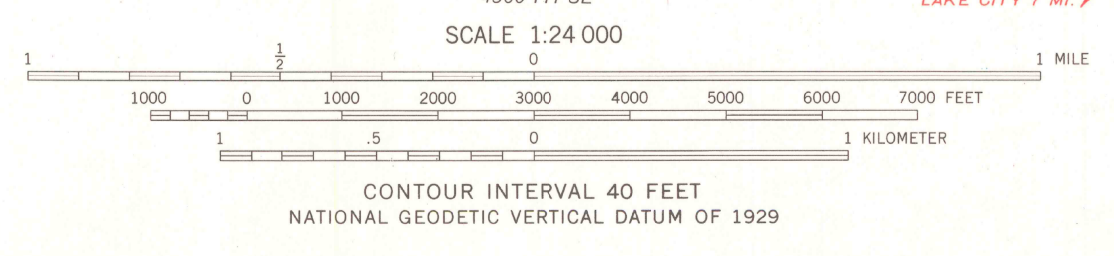
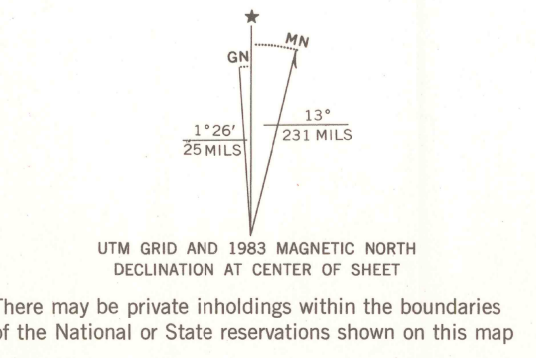

ALPINE PLATEAU, COLO.
38107-B3-TF-024

THIS MAP COMPLIES WITH NATIONAL MAP ACCURACY STANDARDS
FOR SALE BY U. S. GEOLOGICAL SURVEY, DENVER, COLORADO 80225, OR RESTON, VIRGINIA 22092
A FOLDER DESCRIBING TOPOGRAPHIC MAPS AND SYMBOLS IS AVAILABLE ON REQUEST

Revisions shown in purple and woodland compiled from aerial photographs taken 1978 and other source data
This information not field checked. Map edited 1983

1963
PHOTOREVISED 1983
DMA 4560 III NE-SERIES V877