

UNITED STATES  
DEPARTMENT OF THE INTERIOR  
GEOLOGICAL SURVEY

ALVIN NE QUADRANGLE  
COLORADO-NEBRASKA  
7.5 MINUTE SERIES (TOPOGRAPHIC)

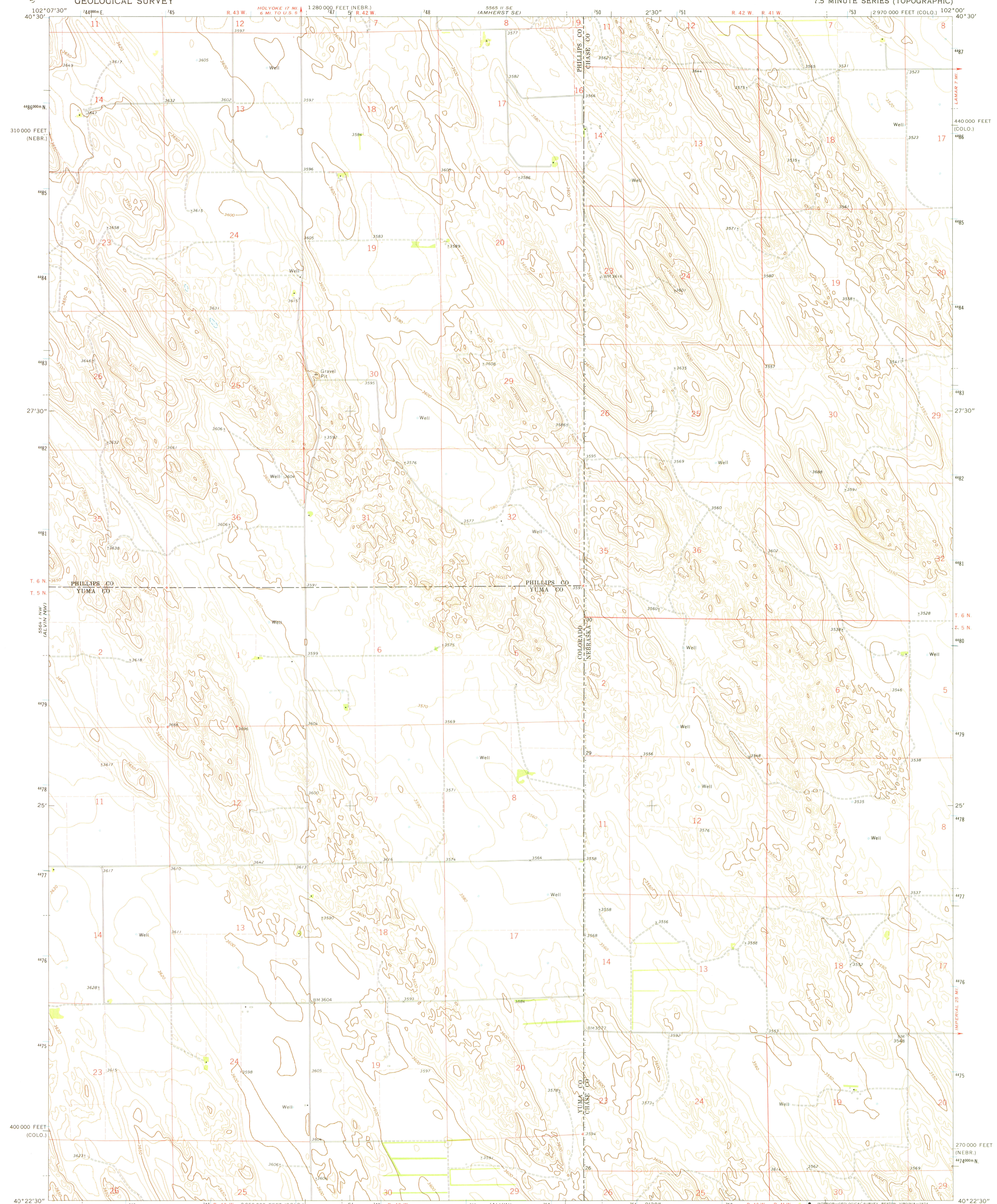

Mapped, edited, and published by the Geological Survey

Control by USGS and USC&GS  
Topography by photogrammetric methods from aerial photographs taken 1970. Field checked 1971  
Projection: Colorado coordinate system, (Lambert conformal conic)  
10,000-foot grid ticks based on Colorado coordinate system, north zone and Nebraska coordinate system south zone  
1000-meter Universal Transverse Mercator grid ticks, zone 13, shown in blue. 1927 North American datum  
Fine red dashed lines indicate selected fence lines

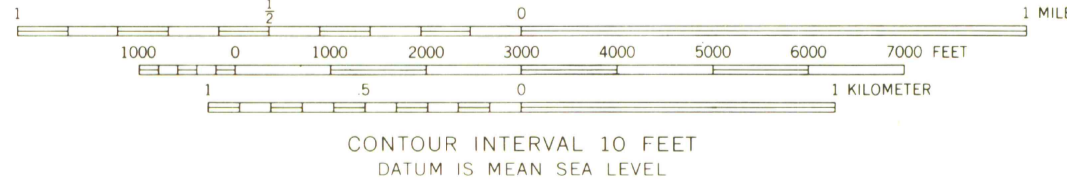
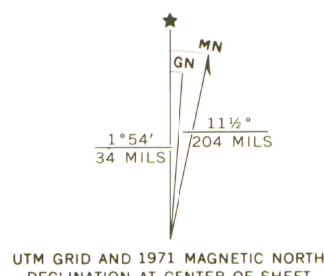

ROAD CLASSIFICATION  
 Primary highway, hard surface ——— Light-duty road, hard or improved surface ———  
 Secondary highway, hard surface ——— Unimproved road ———  
 Interstate Route ——— U. S. Route ——— State Route ———

LIBRARY USE ONLY

THIS MAP COMPLIES WITH NATIONAL MAP ACCURACY STANDARDS  
 FOR SALE BY U. S. GEOLOGICAL SURVEY, DENVER, COLORADO 80225, OR RESTON, VIRGINIA 22092  
 A FOLDER DESCRIBING TOPOGRAPHIC MAPS AND SYMBOLS IS AVAILABLE ON REQUEST

ALVIN NE, COLO.-NEBR.  
 N4022.5-W10200/7.5

1971

AMS 5564 I NE-SERIES V877

OFFICE COPY