

UNITED STATES  
DEPARTMENT OF THE INTERIOR  
GEOLOGICAL SURVEY

ALVIN QUADRANGLE  
COLORADO-NEBRASKA  
7.5 MINUTE SERIES (TOPOGRAPHIC)

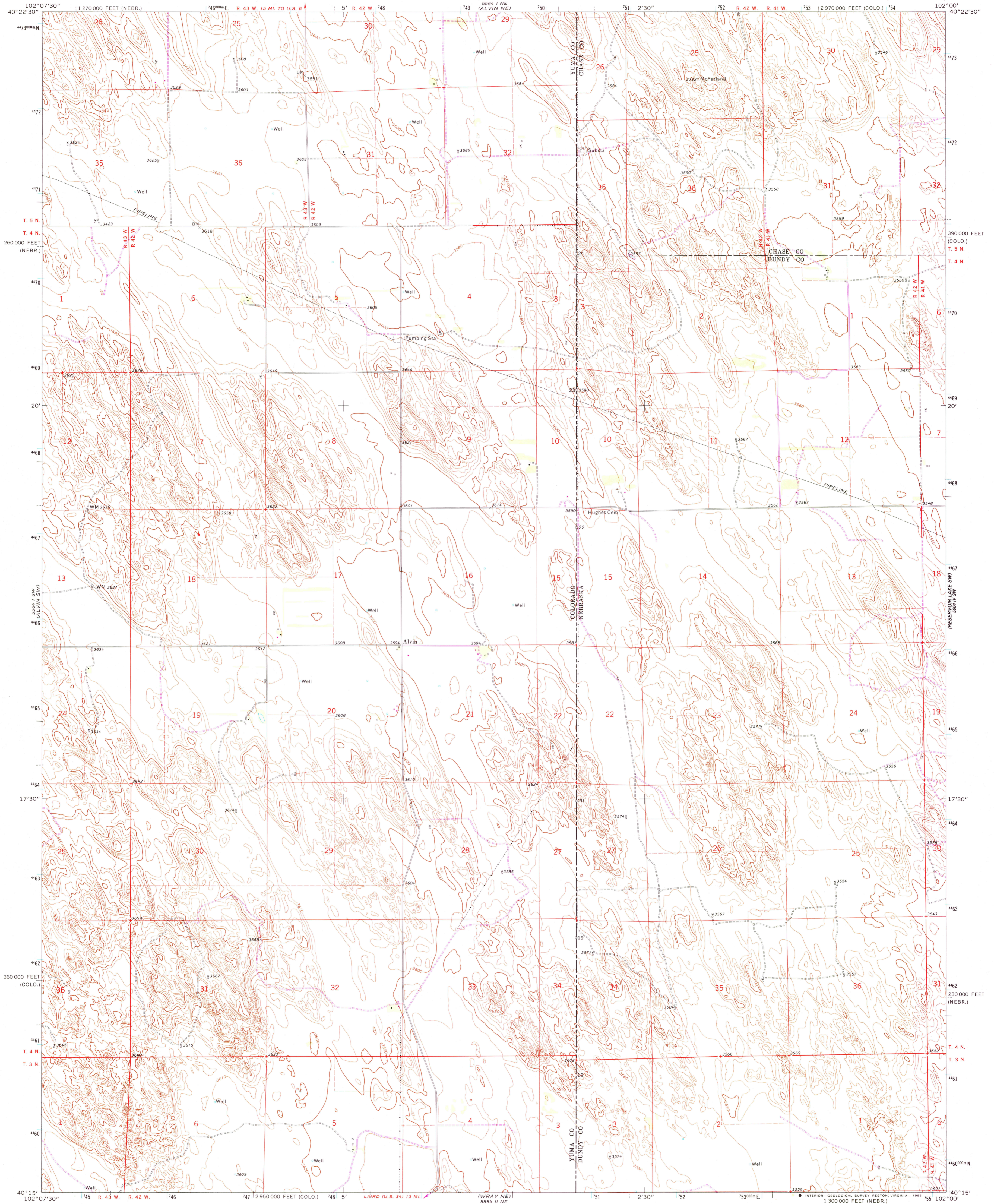

Mapped, edited, and published by the Geological Survey  
Control by USGS and NOS/NOAA  
Topography by photogrammetric methods from aerial photographs taken 1970. Field checked 1971  
Projection: Colorado coordinate system, north zone (Lambert conformal conic) 10,000-foot grid ticks based on Colorado coordinate system, north zone and Nebraska coordinate system, south zone 1000-meter Universal Transverse Mercator grid ticks, zone 13, shown in blue. 1927 North American Datum  
Fine red dashed lines indicate selected fence lines T. 3-4 N., R. 42 W., Sixth Principal Meridian are duplicated in Colorado and Nebraska

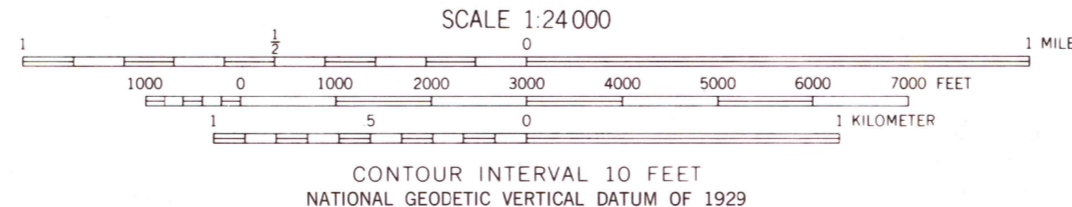
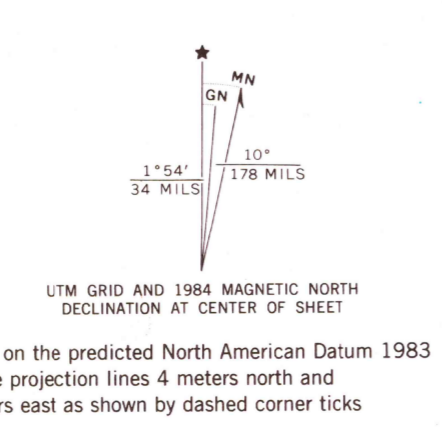

ROAD CLASSIFICATION

Primary highway, hard surface	Light-duty road, hard or improved surface
Secondary highway, hard surface	Unimproved road
Interstate Route	U. S. Route
	State Route

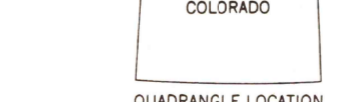

THIS MAP COMPLIES WITH NATIONAL MAP ACCURACY STANDARDS  
FOR SALE BY U.S. GEOLOGICAL SURVEY, DENVER, COLORADO 80225, OR RESTON, VIRGINIA 22092  
A FOLDER DESCRIBING TOPOGRAPHIC MAPS AND SYMBOLS IS AVAILABLE ON REQUEST

Revisions shown in purple compiled from aerial photographs taken 1980 and other source data. This information not field checked. Map edited 1984

ALVIN, COLO.—NEBR.  
40102-C1-TF-024  
1971  
PHOTOREVISED 1984  
DMA 5564 1 SE-SERIES V877