

5363 II SW  
(ELBA SW)

UNITED STATES  
DEPARTMENT OF THE INTERIOR  
GEOLOGICAL SURVEY

ARICKAREE QUADRANGLE  
COLORADO—WASHINGTON CO.  
7.5 MINUTE SERIES (TOPOGRAPHIC)

5363 II SW  
(DE LOVA)

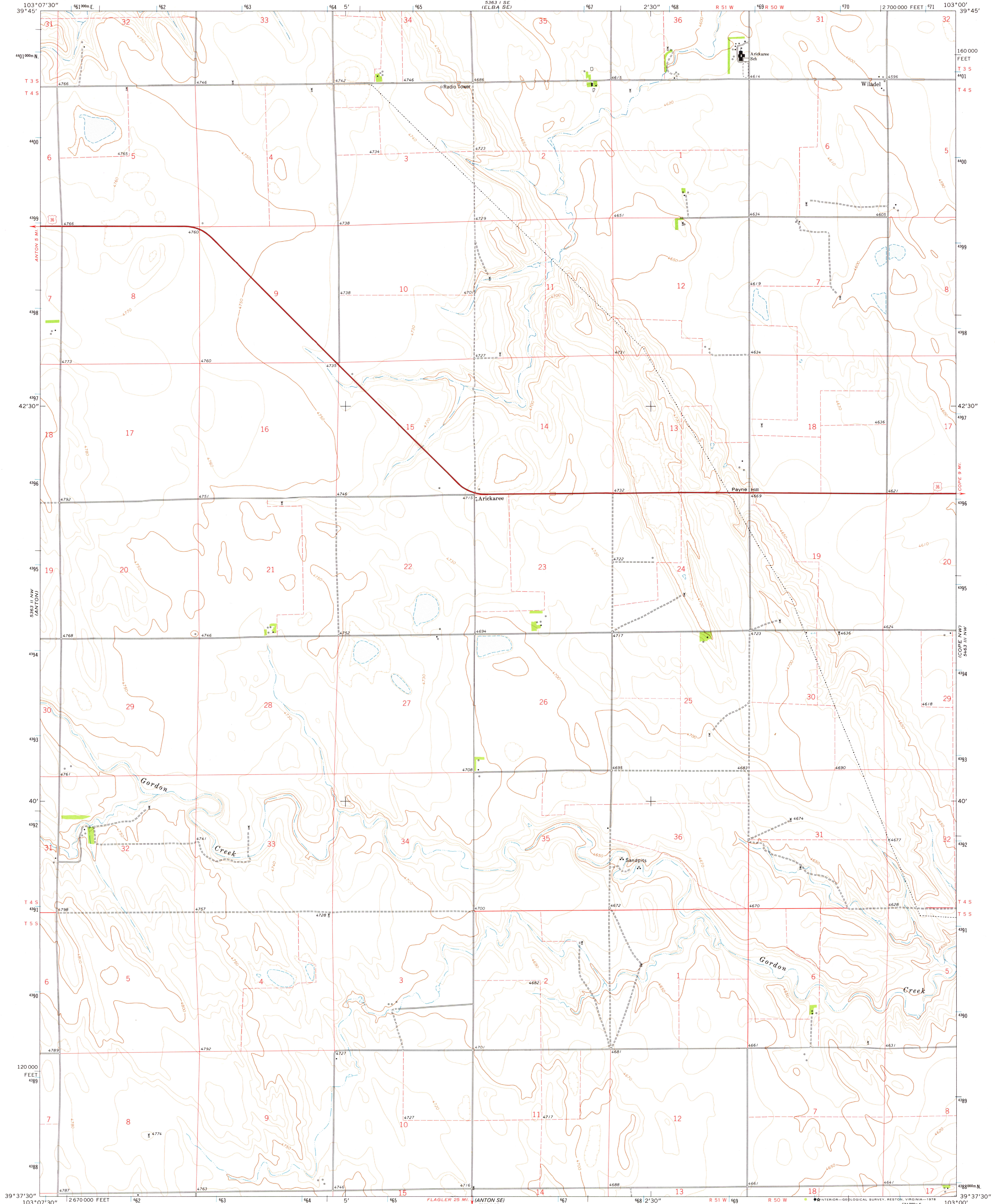

Mapped, edited, and published by the Geological Survey  
Control by USGS and NOS/NOAA  
Topography by photogrammetric methods from aerial photographs taken 1973. Field checked 1974. Map edited 1977  
Projection and 10,000-foot grid ticks: Colorado coordinate system, north zone (Lambert conformal conic)  
1000-meter Universal Transverse Mercator grid ticks, zone 13, shown in blue. 1927 North American datum  
Fine red dashed lines indicate selected fence lines

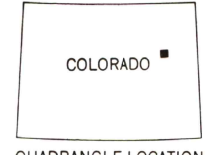
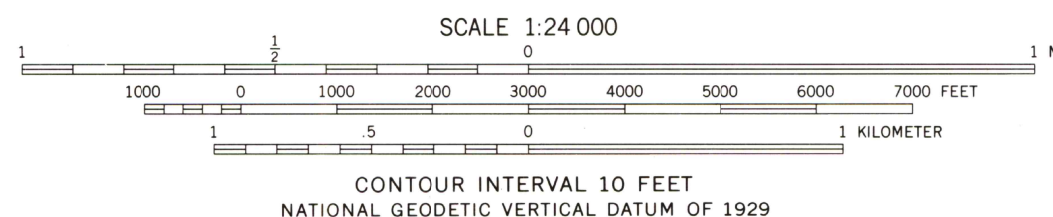
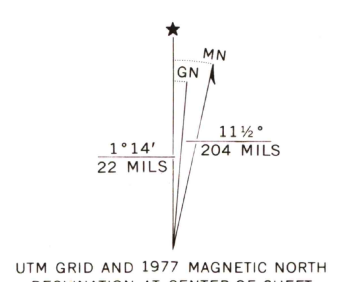

ROAD CLASSIFICATION  
Primary highway, hard surface ——— Light-duty road, hard or improved surface ———  
Secondary highway, hard surface ——— Unimproved road ———  
Interstate Route ——— U. S. Route ——— State Route ———

ARICKAREE, COLO.  
N3937.5—W10300/7.5

1977

AMS 5363 II NE—SERIES V877