

UNITED STATES
DEPARTMENT OF THE INTERIOR
GEOLOGICAL SURVEY

BENNETT QUADRANGLE
COLORADO-ADAMS CO.
7.5 MINUTE SERIES (TOPOGRAPHIC)

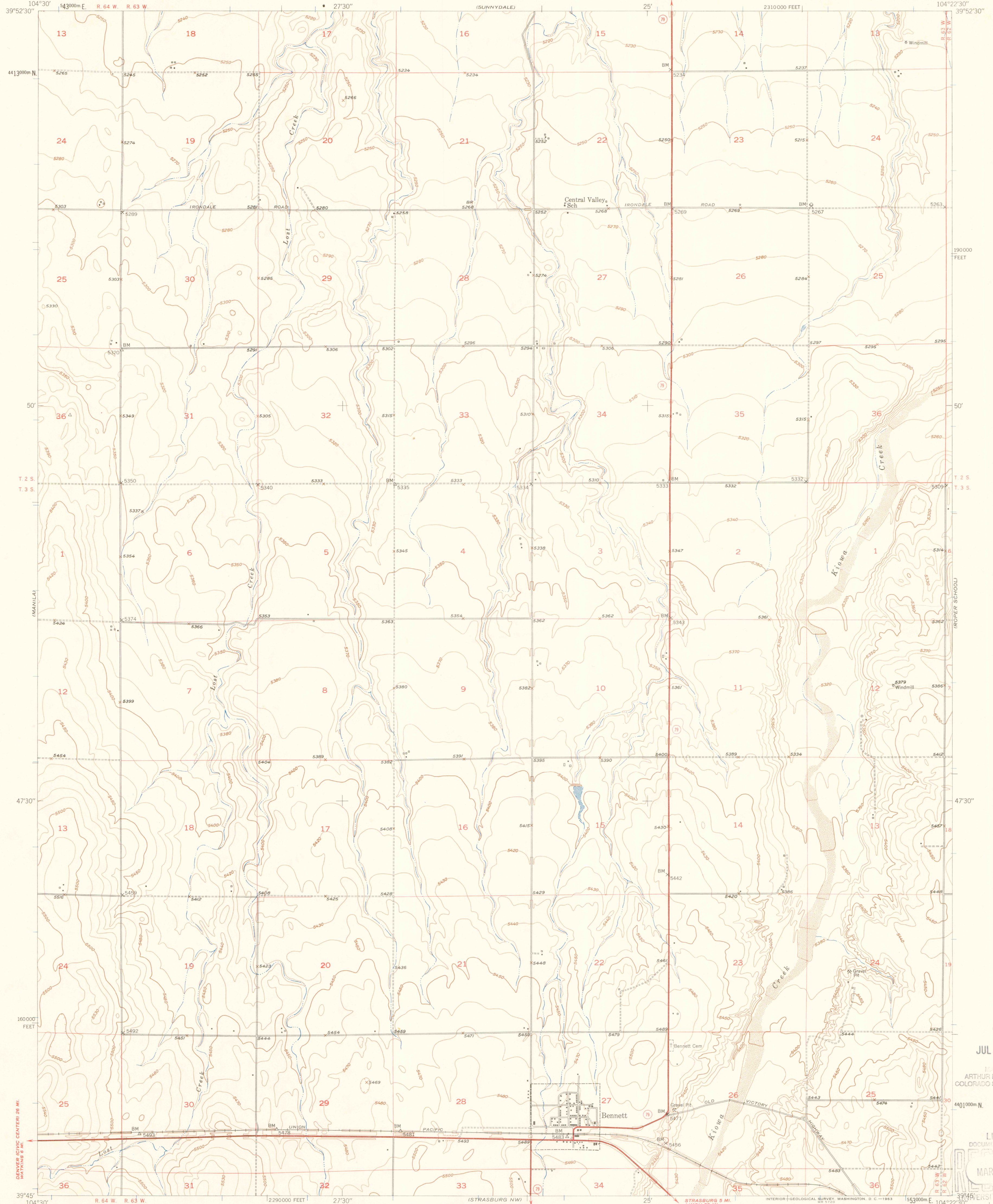

Mapped, edited, and published by the Geological Survey
as part of the Department of the Interior program
for the development of the Missouri River Basin

Control by USGS and USC&GS

Topography from aerial photographs by multiplex methods,
and by plane-table surveys 1949
Aerial photographs taken September 1948

Polyconic projection. 1927 North American datum
10,000-foot grid based on Colorado coordinate system,
north zone
1000-meter Universal Transverse Mercator grid ticks,
zone 13, shown in blue

TRUE NORTH
MAGNETIC NORTH
APPROXIMATE MEAN
DECLINATION, 1949

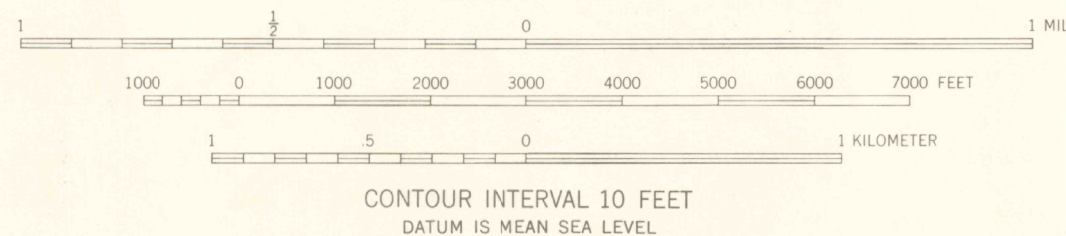

THIS MAP COMPLIES WITH NATIONAL MAP ACCURACY STANDARDS
FOR SALE BY U. S. GEOLOGICAL SURVEY, DENVER 25, COLORADO OR WASHINGTON 25, D. C.
A FOLDER DESCRIBING TOPOGRAPHIC MAPS AND SYMBOLS IS AVAILABLE ON REQUEST

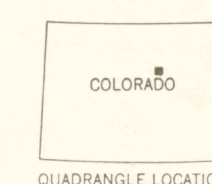

ROAD CLASSIFICATION
Heavy-duty ——— Light-duty ———
Unimproved dirt ———
State Route ———

OFFICE COPY
LIBRARY USE ONLY

BENNETT, COLO.
N3945-W10422-5/7.5
1949

JUL 06 2000

ARTHUR LAKES LIBRARY
COLORADO SCHOOL OF MINES

LIBRARY
DOCUMENT COLLECTION

MAR 30 1985

UNIVERSITY OF WYOMING
LARAMIE

G3700
s24
g4

copy 2 w/b