

HUDSON (UNCL. INTERSTATE 80) 24 MI.
12 MI. TO COLO. 82

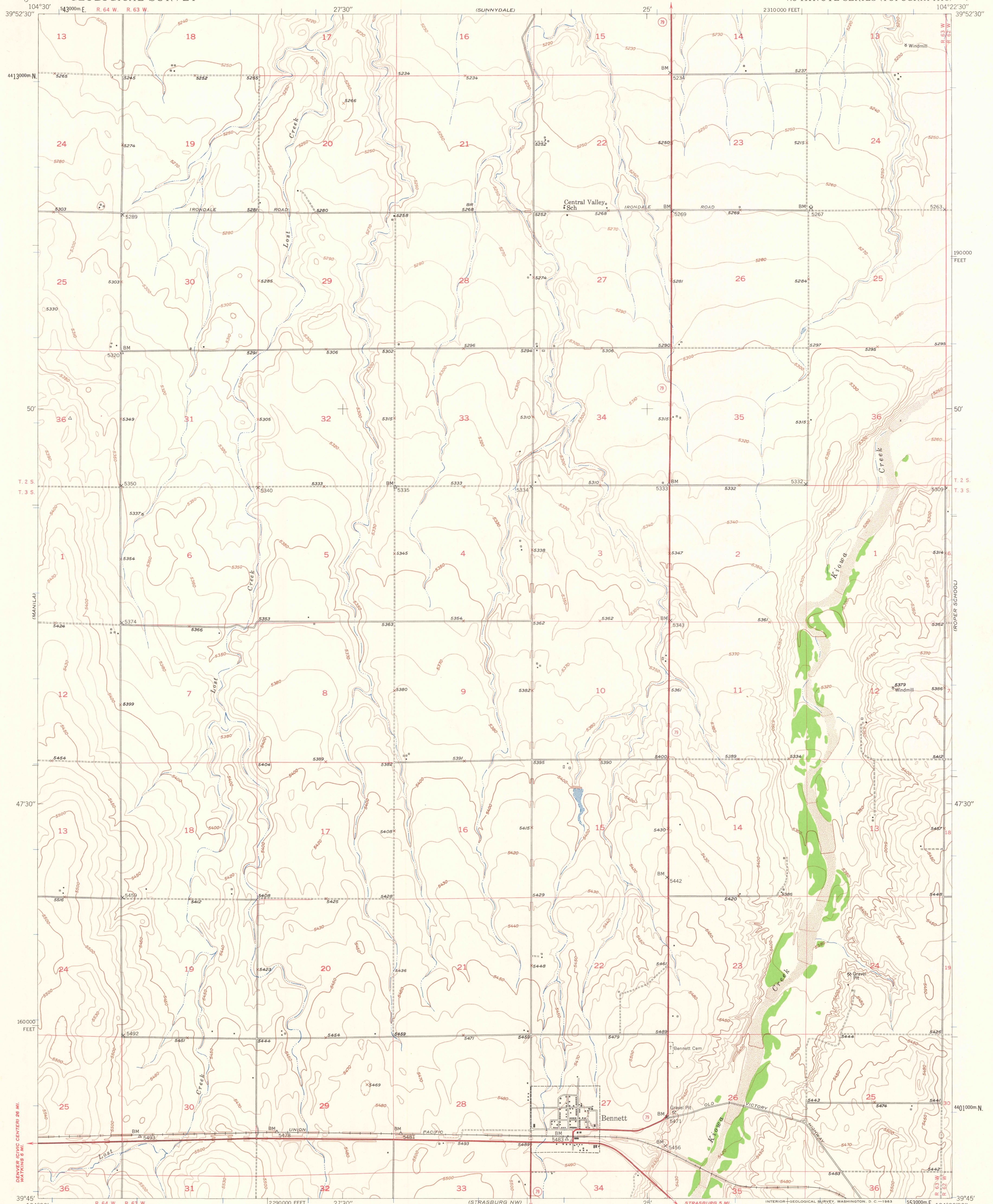

Mapped, edited, and published by the Geological Survey as part of the Department of the Interior program for the development of the Missouri River Basin
Control by USGS and USC&GS
Topography from aerial photographs by multiplex methods, and by plane-table surveys 1949
Aerial photographs taken September 1948
Polyconic projection. 1927 North American datum, 10,000-foot grid based on Colorado coordinate system, north zone
1000-meter Universal Transverse Mercator grid ticks, zone 13, shown in blue

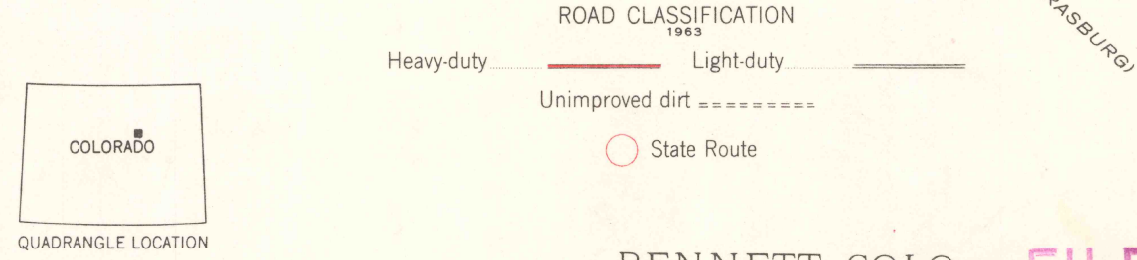
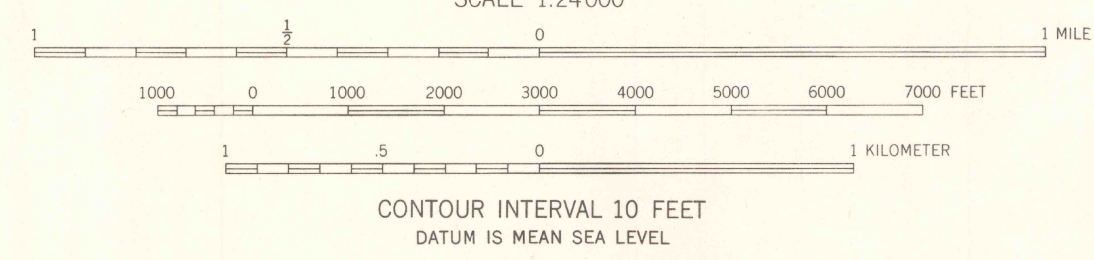
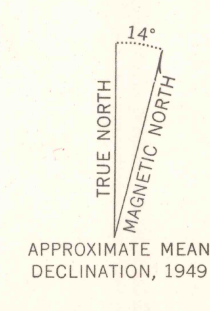

BENNETT, COLO.
N3945-W10422.5/7.5
1949

FILE COPY
MAY 8 1963
MAP INFORMATION OFFICE

THIS MAP COMPLIES WITH NATIONAL MAP ACCURACY STANDARDS
FOR SALE BY U. S. GEOLOGICAL SURVEY, DENVER 25, COLORADO OR WASHINGTON 25, D. C.
A FOLDER DESCRIBING TOPOGRAPHIC MAPS AND SYMBOLS IS AVAILABLE ON REQUEST