

UNITED STATES
DEPARTMENT OF THE INTERIOR
GEOLOGICAL SURVEY

BOX ELDER SCHOOL QUADRANGLE
COLORADO-ADAMS CO.
7.5 MINUTE SERIES (TOPOGRAPHIC)

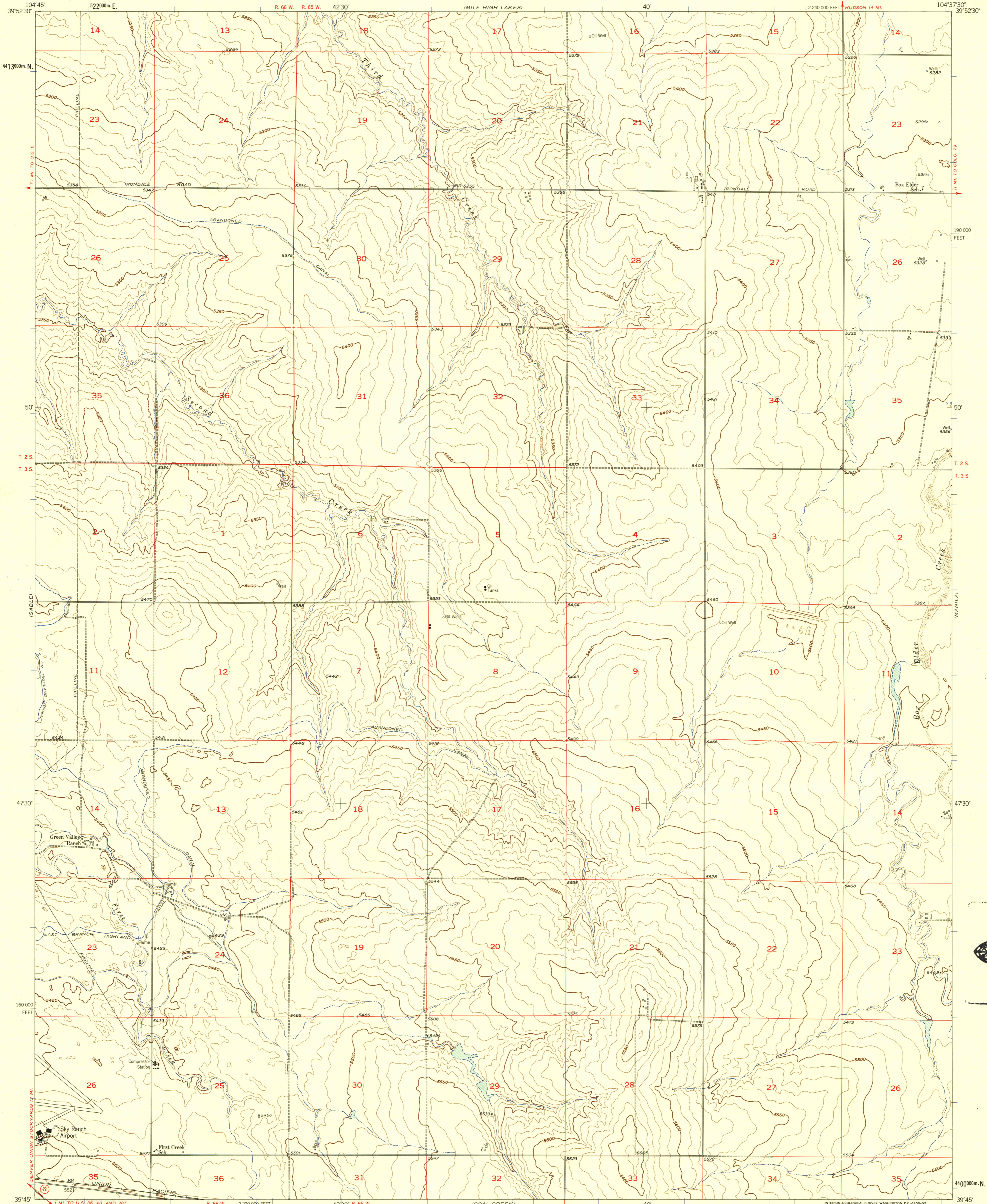

MAY 26 1987
MAP ROOM
ARTHUR LAKES LIBRARY

Mapped, edited, and published by the Geological Survey
Control by USGS and USC&GS
Culture and drainage in part compiled from aerial photographs
taken 1954. Topography by planetable surveys 1940,
revised 1957
Polyconic projection. 1927 North American datum
10,000-foot grid based on Colorado coordinate system,
north zone
1000-meter Universal Transverse Mercator grid ticks,
zone 13, shown in blue

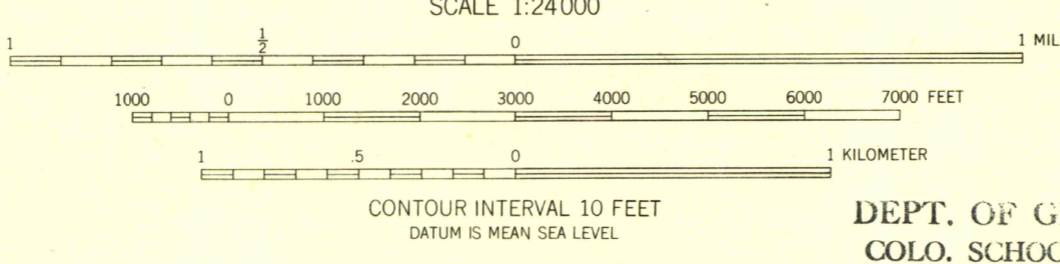
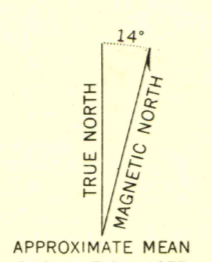

DEPT. OF GEOLOGY
COLO. SCHOOL MINES
Working Collection

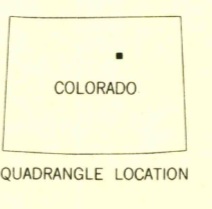

ROAD CLASSIFICATION
Medium-duty — Light-duty
Unimproved dirt
State Route

THIS MAP COMPLIES WITH NATIONAL MAP ACCURACY STANDARDS
FOR SALE BY U.S. GEOLOGICAL SURVEY, DENVER 2, COLORADO OR WASHINGTON 25, D.C.
A FOLDER DESCRIBING TOPOGRAPHIC MAPS AND SYMBOLS IS AVAILABLE ON REQUEST



BOX ELDER SCHOOL, COLO.
N3945-W10437.5/7.5
1957

OFFICE COPY
G 3701
G 3702
G 3703
G 3704
G 3705
G 3706
G 3707
G 3708
G 3709
G 3710
G 3711
G 3712
G 3713
G 3714
G 3715
G 3716
G 3717
G 3718
G 3719
G 3720
G 3721
G 3722
G 3723
G 3724
G 3725
G 3726
G 3727
G 3728
G 3729
G 3730
G 3731
G 3732
G 3733
G 3734
G 3735
G 3736
G 3737
G 3738
G 3739
G 3740
G 3741
G 3742
G 3743
G 3744
G 3745
G 3746
G 3747
G 3748
G 3749
G 3750
G 3751
G 3752
G 3753
G 3754
G 3755
G 3756
G 3757
G 3758
G 3759
G 3760
G 3761
G 3762
G 3763
G 3764
G 3765
G 3766
G 3767
G 3768
G 3769
G 3770
G 3771
G 3772
G 3773
G 3774
G 3775
G 3776
G 3777
G 3778
G 3779
G 3780
G 3781
G 3782
G 3783
G 3784
G 3785
G 3786
G 3787
G 3788
G 3789
G 3790
G 3791
G 3792
G 3793
G 3794
G 3795
G 3796
G 3797
G 3798
G 3799
G 3800
G 3801
G 3802
G 3803
G 3804
G 3805
G 3806
G 3807
G 3808
G 3809
G 3810
G 3811
G 3812
G 3813
G 3814
G 3815
G 3816
G 3817
G 3818
G 3819
G 3820
G 3821
G 3822
G 3823
G 3824
G 3825
G 3826
G 3827
G 3828
G 3829
G 3830
G 3831
G 3832
G 3833
G 3834
G 3835
G 3836
G 3837
G 3838
G 3839
G 3840
G 3841
G 3842
G 3843
G 3844
G 3845
G 3846
G 3847
G 3848
G 3849
G 3850
G 3851
G 3852
G 3853
G 3854
G 3855
G 3856
G 3857
G 3858
G 3859
G 3860
G 3861
G 3862
G 3863
G 3864
G 3865
G 3866
G 3867
G 3868
G 3869
G 3870
G 3871
G 3872
G 3873
G 3874
G 3875
G 3876
G 3877
G 3878
G 3879
G 3880
G 3881
G 3882
G 3883
G 3884
G 3885
G 3886
G 3887
G 3888
G 3889
G 3890
G 3891
G 3892
G 3893
G 3894
G 3895
G 3896
G 3897
G 3898
G 3899
G 3900
G 3901
G 3902
G 3903
G 3904
G 3905
G 3906
G 3907
G 3908
G 3909
G 3910
G 3911
G 3912
G 3913
G 3914
G 3915
G 3916
G 3917
G 3918
G 3919
G 3920
G 3921
G 3922
G 3923
G 3924
G 3925
G 3926
G 3927
G 3928
G 3929
G 3930
G 3931
G 3932
G 3933
G 3934
G 3935
G 3936
G 3937
G 3938
G 3939
G 3940
G 3941
G 3942
G 3943
G 3944
G 3945
G 3946
G 3947
G 3948
G 3949
G 3950
G 3951
G 3952
G 3953
G 3954
G 3955
G 3956
G 3957
G 3958
G 3959
G 3960
G 3961
G 3962
G 3963
G 3964
G 3965
G 3966
G 3967
G 3968
G 3969
G 3970
G 3971
G 3972
G 3973
G 3974
G 3975
G 3976
G 3977
G 3978
G 3979
G 3980
G 3981
G 3982
G 3983
G 3984
G 3985
G 3986
G 3987
G 3988
G 3989
G 3990
G 3991
G 3992
G 3993
G 3994
G 3995
G 3996
G 3997
G 3998
G 3999
G 4000