

UNITED STATES
DEPARTMENT OF THE INTERIOR
GEOLOGICAL SURVEY

BRACEWELL QUADRANGLE
COLORADO-WELD CO.
7.5 MINUTE SERIES (TOPOGRAPHIC)

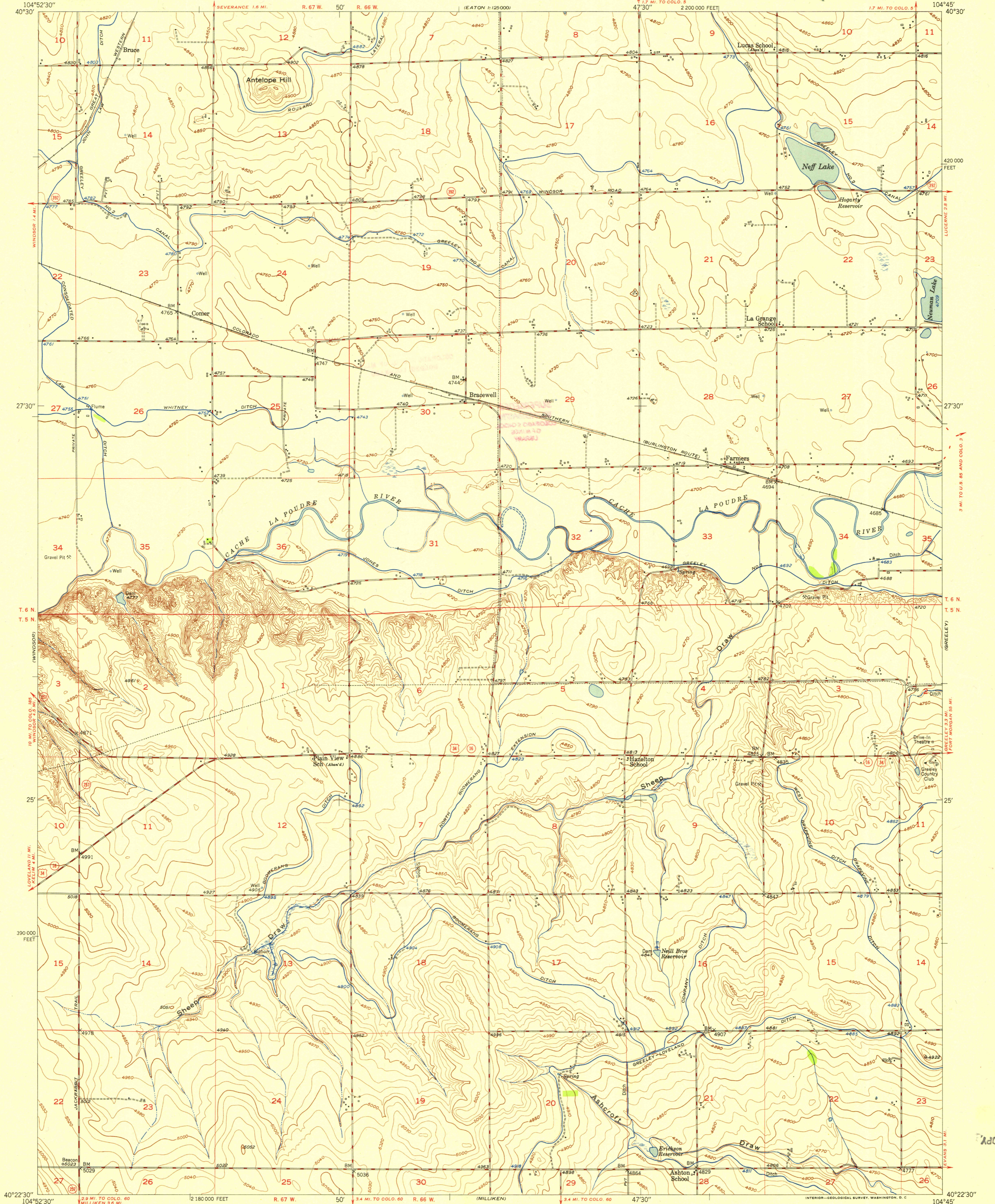

Mapped, edited, and published by the Geological Survey as part of the Department of the Interior program for the development of the Missouri River Basin Control by USGS and USC&GS
Culture and drainage in part compiled from aerial photographs by multiplex methods. Aerial photographs taken August 1949
Topography by plane-table methods, 1949-1950
Polyconic projection. 1927 North American datum
10,000-foot grid based on Colorado coordinate system, north zone

APPROXIMATE MEAN DECLINATION, 1950
TRUE NORTH
MAGNETIC NORTH
MAGNETIC DECLINATION
14°
WEST
EAST

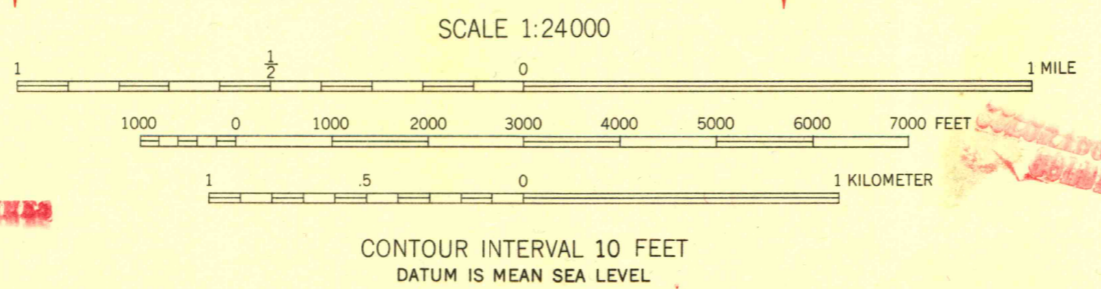

SCALE 1:24,000
CONTOUR INTERVAL 10 FEET
DATUM IS MEAN SEA LEVEL

ROAD CLASSIFICATION

HARD-SURFACE ALL WEATHER ROADS	DRY WEATHER ROADS
Heavy-duty ——— 2 LANE LANE	Improved dirt ———
Medium-duty ——— 4 LANE LANE	Unimproved dirt ———
Loose-surface, graded, or narrow hard-surface ———	
U. S. Route	State Route

BRACEWELL, COLO.
N 4022.5-W 10445/7.5

FOR SALE BY U. S. GEOLOGICAL SURVEY, FEDERAL CENTER, DENVER, COLORADO OR WASHINGTON 25, D. C.
A FOLDER DESCRIBING TOPOGRAPHIC MAPS AND SYMBOLS IS AVAILABLE ON REQUEST

EDITION OF 1951

OFFICE COPY

LIBRARY USE ONLY