

UNITED STATES
DEPARTMENT OF THE INTERIOR
GEOLOGICAL SURVEY

DEADMAN CAMP SW QUADRANGLE
COLORADO—SAGUACHE CO.
7.5 MINUTE SERIES (TOPOGRAPHIC)

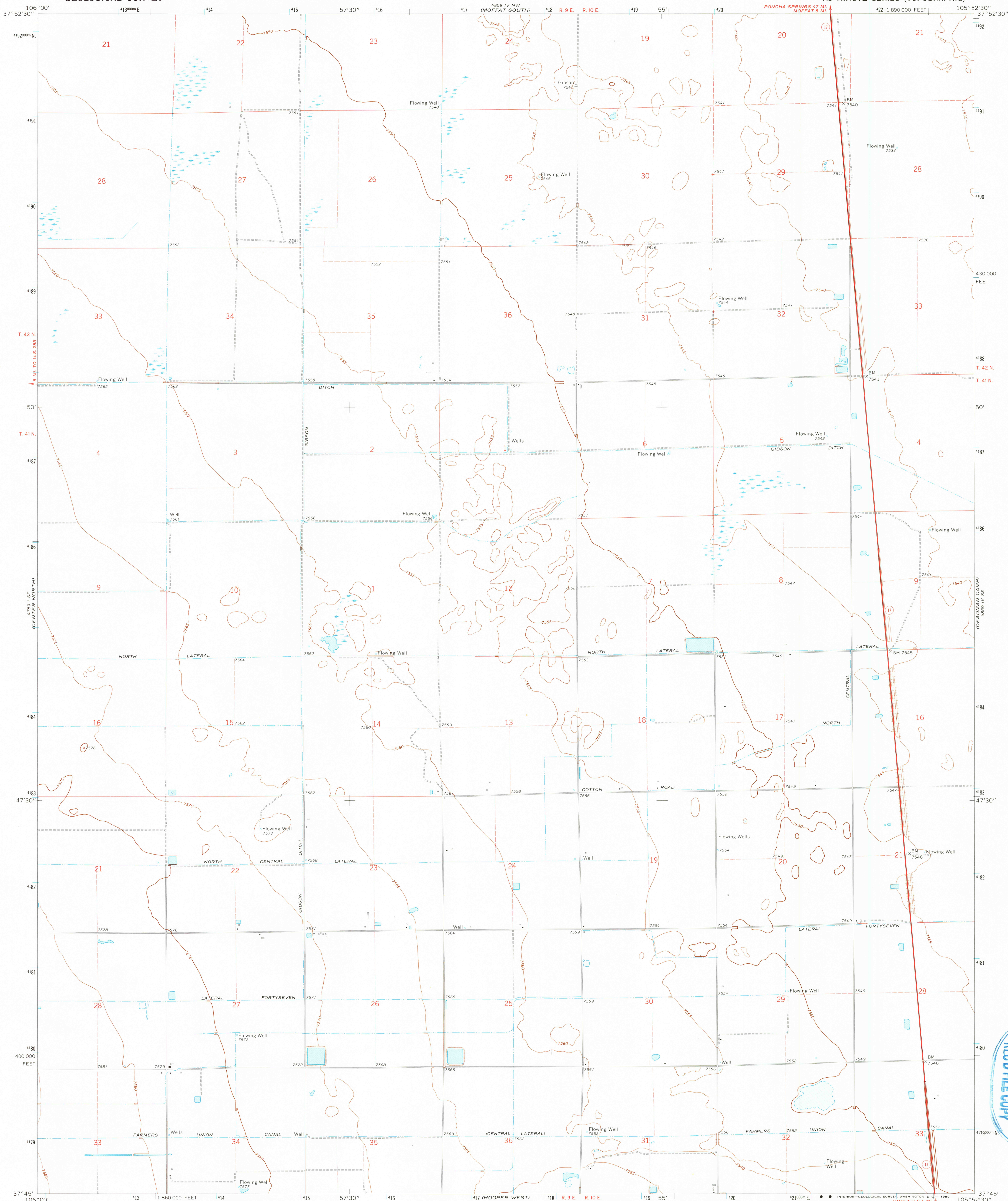

Mapped, edited, and published by the Geological Survey
Control by USGS and USC&GS
Planimetry by photogrammetric methods from aerial
photographs taken 1966. Topography by planetable surveys 1968
Polyconic projection. 1927 North American datum
10,000-foot grid based on Colorado coordinate system,
south zone
1000-meter Universal Transverse Mercator grid ticks,
zone 13, shown in blue
Fine red dashed lines indicate selected fence lines
Map photoinspected 1979
No major culture or drainage changes observed

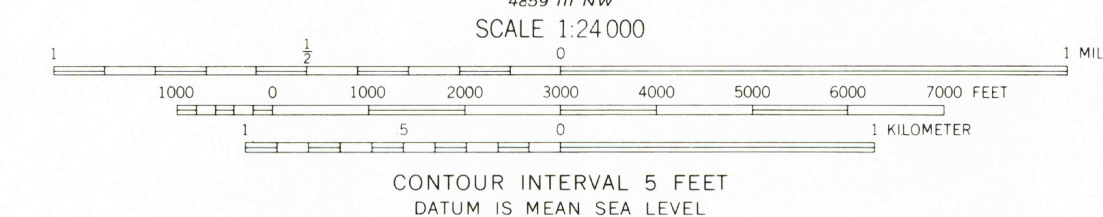
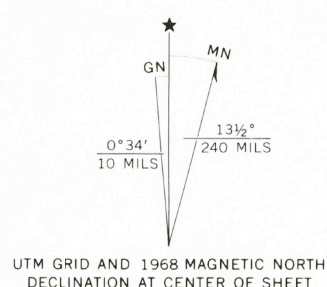

ROAD CLASSIFICATION
Primary highway, all weather, Light-duty road, all weather,
hard surface improved surface
Unimproved road, fair or dry
weather
State Route

DEADMAN CAMP SW, COLO.
N3745—W10552.5/7.5

1968
PHOTOINSPECTED 1979
AMS 4859 IV SW—SERIES V877

USGS NHD HISTORICAL MAP
MAR 15 1991
REC'D FILE COPY