

UNITED STATES  
DEPARTMENT OF THE INTERIOR  
GEOLOGICAL SURVEY

DENNY LAKE QUADRANGLE  
COLORADO—BENT CO.  
7.5 MINUTE SERIES (TOPOGRAPHIC)

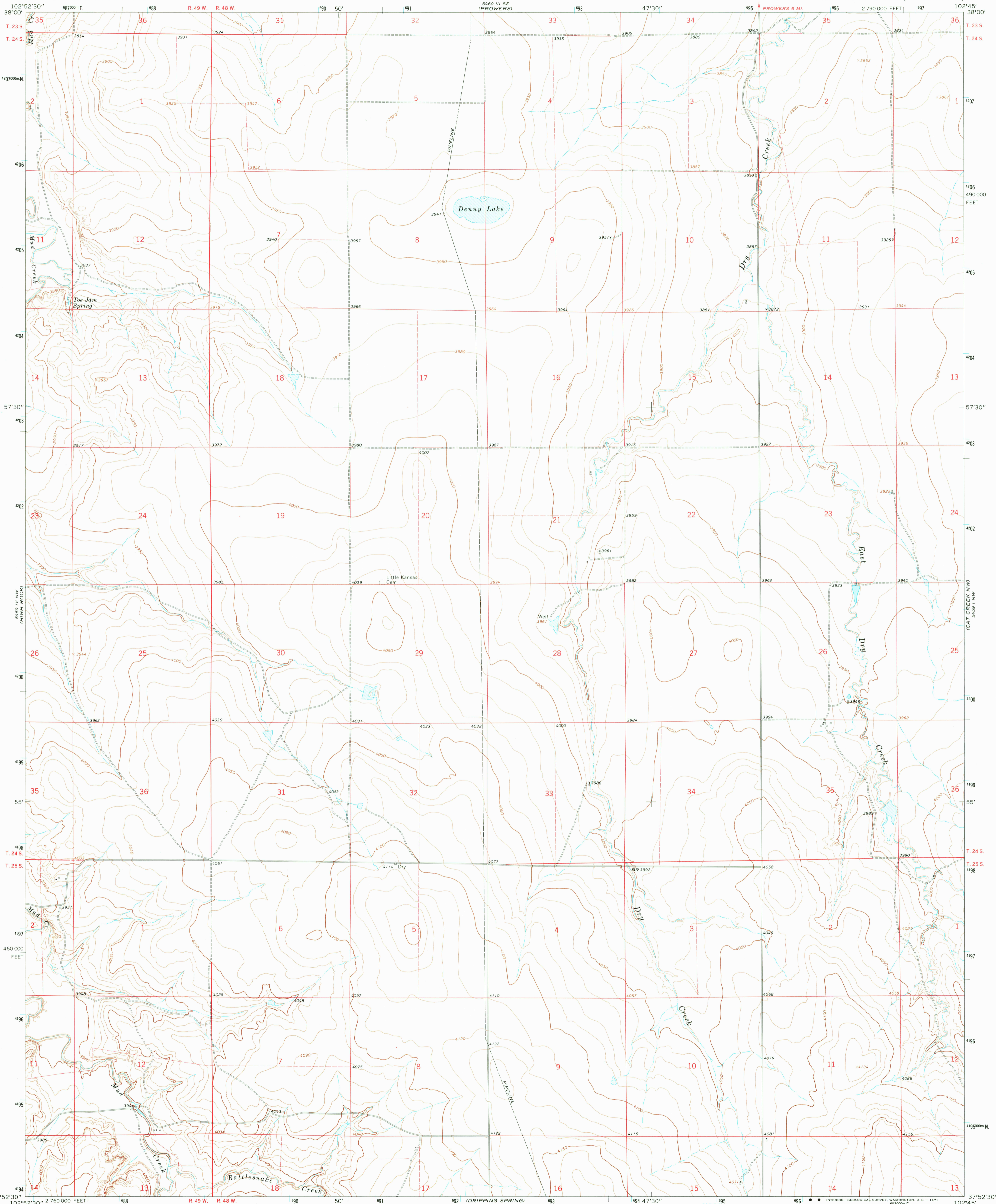

Mapped, edited, and published by the Geological Survey  
Control by USGS and USC&GS  
Topography by photogrammetric methods from aerial photographs taken 1967. Field checked 1968  
Polyconic projection. 1927 North American datum 10,000-foot grid based on Colorado coordinate system, south zone  
1000-meter Universal Transverse Mercator grid ticks, zone 13, shown in blue  
Fine red dashed lines indicate selected fence lines

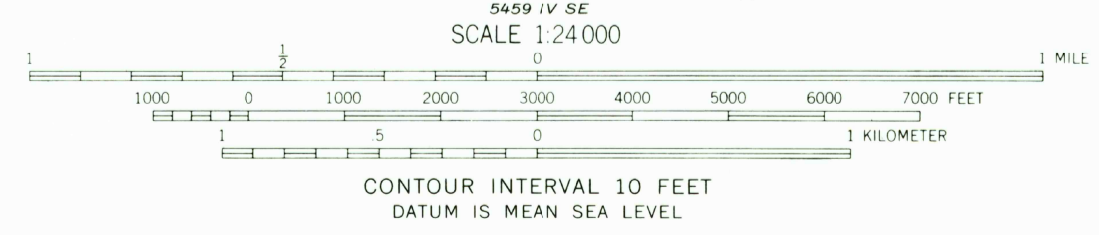
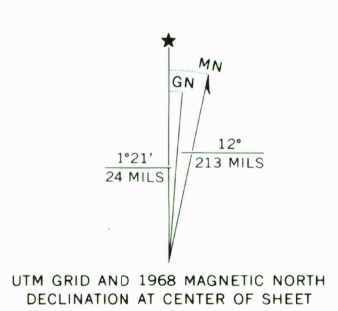

U.S. Geological Survey  
Historical File  
Topographic Division

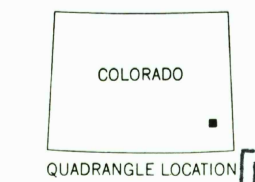

ROAD CLASSIFICATION  
Light-duty road, all weather, Unimproved road, fair or dry improved surface weather

U.S.G.S.  
FILE COPY  
TOPOGRAPHIC DIVISION

DENNY LAKE, COLO.  
N3752.5—W10245/7.5  
1968

THIS MAP COMPLIES WITH NATIONAL MAP ACCURACY STANDARDS  
FOR SALE BY U.S. GEOLOGICAL SURVEY, DENVER, COLORADO 80225, OR WASHINGTON, D.C. 20242  
A FOLDER DESCRIBING TOPOGRAPHIC MAPS AND SYMBOLS IS AVAILABLE ON REQUEST

AMS 5459 IV NE—SERIES V877

MAY 21 1971