

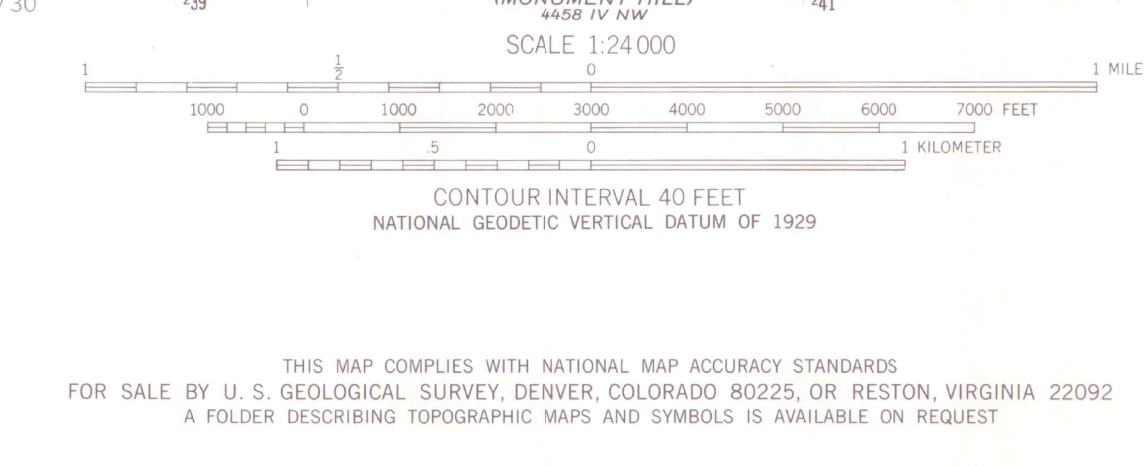

4459 III SW  
(ENGINEER MTN)

4458 IV NW  
(MONUMENT HILL)

Mapped, edited, and published by the Geological Survey  
Control by USGS and USC&GS  
Topography by photogrammetric methods from aerial  
photographs taken 1956. Field checked 1960  
Polyconic projection. 1927 North American datum  
10,000-foot grid based on Colorado coordinate system,  
south zone  
1000-meter Universal Transverse Mercator grid ticks,  
zone 13, shown in blue  
Land lines are omitted because of insufficient data  
To place on the predicted North American Datum 1983  
move the projection lines 3 meters north and  
56 meters east as shown by dashed corner ticks

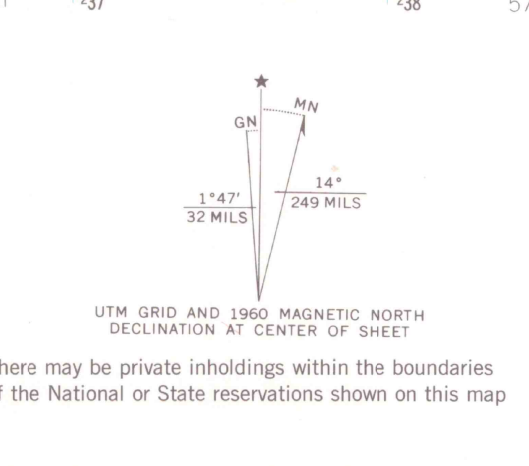

4459 III SW  
(ENGINEER MTN)

4458 IV NW  
(MONUMENT HILL)

HERMOSA 8.3 MI.

INTERIOR GEOLOGICAL SURVEY, RESTON, VIRGINIA - 1982

ROAD CLASSIFICATION  
Unimproved dirt=====

COLORADO  
QUADRANGLE LOCATION

ELK CREEK, COLO.  
N3730-W10752.5/7.5  
1960  
PHOTOINSPECTED 1975  
DMA 4459 III SW-SERIES V877

Map photoinspected 1975  
No major culture or drainage changes observed

OFFICE COPY  
LIBRARY USE ONLY

G 3700  
24  
.G4  
MAP ROOM