

UNITED STATES  
DEPARTMENT OF THE INTERIOR  
GEOLOGICAL SURVEY

FREMONT BUTTE QUADRANGLE  
COLORADO—WASHINGTON CO.  
7.5 MINUTE SERIES (TOPOGRAPHIC)

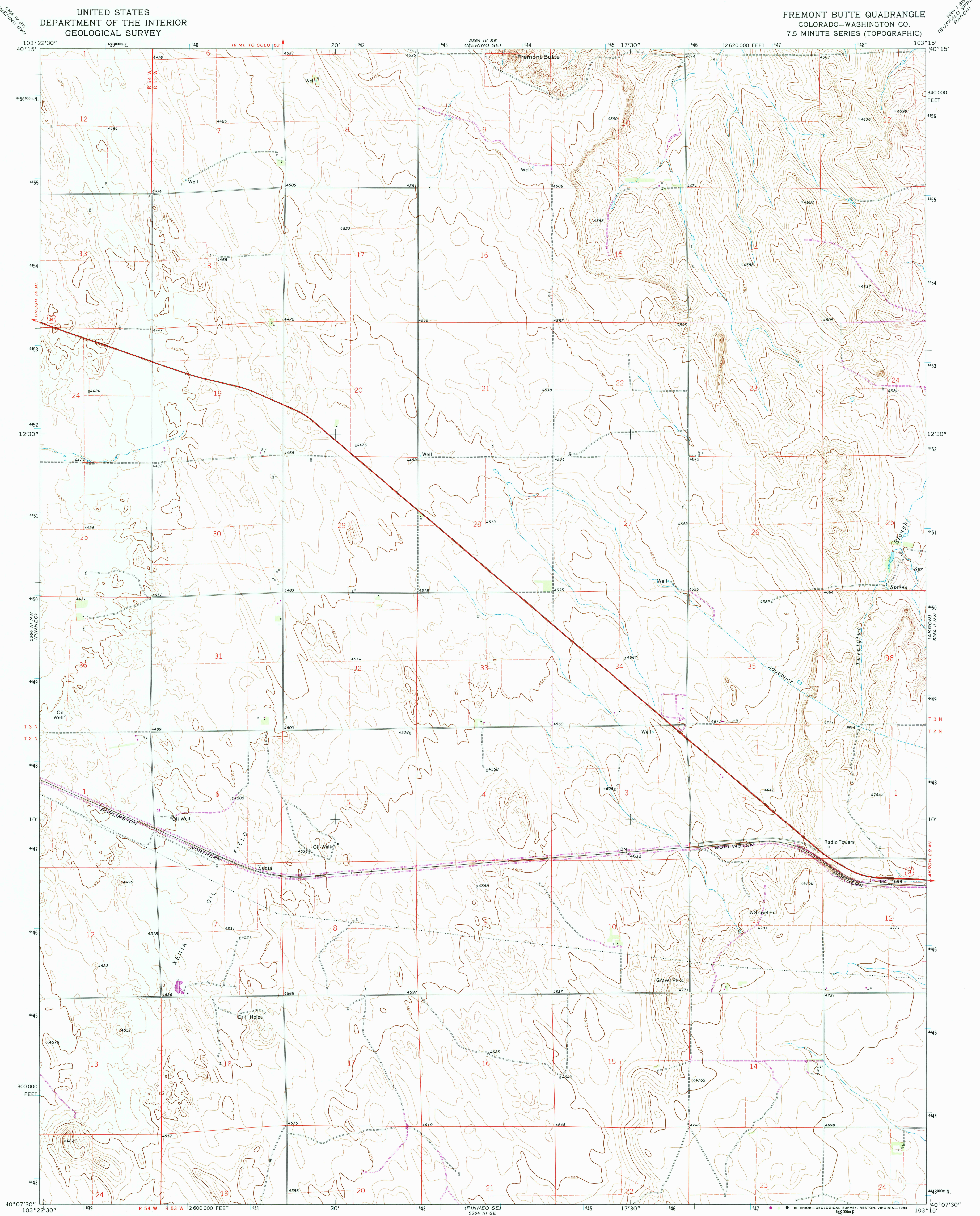

Mapped, edited, and published by the Geological Survey  
Control by USGS and NOS/NOAA  
Topography by photogrammetric methods from aerial photographs taken 1972. Field checked 1973  
Projection and 10,000-foot grid ticks: Colorado coordinate system, north zone (Lambert conformal conic)  
1000-meter Universal Transverse Mercator grid ticks, zone 13, shown in blue  
1927 North American Datum  
To place on the predicted North American Datum 1983 move the projection lines 5 meters north and 43 meters east as shown by dashed corner ticks  
Fine red dashed lines indicate selected fence lines  
Land lines in part are based on cultural development and are not reflected in the original land survey

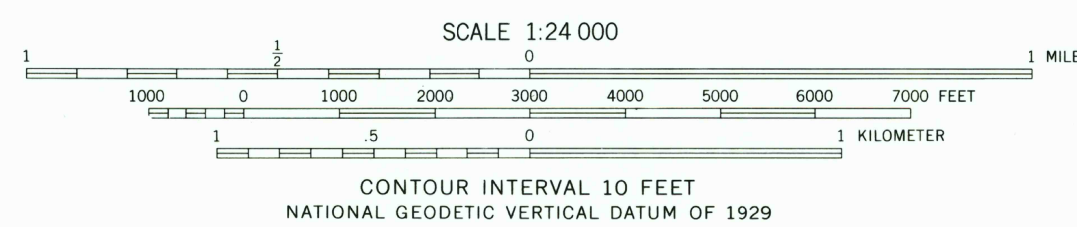
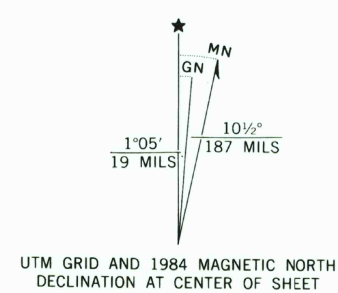

**ROAD CLASSIFICATION**  
Primary highway, hard surface ————  
Secondary highway, hard surface ————  
Unimproved road ————  
Light-duty road, hard or improved surface ————  
Interstate Route ————  
U. S. Route ————  
State Route ————

THIS MAP COMPLIES WITH NATIONAL MAP ACCURACY STANDARDS  
FOR SALE BY U.S. GEOLOGICAL SURVEY, DENVER, COLORADO 80225, OR RESTON, VIRGINIA 22092  
A FOLDER DESCRIBING TOPOGRAPHIC MAPS AND SYMBOLS IS AVAILABLE ON REQUEST

Revisions shown in purple and woodland compiled from aerial photographs taken 1982 and other sources  
This information not field checked. Map edited 1984

FREMONT BUTTE, COLO.  
40103-B3-TF-024

1973  
PHOTOREVISED 1984  
DMA 5364 III NE—SERIES V877