

1816 582111/05
1:25000

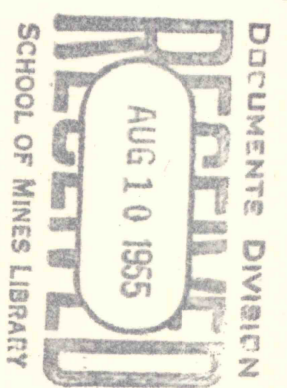

Mapped, edited, and published by the Geological Survey
Control by USGS and USC&GS
Topography from aerial photographs by multiplex methods
Aerial photographs taken 1952. Field check 1954
Polyconic projection. 1927 North American datum
10,000-foot grid based on Colorado coordinate system,
central zone

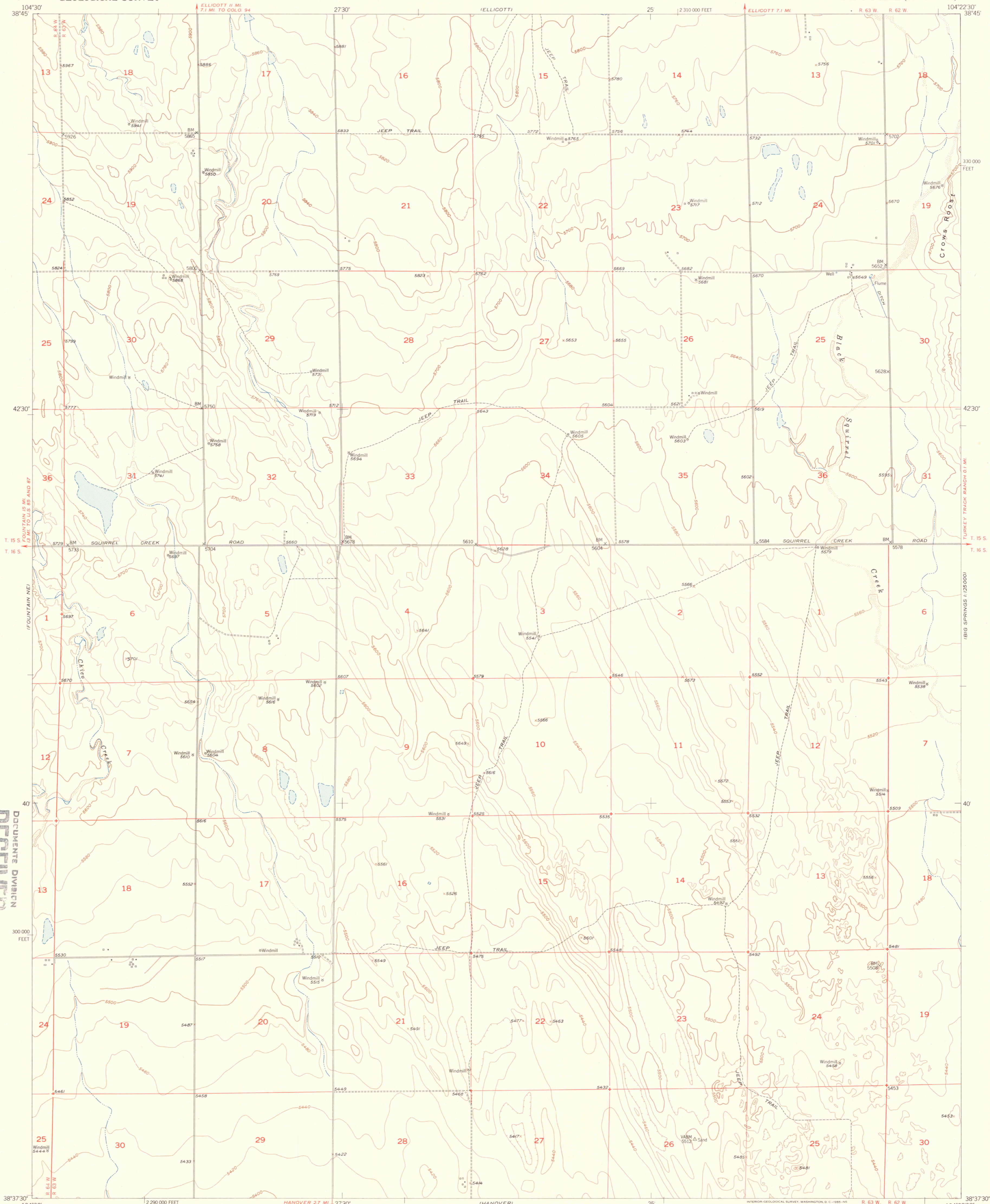
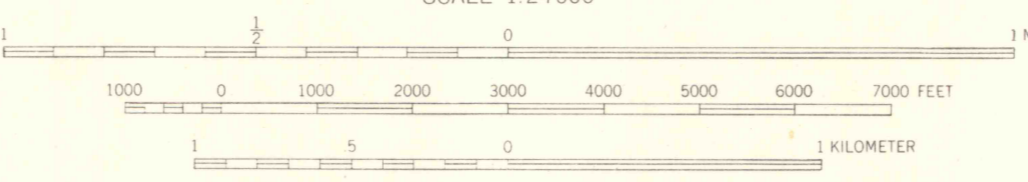
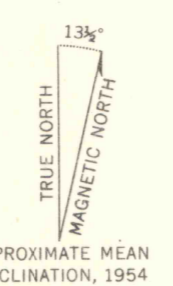

CONTOUR INTERVAL 20 FEET
DATUM IS MEAN SEA LEVEL

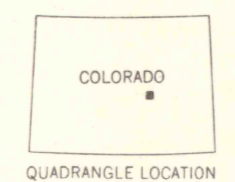

ROAD CLASSIFICATION

Heavy-duty	Light-duty
Medium-duty	Unimproved dirt
U.S. Route	State Route

SUPERSEDED
HANOVER NW, COLO.
N3837.5-W10422.5/7.5
1954
LIBRARY USE ONLY