

UNITED STATES  
DEPARTMENT OF THE INTERIOR  
GEOLOGICAL SURVEY

HAXTUN WEST QUADRANGLE  
COLORADO  
7.5 MINUTE SERIES (TOPOGRAPHIC)

DEPT. OF GEOLOGY  
COLO. SCHOOL MINES  
Reference Collection

DEPT. OF GEOLOGY  
COLO. SCHOOL MINES  
Reference Collection

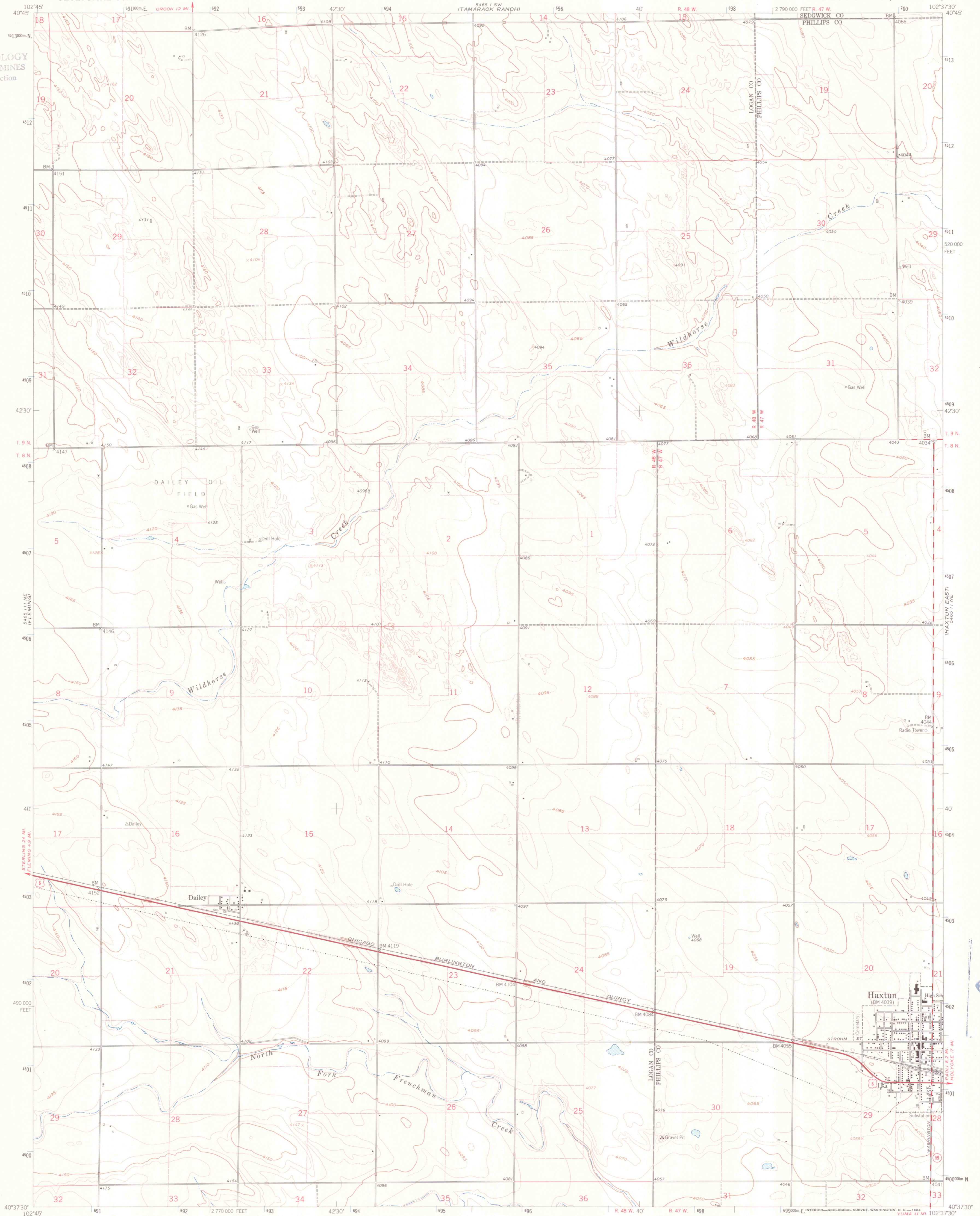

Mapped, edited, and published by the Geological Survey as part of the Department of the Interior program for the development of the Missouri River Basin Control by USGS and USC&GS

Topography by photogrammetric methods from aerial photographs taken 1959. Field checked 1962

Polyconic projection. 1927 North American datum  
10,000-foot grid based on Colorado coordinate system, north zone  
1000-meter Universal Transverse Mercator grid ticks, zone 13, shown in blue

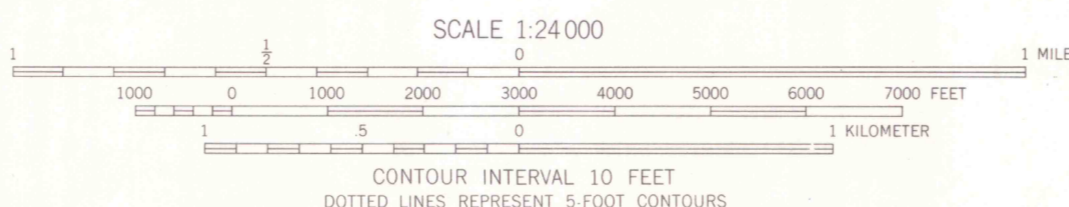
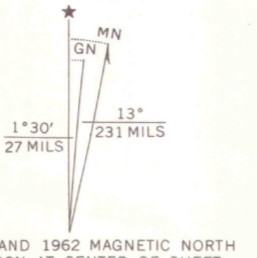

CONTOUR INTERVAL 10 FEET  
DOTTED LINES REPRESENT 5-FOOT CONTOURS  
DATUM IS MEAN SEA LEVEL

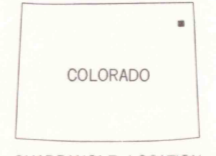

ROAD CLASSIFICATION

Heavy-duty	Light-duty
Medium-duty	Unimproved dirt
U.S. Route	State Route

OFFICE COPY  
U.S. Route  
State Route

THIS MAP COMPLIES WITH NATIONAL MAP ACCURACY STANDARDS  
FOR SALE BY U.S. GEOLOGICAL SURVEY, DENVER 25, COLORADO OR WASHINGTON 25, D.C.  
A FOLDER DESCRIBING TOPOGRAPHIC MAPS AND SYMBOLS IS AVAILABLE ON REQUEST

HAXTUN WEST, COLO.  
N40375-W102375/7.5

COLORADO SCHOOL OF MINES  
ARTHUR LAKES LIBRARY



MAY 27 1967  
MAP ROOM  
ARTHUR LAKES LIBRARY

LIBRARY USE ONLY

G 3701  
C222  
S24  
U5  
C.2