

Weld & Adams Co.

UNITED STATES DEPARTMENT OF THE INTERIOR GEOLOGICAL SURVEY

HUDSON QUADRANGLE COLORADO 7.5 MINUTE SERIES (TOPOGRAPHIC)

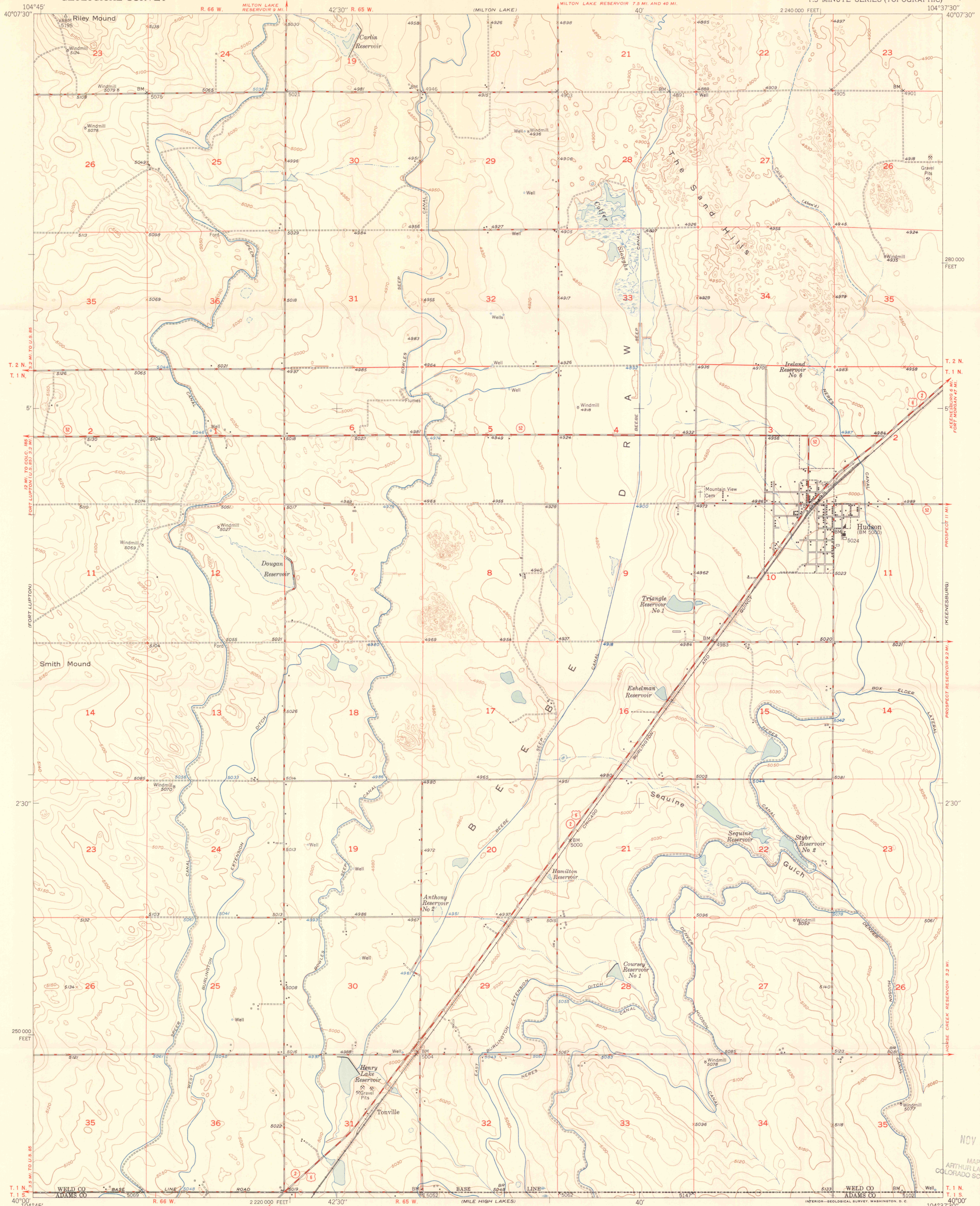

Mapped, edited, and published by the Geological Survey as part of the Department of the Interior program for the development of the Missouri River Basin Control by USGS and USC&GS. Culture and drainage in part compiled from aerial photographs taken September and October 1948. Topography by plane-table methods, 1949. Polyconic projection, 1927 North American datum 10,000-foot grid based on Colorado coordinate system, north zone.

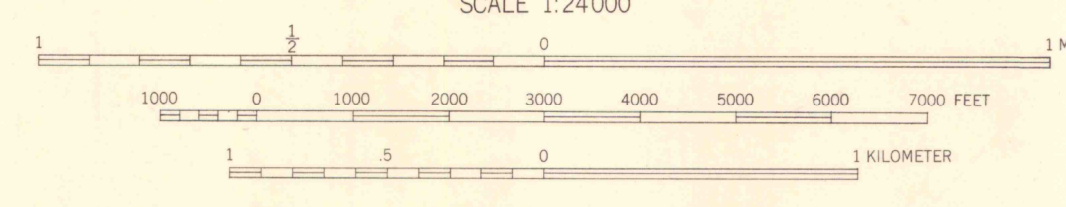
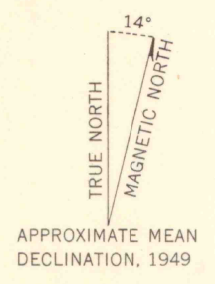

ROAD CLASSIFICATION table with symbols for different road types: Heavy-duty, Medium-duty, Loose-surface, graded, or narrow hard-surface, U.S. Route, Dry weather roads, Improved dirt, Unimproved dirt, State Route.

THIS MAP COMPLIES WITH NATIONAL MAP ACCURACY STANDARDS FOR SALE BY U. S. GEOLOGICAL SURVEY, FEDERAL CENTER, DENVER, COLORADO OR WASHINGTON 25, D. C. A FOLDER DESCRIBING TOPOGRAPHIC MAPS AND SYMBOLS IS AVAILABLE ON REQUEST

HUDSON, COLO. N4000-W10437.5/7.5 EDITION OF 1951

LIBRARY USE ONLY OFFICE COPY

G 3701 C222 S24 U5

NOV 01 1996 MAP ROOM ARTHUR LAKES LIBRARY COLORADO SCHOOL OF MINES