

UNITED STATES  
DEPARTMENT OF THE INTERIOR  
GEOLOGICAL SURVEY

KANORADO QUADRANGLE  
COLORADO-KANSAS  
7.5 MINUTE SERIES (TOPOGRAPHIC)

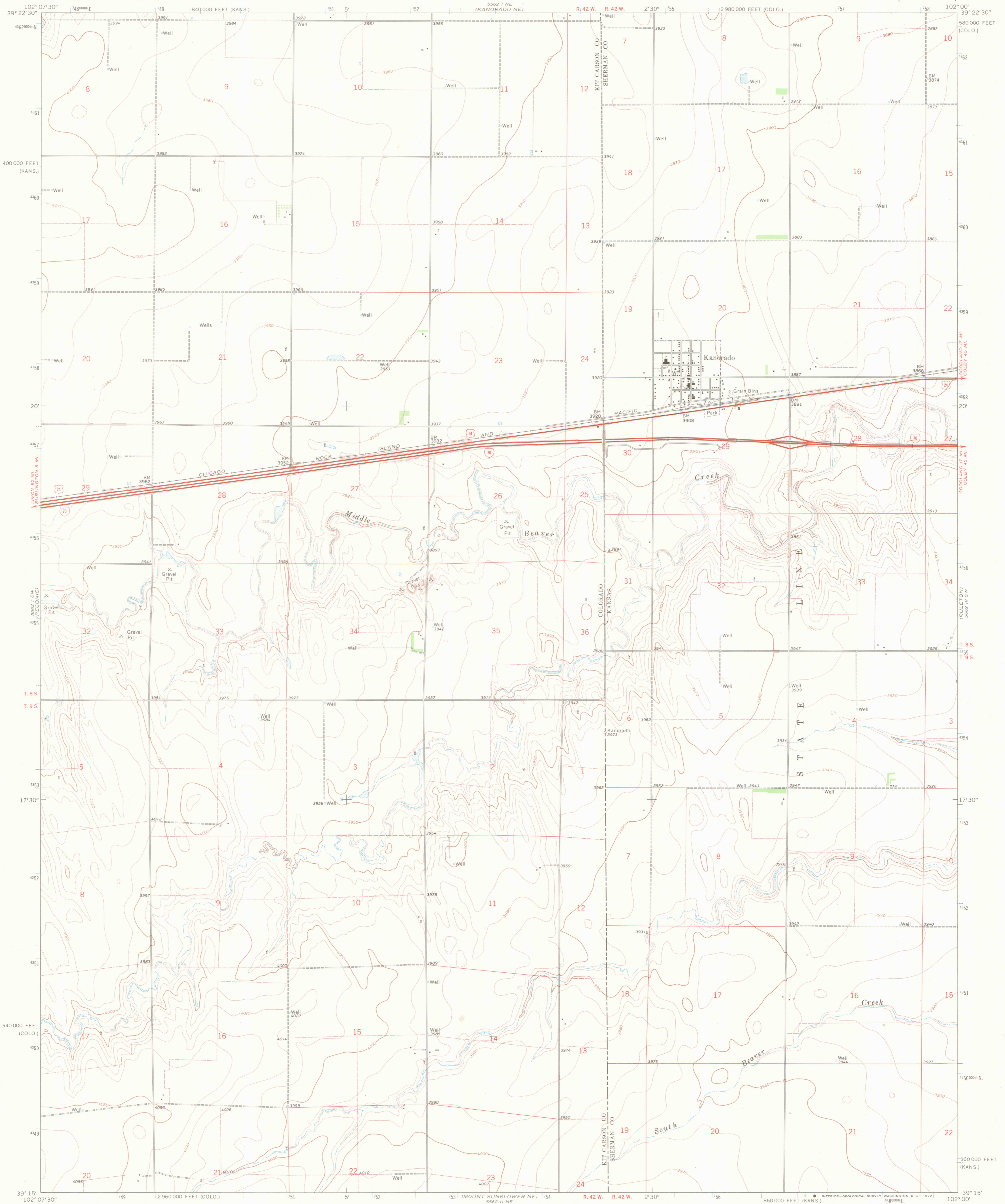

Mapped, edited, and published by the Geological Survey

Control by USGS and USC&GS  
Topography by photogrammetric methods from aerial photographs taken 1968. Field checked 1969

Polyconic projection. 1927 North American datum 10,000-foot grids based on Colorado coordinate system, central zone and Kansas coordinate system, north zone 1000-meter Universal Transverse Mercator grid ticks, zone 13, shown in blue

Fine red dashed lines indicate selected fence lines  
Land lines are based on cultural development and are not reflected in the original land survey

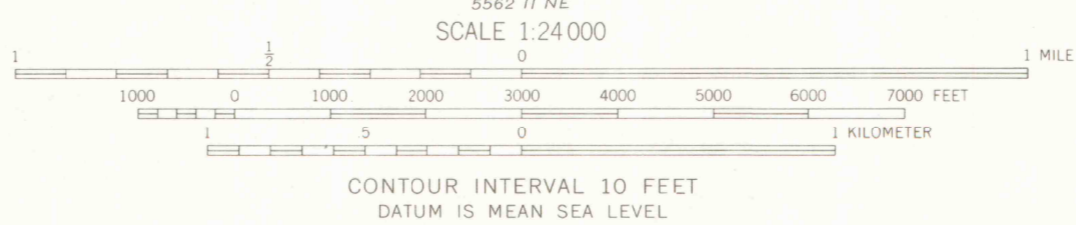
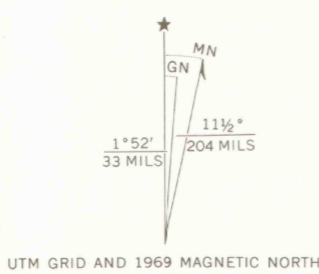

CONTOUR INTERVAL 10 FEET  
DATUM IS MEAN SEA LEVEL



JAN 19 2006

KANORADO, COLO.-KANS.  
N3915-W10200/7.5

1969

AMS 5562 I SE-SERIES V877

THIS MAP COMPLIES WITH NATIONAL MAP ACCURACY STANDARDS  
FOR SALE BY U.S. GEOLOGICAL SURVEY, DENVER, COLORADO 80225, OR WASHINGTON, D. C. 20242  
AND BY THE STATE GEOLOGICAL SURVEY, LAWRENCE, KANSAS 66044  
A FOLDER DESCRIBING TOPOGRAPHIC MAPS AND SYMBOLS IS AVAILABLE ON REQUEST

OFFICE COPY  
LIBRARY USE ONLY

MAP ROOM  
ARTHUR LAKES LIBRARY  
COLORADO SCHOOL OF MINES

G 3700  
s24  
.G4  
MAP ROOM

(MORE SHEETS DRAWN)  
5562 I SE-100-500