

USGS HISTORICAL MAP  
FEB - 1988  
REC'D FILE COPY

Mapped, edited, and published by the Geological Survey  
Control by USGS, NOS/NOAA, and U.S. Forest Service  
Topography by photogrammetric methods from aerial photographs  
taken 1975. Field checked 1976. Map edited 1980  
Projection and 10,000-foot grid ticks: Colorado  
coordinate system, central zone (Lambert conformal conic)  
1000-meter Universal Transverse Mercator grid, zone 13  
1927 North American Datum  
To place on the predicted North American Datum 1983  
move the projection lines 6 meters north and  
51 meters east as shown by dashed corner ticks  
Where omitted, land lines have not been established or  
are not shown because of insufficient data  
There may be private inholdings within the boundaries  
of the National or State reservations shown on this map

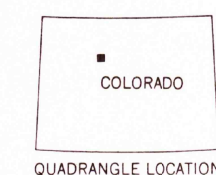
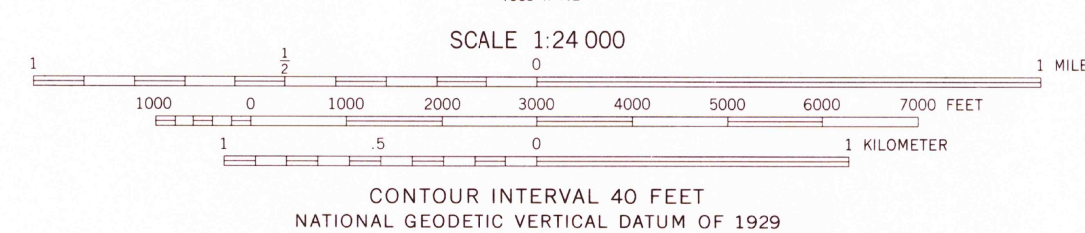
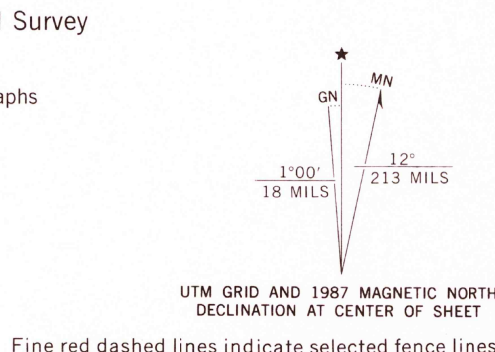

ROAD CLASSIFICATION  
Primary highway, hard surface  
Secondary highway, hard surface  
Interstate Route  
Light-duty road, hard or improved surface  
Unimproved road  
U.S. Route  
State Route

LAVA CREEK, COLO.  
39106-G5-TF-024  
1980  
PHOTOREVISED 1987  
DMA 4663 I SE—SERIES V877

THIS MAP COMPLIES WITH NATIONAL MAP ACCURACY STANDARDS  
FOR SALE BY U.S. GEOLOGICAL SURVEY, DENVER, COLORADO 80225, OR RESTON, VIRGINIA 22092  
A FOLDER DESCRIBING TOPOGRAPHIC MAPS AND SYMBOLS IS AVAILABLE ON REQUEST