

UNITED STATES
DEPARTMENT OF THE INTERIOR
GEOLOGICAL SURVEY

MARKS BUTTE QUADRANGLE
COLORADO—SEGWICK CO.
7.5 MINUTE SERIES (TOPOGRAPHIC)

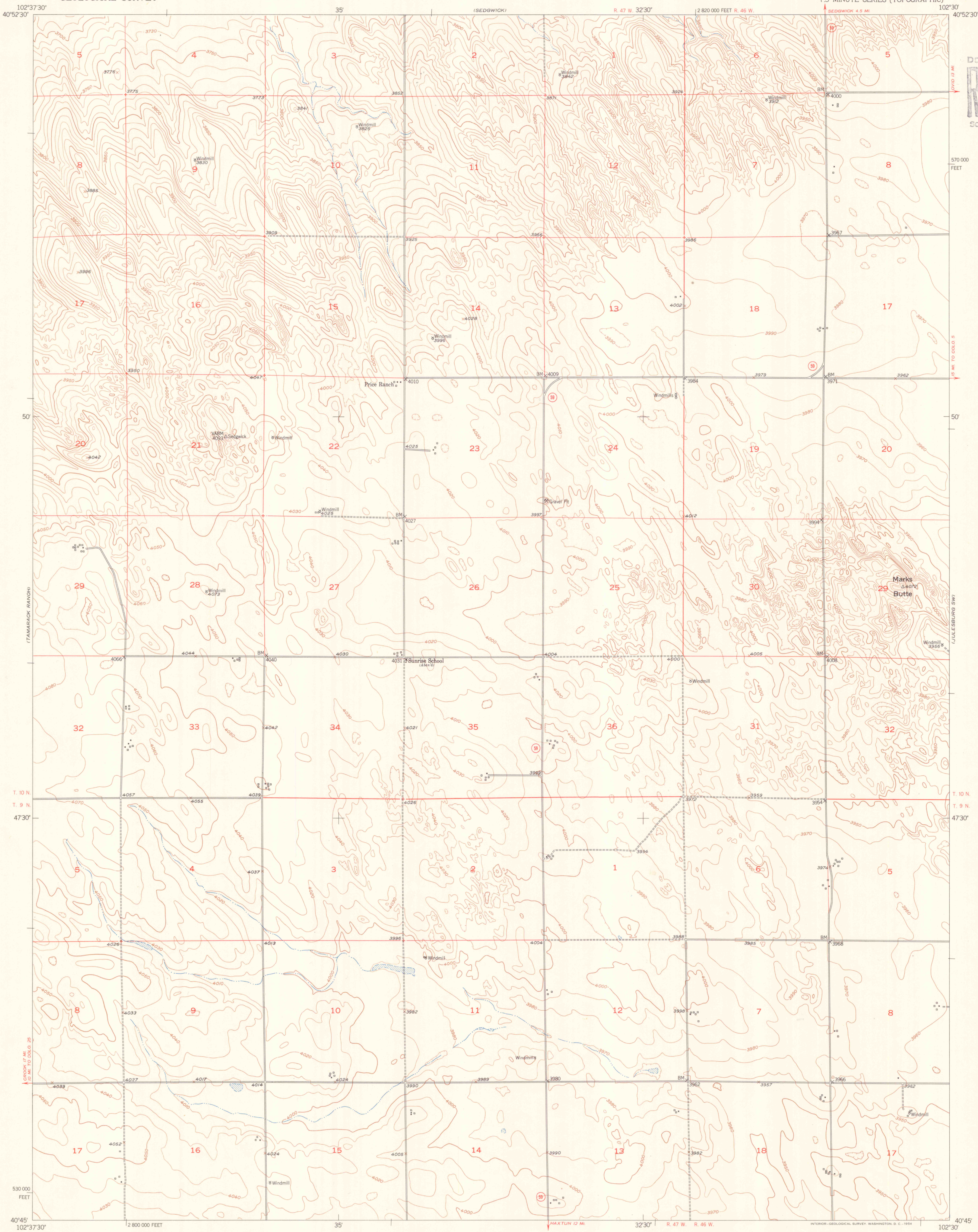

DOCUMENTS DIVISION
RECEIVED
JUN 9 - 1954
SCHOOL OF MINES LIBRARY

Mapped, edited, and published by the Geological Survey as part of the Department of the Interior program for the development of the Missouri River Basin. Control by USGS and USC&GS. Culture and drainage in part compiled from aerial photographs taken 1948. Topography by plane-table surveys 1952. Polyconic projection. 1927 North American datum. 10,000-foot grid based on Colorado coordinate system, north zone.

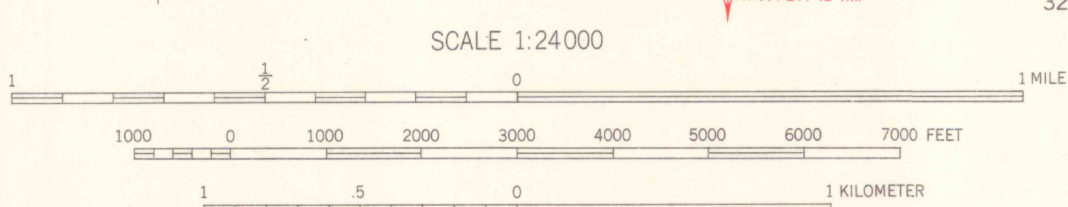

ROAD CLASSIFICATION
Heavy-duty ——— 4 LANE 6 LANE Light-duty ———
Medium-duty ——— 4 LANE 6 LANE Unimproved dirt ———
U. S. Route State Route

TRUE NORTH
MAGNETIC NORTH
APPROXIMATE MEAN DECLINATION, 1952

COLORADO
QUADRANGLE LOCATION

MARKS BUTTE, COLO.
N4045—W10230/7.5
1952

THIS MAP COMPLIES WITH NATIONAL MAP ACCURACY STANDARDS
FOR SALE BY U.S. GEOLOGICAL SURVEY, FEDERAL CENTER, DENVER, COLORADO OR WASHINGTON 25, D. C.
A FOLDER DESCRIBING TOPOGRAPHIC MAPS AND SYMBOLS IS AVAILABLE ON REQUEST

I 19.12: 5 Marks Butte