

INFLUENCE SPHERES

UNITED STATES DEPARTMENT OF THE INTERIOR GEOLOGICAL SURVEY

Washington & Morgan Co. MERINO SW QUADRANGLE COLORADO 7.5 MINUTE SERIES (TOPOGRAPHIC) 2 590 000 FEET

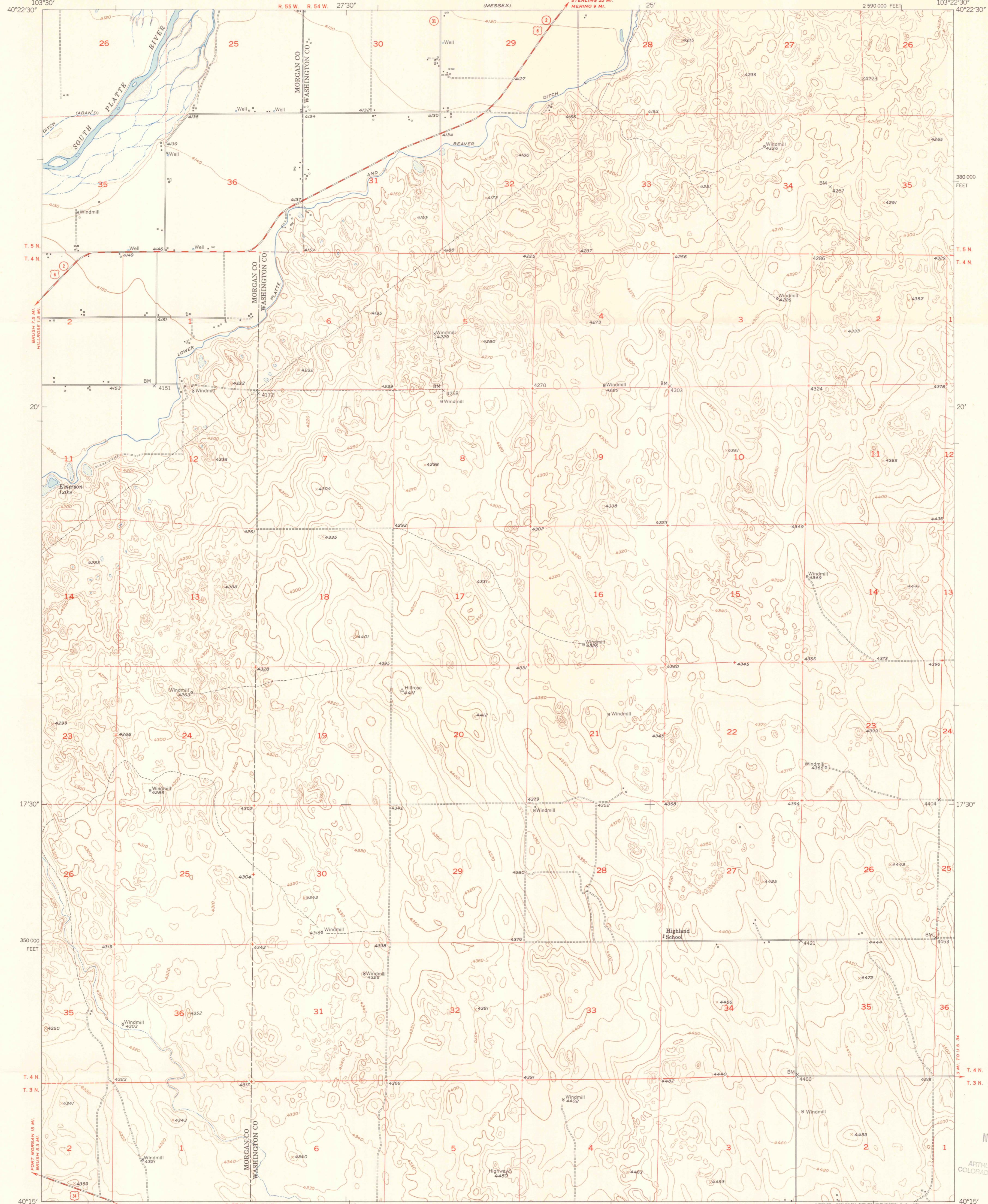

Mapped, edited, and published by the Geological Survey as part of the Department of the Interior program for the development of the Missouri River Basin Control by USGS and USC&GS Culture and drainage in part compiled from aerial photographs taken 1948-1949 Topography by plane-table surveys 1951 Polyconic projection, 1927 North American datum 10,000-foot grid based on Colorado coordinate system, north zone Dashed land lines indicate approximate location

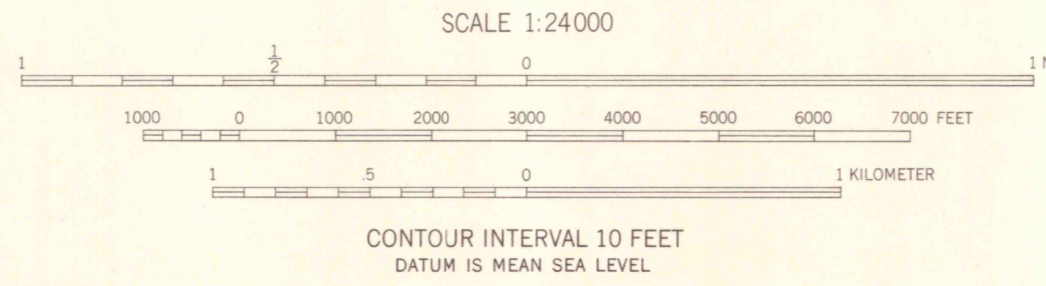

CONTOUR INTERVAL 10 FEET DATUM IS MEAN SEA LEVEL

ROAD CLASSIFICATION table with categories: Heavy-duty, Medium-duty, U.S. Route, Light-duty, Unimproved dirt, State Route.

FOR SALE BY U.S. GEOLOGICAL SURVEY, FEDERAL CENTER, DENVER, COLORADO OR WASHINGTON 25, D. C. A FOLDER DESCRIBING TOPOGRAPHIC MAPS AND SYMBOLS IS AVAILABLE ON REQUEST

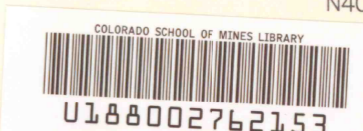

MERINO SW, COLO. N4015-W10322.5/7.5

1951

NOV 01 1996 MAP ROOM ARTHUR LAKES LIBRARY COLORADO SCHOOL OF MINES

Handwritten signature/initials

Handwritten numbers: 3701, C222, S24, U5

Handwritten initials: w/o