

UNITED STATES
DEPARTMENT OF THE INTERIOR
GEOLOGICAL SURVEY

MILE HIGH LAKES QUADRANGLE
COLORADO
7.5 MINUTE SERIES (TOPOGRAPHIC)

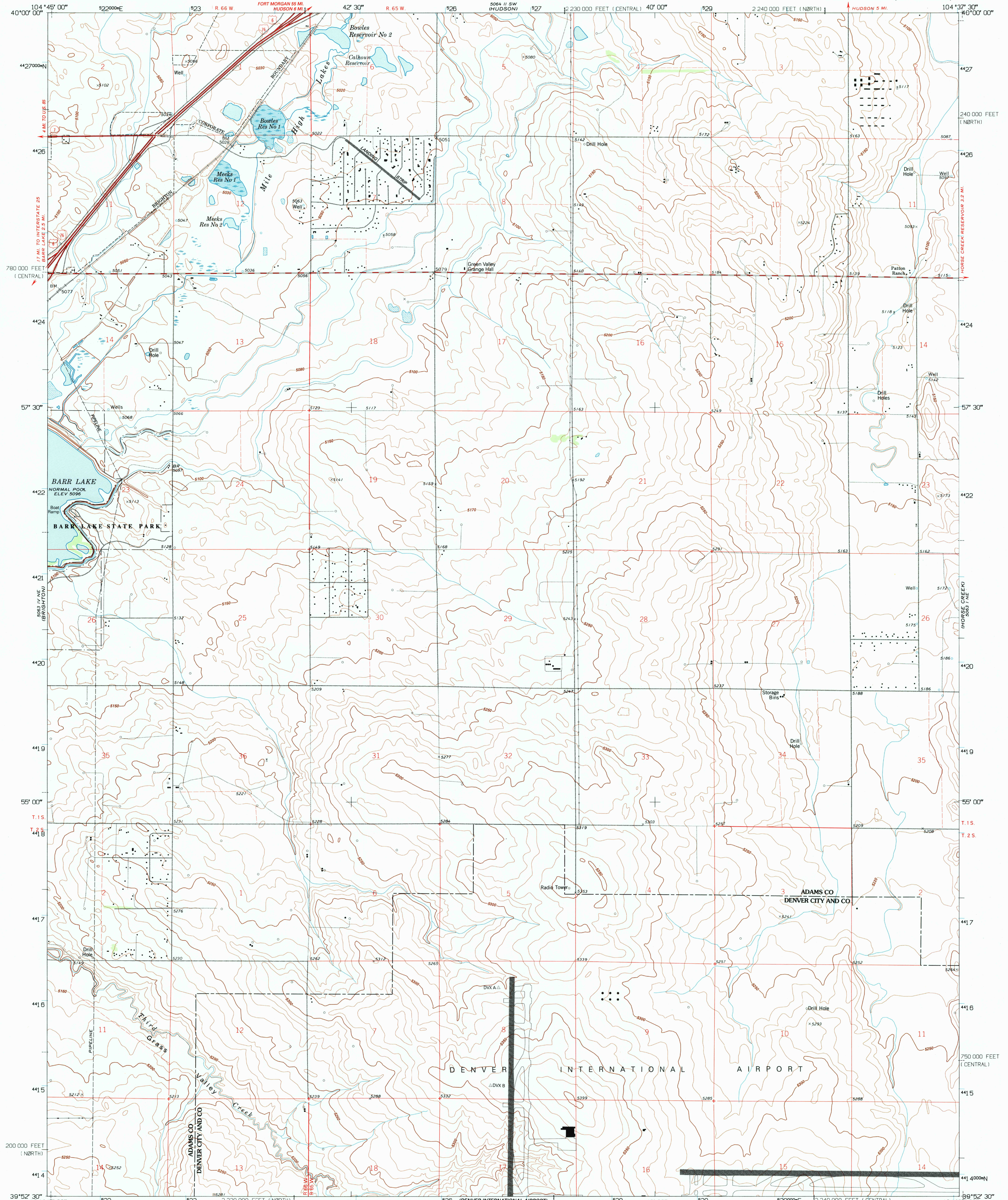

Produced by the United States Geological Survey
Control by USGS and NOS/NOAA

Compiled from aerial photographs taken 1954 and 1955. Revised from aerial photographs taken 1988 and other sources. Field checked 1986. Map edited 1994. Contours and land elevations have not been revised and may conflict with other content.

North American Datum of 1927 (NAD 27). Projection and blue 1000-meter Universal Transverse Mercator ticks, zone 13 10 000-foot ticks: Colorado Coordinate System, north and central zones.

North American Datum of 1983 (NAD 83) is shown by dashed corner ticks. The values of the shift between NAD 27 and NAD 83 for 7.5-minute intersections are obtainable from National Geodetic Survey NADCON software.

There may be private inholdings within the boundaries of the National or State reservations shown on this map.

Fine red dashed lines indicate selected fence and field lines where generally visible on aerial photographs. This information is unchecked.

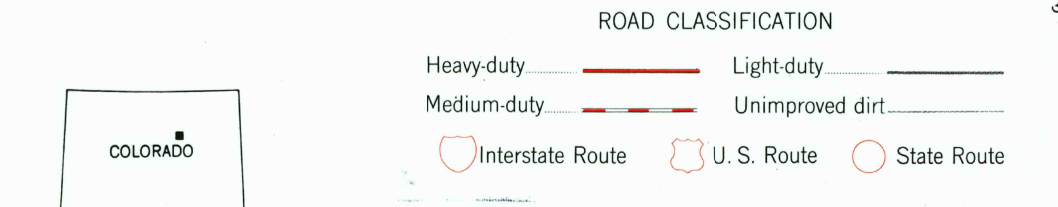
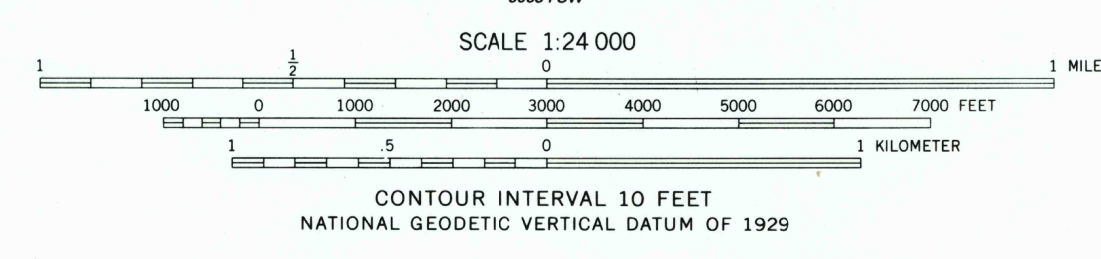
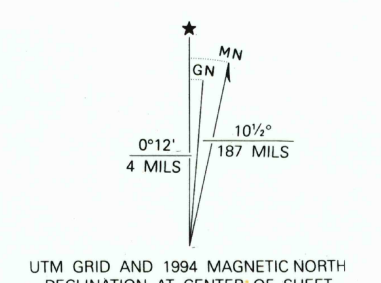

COLORADO
QUADRANGLE LOCATION

USGS AND USGS/NOAA
OCT 25 1994
REC'D FILE COPY

MILE HIGH LAKES, CO
39104-H6-TF-024
1966
REVISED 1994
DMA 5063 I NW-SERIES V877

THIS MAP COMPLIES WITH NATIONAL MAP ACCURACY STANDARDS
FOR SALE BY U. S. GEOLOGICAL SURVEY, DENVER, COLORADO 80225, OR RESTON, VIRGINIA 22092
A FOLDER DESCRIBING TOPOGRAPHIC MAPS AND SYMBOLS IS AVAILABLE ON REQUEST