

UNITED STATES
DEPARTMENT OF THE INTERIOR
GEOLOGICAL SURVEY

PROSPECT VALLEY QUADRANGLE
COLORADO
7.5 MINUTE SERIES (TOPOGRAPHIC)

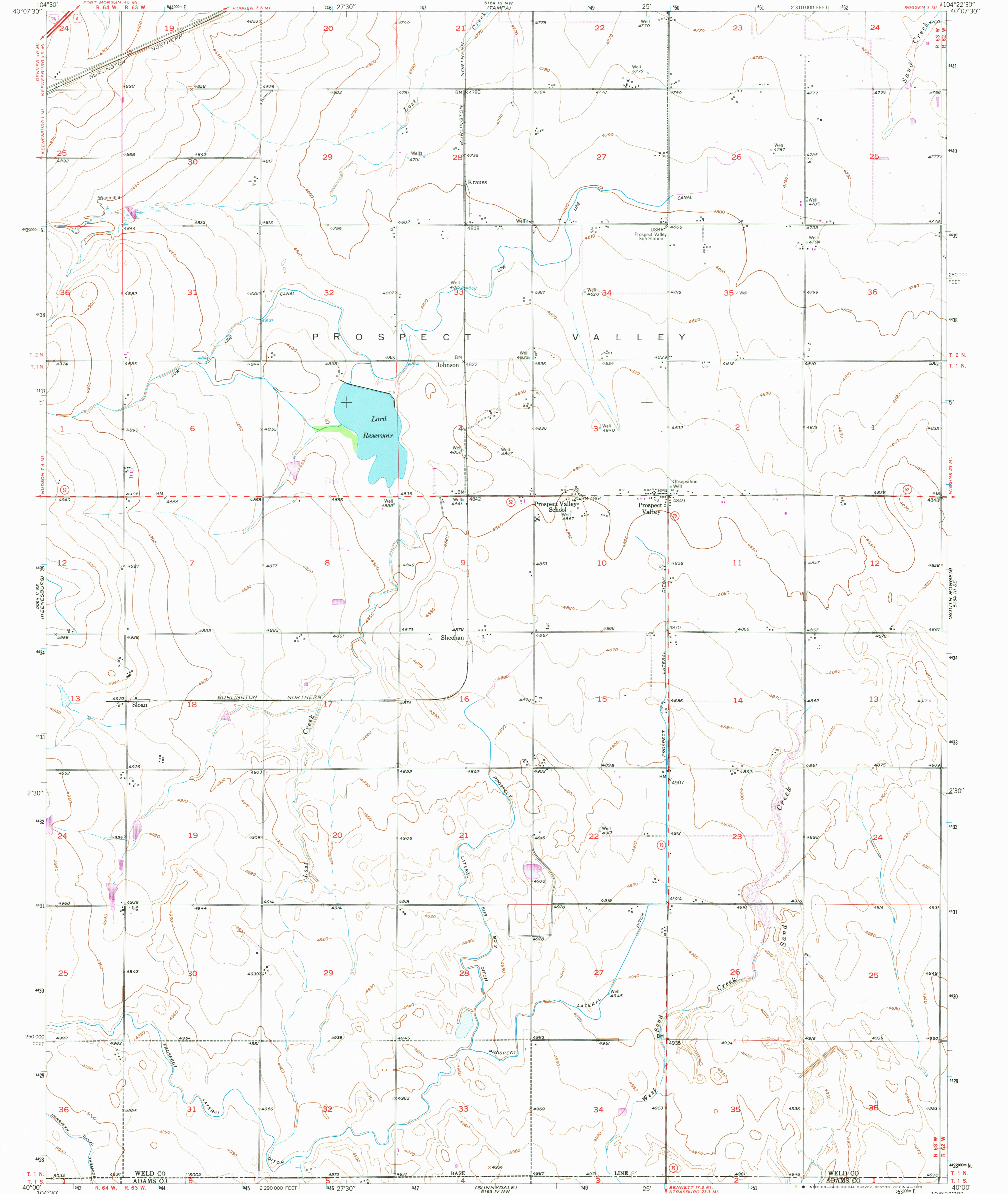

Mapped, edited, and published by the Geological Survey as part of the Department of the Interior program for the development of the Missouri River Basin Control by USGS and NOS/NOAA. Culture and drainage in part compiled from aerial photographs taken 1948 and 1949. Topography by planimeter surveys 1950. Limited revision 1971. Polyconic projection. 1927 North American datum. 10,000-foot grid based on Colorado coordinate system, north zone 1000-meter Universal Transverse Mercator grid ticks, zone 13, shown in blue. Revisions shown in purple compiled from aerial photographs taken 1975 and other source data. This information not field checked. Map edited 1978.

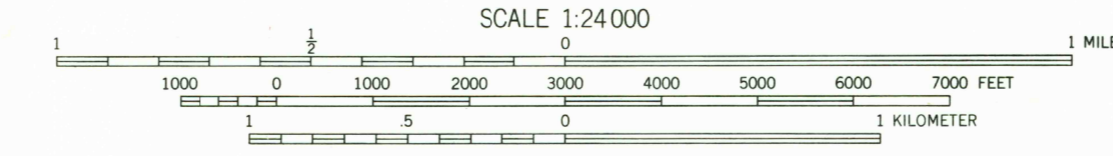
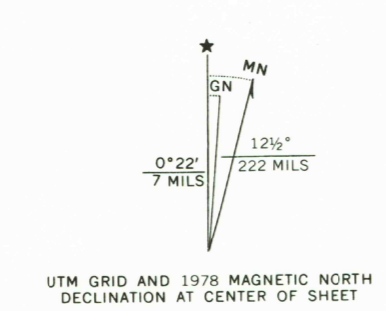

SCALE 1:24 000
CONTOUR INTERVAL 10 FEET
NATIONAL GEODETIC VERTICAL DATUM OF 1929

THIS MAP COMPLIES WITH NATIONAL MAP ACCURACY STANDARDS FOR SALE BY U. S. GEOLOGICAL SURVEY, DENVER, COLORADO 80225, OR RESTON, VIRGINIA 22092. A FOLDER DESCRIBING TOPOGRAPHIC MAPS AND SYMBOLS IS AVAILABLE ON REQUEST.



ROAD CLASSIFICATION
Primary highway, hard surface: Light-duty road, hard or improved surface
Secondary highway, hard surface: Unimproved road
Interstate Route: U. S. Route: State Route

PROSPECT VALLEY, COLO.
N4000-W10422.5/7.5

1950
PHOTOREVISED 1978
DMA 5164 III SW-SERIES V877

NOV 12 1981

2275