

UNITED STATES
DEPARTMENT OF THE INTERIOR
GEOLOGICAL SURVEY

PROSPECT VALLEY QUADRANGLE
COLORADO
7.5 MINUTE SERIES (TOPOGRAPHIC)

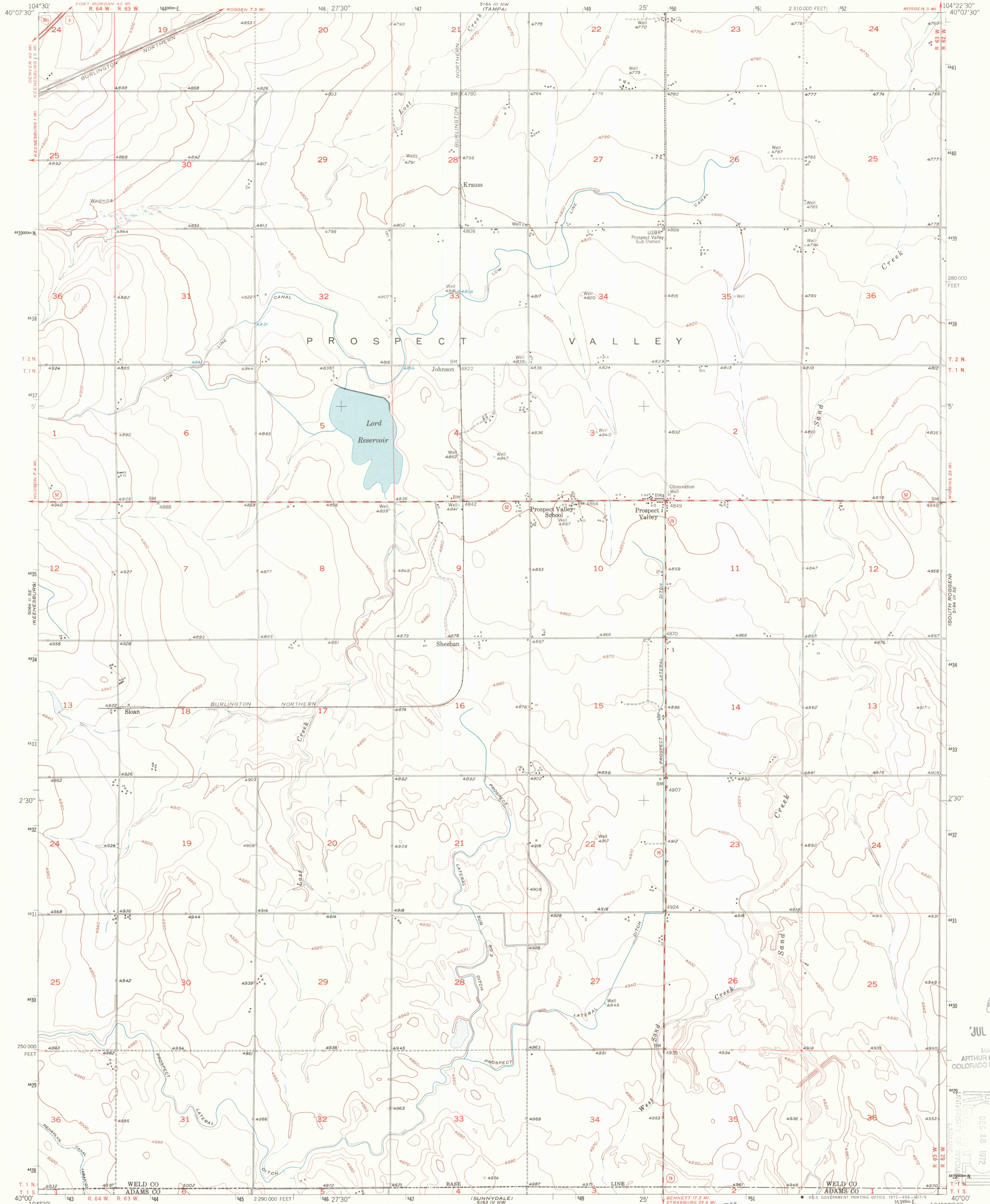

Mapped, edited, and published by the Geological Survey as part of the Department of the Interior program for the development of the Missouri River Basin Control by USGS and USC&GS
Culture and drainage in part compiled from aerial photographs taken 1948 and 1949. Topography by planetable surveys 1950 Limited revision 1971.
Polyconic projection. 1927 North American datum. 10,000-foot grid based on Colorado coordinate system, north zone 1000-meter Universal Transverse Mercator grid ticks, zone 13, shown in blue.

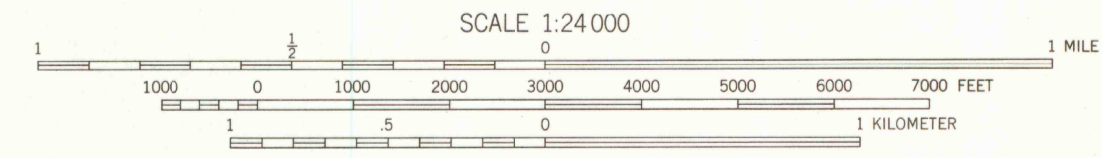
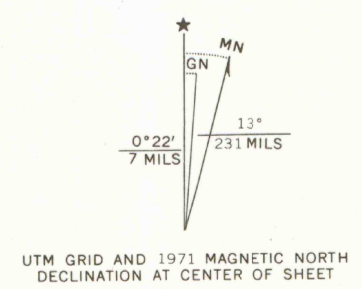

SCALE 1:24,000
CONTOUR INTERVAL 10 FEET
DATUM IS MEAN SEA LEVEL

OFFICE COPY
LIBRARY USE ONLY

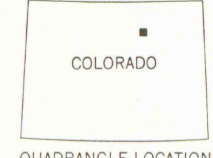

ROAD CLASSIFICATION

Primary highway, hard surface	Light-duty road, hard or improved surface
Secondary highway, hard surface	Unimproved road
Interstate Route	U. S. Route
	State Route

PROSPECT VALLEY, COLO.
N4000-W10422.5/7.5

THIS MAP COMPLIES WITH NATIONAL MAP ACCURACY STANDARDS
FOR SALE BY U.S. GEOLOGICAL SURVEY, DENVER, COLORADO 80225 OR WASHINGTON, D. C. 20242
A FOLDER DESCRIBING TOPOGRAPHIC MAPS AND SYMBOLS IS AVAILABLE ON REQUEST

1950
LIMITED REVISION 1971
AMS 5164 III SW-SERIES V877

JUL 06 2000
MAP FROM
ARTHUR LAKES LIBRARY
COLORADO SCHOOL OF MINES
LIBRARY
DOCUMENT COLLECTION
DEC 18 1972
UNIVERSITY OF WYOMING
LAPARER

G37 00
\$24
64

G37005
w/b