

UNITED STATES  
DEPARTMENT OF THE INTERIOR  
GEOLOGICAL SURVEY

SEVENMILE PLAZA QUADRANGLE  
COLORADO  
7.5 MINUTE SERIES (TOPOGRAPHIC)

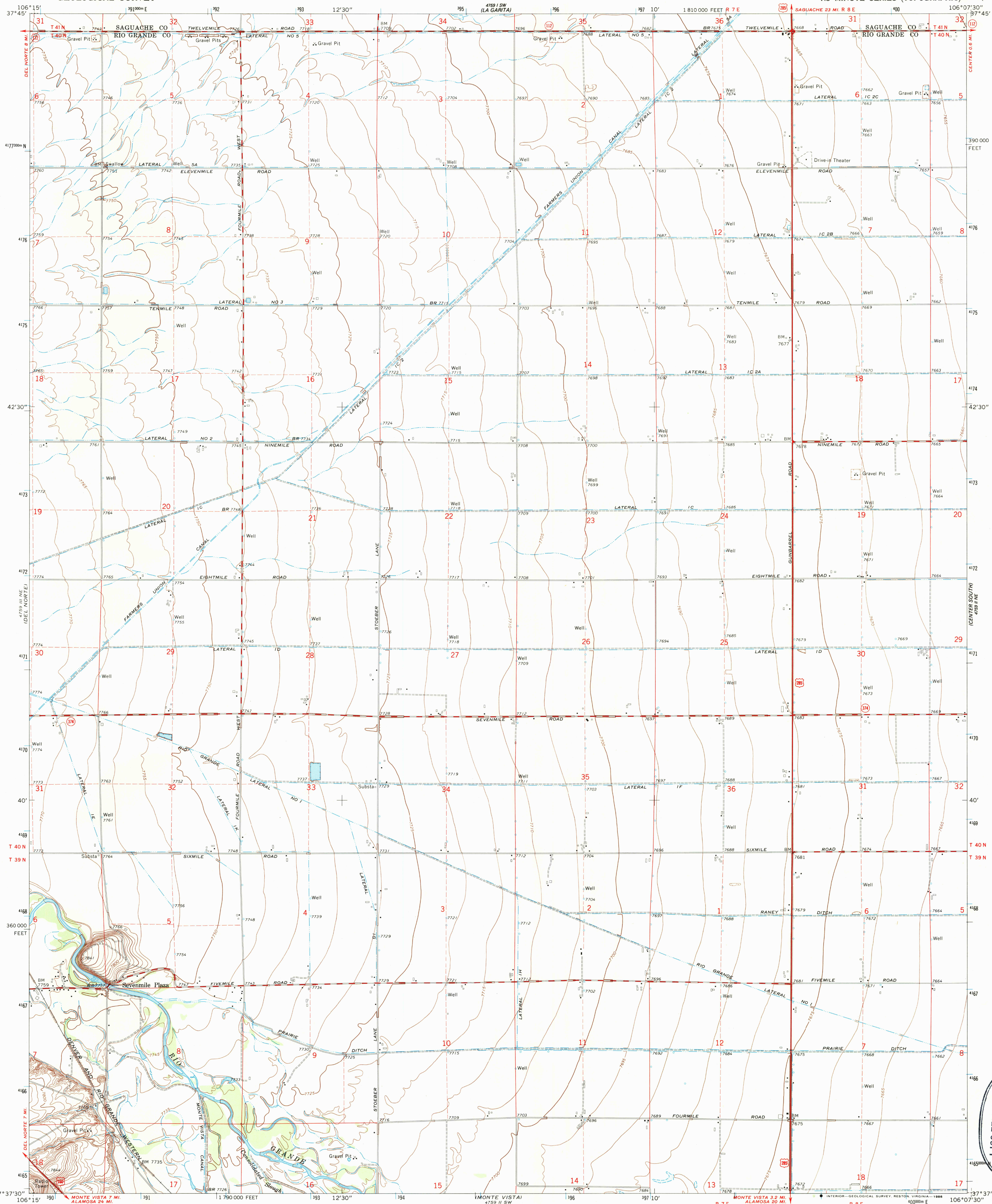

Mapped, edited, and published by the Geological Survey in cooperation with State of Colorado agencies  
Control by USGS, USC&GS, and U. S. Forest Service  
Planimetry by photogrammetric methods from aerial photographs taken 1960. Topography by planetable surveys 1964  
Polyconic projection. 1927 North American Datum  
10,000-foot grid based on Colorado coordinate system, south zone  
1000-meter Universal Transverse Mercator grid ticks, zone 13, shown in blue  
Fine red dashed lines indicate selected fence lines  
To place on the predicted North American Datum 1983 move the projection lines 3 meters north and 51 meters east as shown by dashed corner ticks

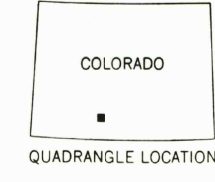
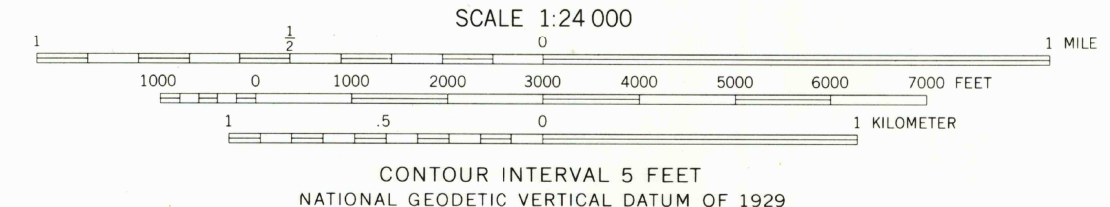
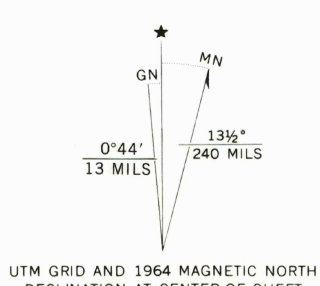

ROAD CLASSIFICATION  
Heavy-duty ——— Light-duty ———  
Medium-duty ——— Unimproved dirt ———  
U. S. Route ——— State Route ———

SEVENMILE PLAZA, COLO.  
37106-F2-TF-024

1964  
DMA 4759 II NW-SERIES 9877

THIS MAP COMPLIES WITH NATIONAL MAP ACCURACY STANDARDS  
FOR SALE BY U. S. GEOLOGICAL SURVEY, DENVER, COLORADO 80225, OR RESTON, VIRGINIA 22092  
A FOLDER DESCRIBING TOPOGRAPHIC MAPS AND SYMBOLS IS AVAILABLE ON REQUEST

