

UNITED STATES
DEPARTMENT OF THE INTERIOR
GEOLOGICAL SURVEY

SOUTH LADDER CREEK QUADRANGLE
COLORADO-CHEYENNE CO.
7.5 MINUTE SERIES (TOPOGRAPHIC)
(FORMERLY CHEYENNE WELLS 3 NW)

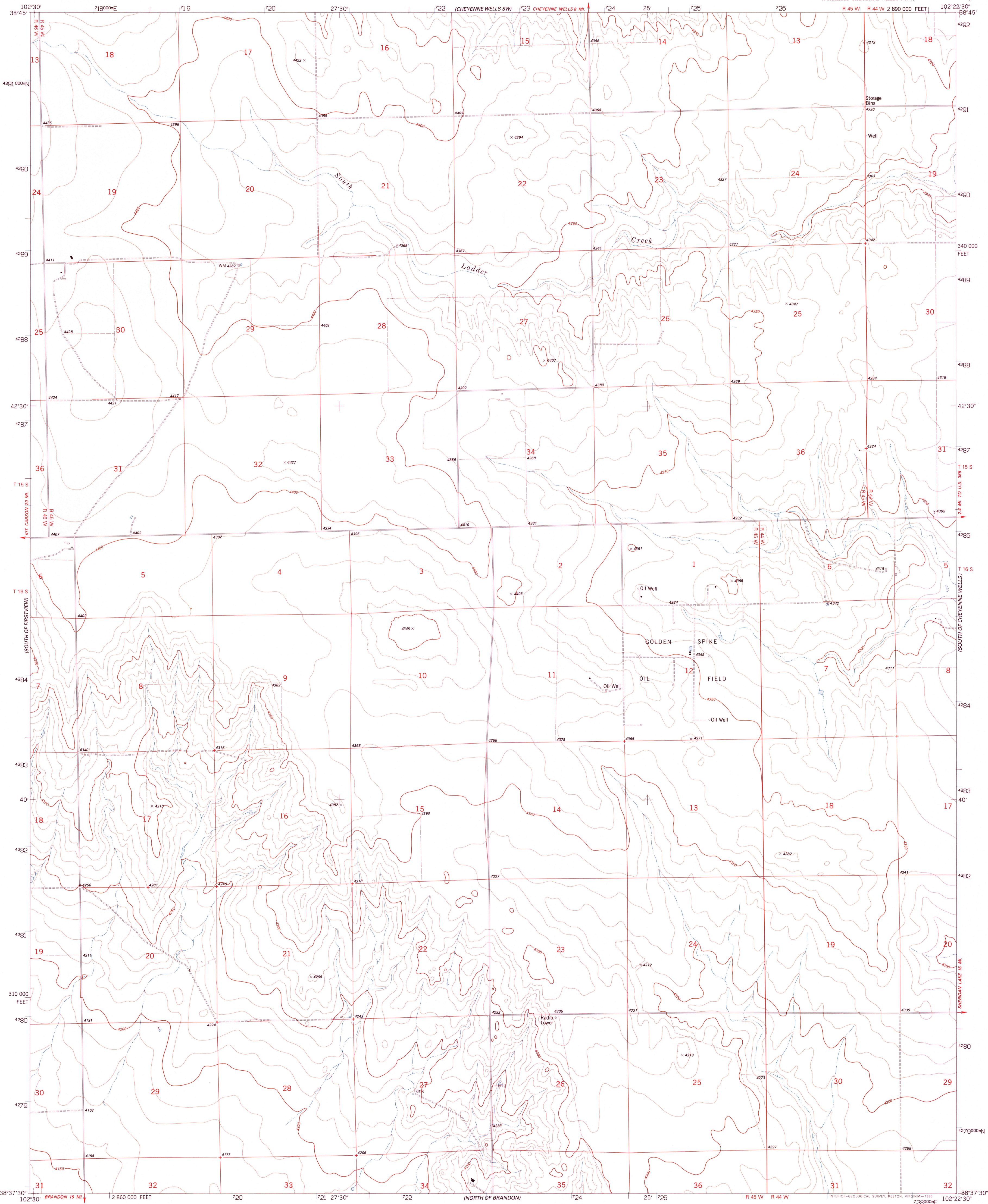

Produced by the United States Geological Survey
Control by USGS and NOS/NOAA
Compiled from aerial photographs taken 1975. Field checked 1976
Map edited 1982
North American Datum of 1927 (NAD 27). Projection and
10 000-foot ticks: Colorado Coordinate System, central zone
(Lambert Conformal Conic)
Blue 1 000-meter Universal Transverse Mercator ticks, zone 13
North American Datum of 1983 (NAD 83) is shown by dashed
corner ticks. The values of the shift between NAD 27 and NAD 83
for 7.5-minute intersections are obtainable from National Geodetic
Survey NADCON software
Fine red dashed lines indicate selected fence lines

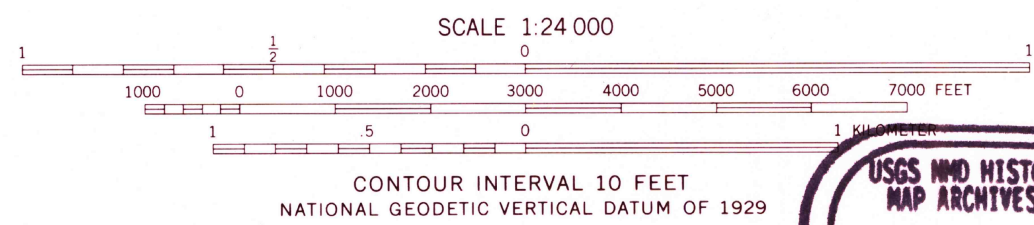
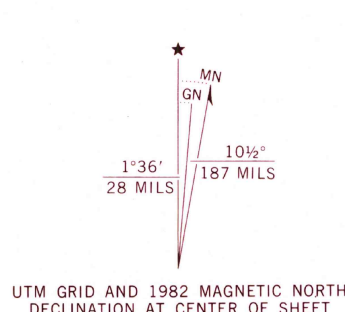

THIS MAP COMPLIES WITH NATIONAL MAP ACCURACY STANDARDS
FOR SALE BY U. S. GEOLOGICAL SURVEY, DENVER, COLORADO 80225, OR RESTON, VIRGINIA 22092
A FOLDER DESCRIBING TOPOGRAPHIC MAPS AND SYMBOLS IS AVAILABLE ON REQUEST

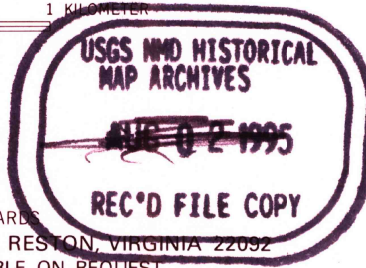

ROAD CLASSIFICATION
Primary highway, hard surface
Secondary highway, hard surface
Unimproved road
Interstate Route
U. S. Route
State Route
Light-duty road, hard or improved surface

SOUTH LADDER CREEK, CO
(FORMERLY CHEYENNE WELLS 3 NW)
38102-F4-TF-024

1982

DMA 5561 III NW-SERIES V877

28 JUL 1995

